



Grace Close | London, SE9 4JE



Guide Price £325,000 - £350,000

Freehold

EPC = E

ROBINSON-JACKSON
Our service will *move* you

Grace Close, London

A well presented two double bedroom end of terrace home which is deceptively spacious. Convenient for local bus routes, amenities and access into Grove Park mainline station.

Property Features

- 19ft Lounge/Diner
- 13ft Fitted Kitchen
- Lean To
- First Floor Shower Room
- Two Double Bedrooms
- Convenient Location



Interior

Entrance Porch: Double glazed entrance door and two large storage cupboards.

Entrance Hall: Wood style laminate flooring.

Kitchen: 4.17m x 1.93m (13'8" x 6'4") Fitted with a range of modern wall and base units with complimentary work surfaces. One bowl stainless steel sink unit with separate taps and tiled splash back. Space for appliances. Plumbed for washing machine. Wood laminate flooring.

Lounge/Diner: 5.92m x 3.86m (19'5" x 12'8") Storage cupboard, wood style laminate flooring, sash windows and door to lean-to.

Lean-to: 3.78m x 1.55m (12'5" x 5'1") Door leading to Rear Garden.

Landing: Access to loft, three large storage cupboards, carpet as fitted and sash window to side.

Bedroom 1: 3.86m (12'8") into wardrobes x 3.02m (9'11") Built in wardrobes, large storage cupboard and carpet as fitted.

Bedroom 2: 3.86m x 3.18m (12'8" x 10'5") Large storage cupboard, sash windows to rear and carpet as fitted.

Shower Room: Fitted with a three piece suite comprising of a pedestal wash hand basin, low level WC and walk in shower cubicle. Chrome heated towel rail, part tiled walls and tiled flooring.

Ground Floor

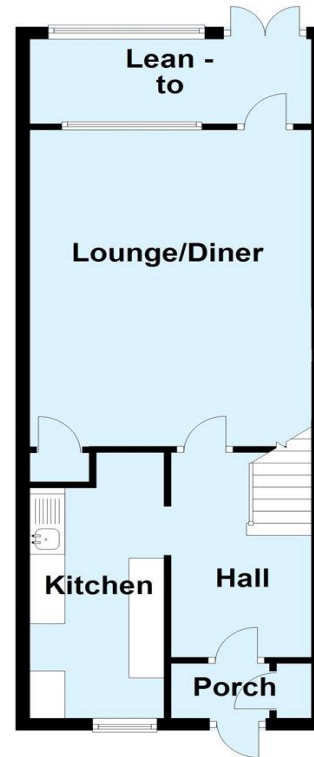

First Floor

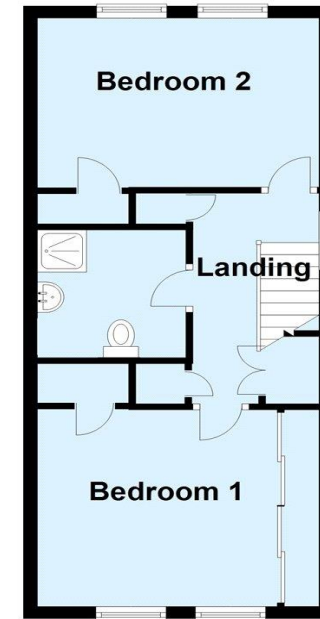



Exterior

Rear Garden: Mainly laid to lawn with paved patio area and raised shed to rear.

Front Garden: Paved.

Property Location

Grace Close, London, SE9 4JE

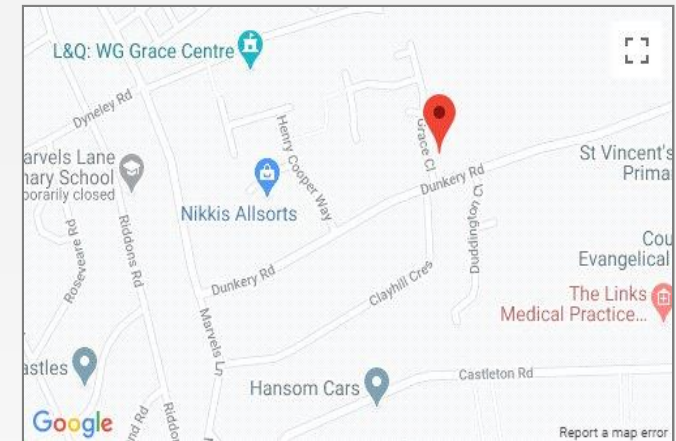

**FOR MORE INFORMATION
CONTACT US TODAY.**

020 8859 9600
Robinson Jackson
2-4 Court Yard,
Eltham,
London SE9 5PZ
eltham@robinson-jackson.com

