



Sunnybank | Murston, Sittingbourne, ME10 3QN



Offers in excess of £200,000 Freehold

ROBINSON MICHAEL & JACKSON
Our service will *move* you

Sunnybank, Murston

Conveniently nestled in the heart of Murston, this two-bedroom property offers comfortable and convenient living.

Property Features

- Council Tax: B
- EPC Rating: C
- Two bedroom cluster house
- No chain
- Freehold
- Off street parking
- Unattached garden
- Cul-de-sac location



Interior

Lounge/Diner: 5.5m x 4.3m (18'1" x 14'1")

Kitchen: 3m x 1.7m (9'10" x 5'7")

Bedroom 1: 3.4m x 2.6m (11'2" x 8'6")

Bedroom 2: 2m x 1.7m (6'7" x 5'7")

Bathroom: 2m x 1.7m (6'7" x 5'7")

Exterior

Unattached enclosed garden

Off road parking

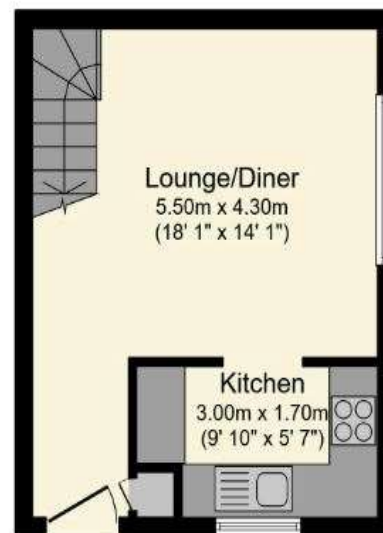

Ground Floor

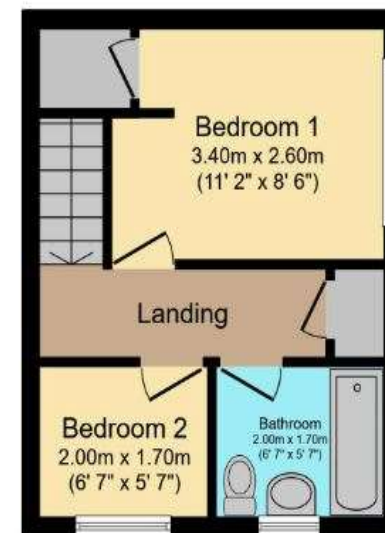

First Floor

Total floor area 47.3 sq.m. (509 sq.ft.) approx.

This floor plan is for illustrative purposes only. It is not drawn to scale. Any measurements, floor areas (including any total floor area), openings and orientation are approximate. No details are guaranteed, they cannot be relied upon for any purpose and they do not form part of any agreement. No liability is taken for any error, omission or misstatement. A party must rely upon its own inspection(s). Plan produced for Purplebricks. Powered by www.focalagent.com





Property Location

Sunnybank, Murston, Sittingbourne, ME10 3QN

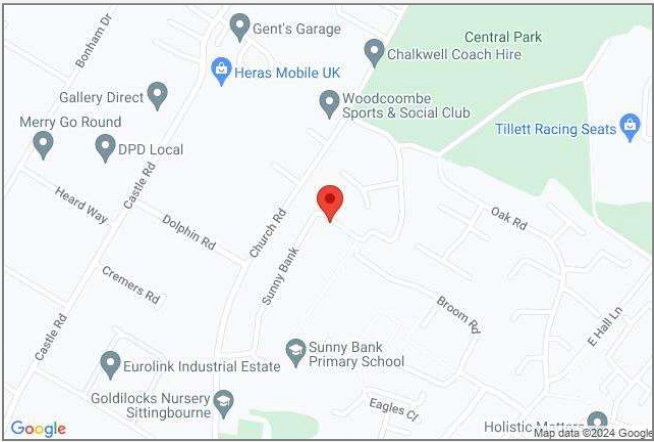

*All distances from branch postcode. Train time from nearest station.

FOR MORE INFORMATION CONTACT US TODAY.

01795 479999
Robinson Michael & Jackson
38 West Street,
Sittingbourne,
Kent, ME10 1AP
sittingbourne@robinson-jackson.com



These particulars do not form part of an offer or contract and must not be relied upon as statements or representation of fact. Any areas, measurements, journey times or distances are approximate. The text, images, photographs and plans are for guidance only and are not necessarily comprehensive. It should not be assumed that the property has all necessary planning, building regulation or other consents and we have not tested any services, equipment or facilities. References to tenure are based on information supplied by the seller. Buyer should verify all information themselves by inspection or otherwise prior to a legal commitment to purchase. Photos and images are subject to copyright.