



Springfield Road | Sydenham, London, SE26 6HG



OIEO £500,000

Freehold

EPC = D

ROBINSON-JACKSON
Our service will *move* you

Springfield Road, Sydenham

Wonderful private built family home set on the exclusive Lawrie Park Triangle, in an enviable position overlooking Sydenham Tennis Club, benefits include garage, superb kitchen with integrated appliances and 17'4 lounge/dining room, ideal for Sydenham station and Crystal Palace Park

Property Features

- Three bedrooms
- Ample storage
- Roof insulation
- Pleasant gardens
- Ideal for Sydenham station
- Excellently located for Sydenham High Street and Crystal Palace Park



Interior

Entrance Hall Built in cupboard, carpet, radiator

Lounge/Dining Room Double glazed patio doors to garden, under stairs storage, carpet, two radiators

Kitchen Double glazed wide aspect window to front, range of wall and base units, laminate work surface, stainless steel sink unit and drainer, cooker to remain, extractor, integrated fridge/freezer, washing machine and dishwasher, laminate flooring, radiator, pelmet lighting

First Floor Landing Double glazed window to rear, airing cupboard, carpet

Master Bedroom Double glazed wide window aspect to front, built in wardrobe, carpet

Bedroom Two Double glazed window to rear, carpet, radiator

Bedroom Three Double glazed window to rear, stripped wooden floorboards, radiator

Shower Room Walk in shower cubicle, wash hand basin, low flush wc, tiled floor, radiator, spotlights, extractor fan

Exterior

Garage en-bloc

Pleasant front and rear gardens, the latter has a patio with shrub borders

Additional Information

Double glazing

Central heating

Integrated appliances

Ample storage

Roof insulation

Modern private built family home

Exclusive Lawrie Park Triangle

Sought after location

Ideal for Sydenham station

Well located for Crystal Palace Park

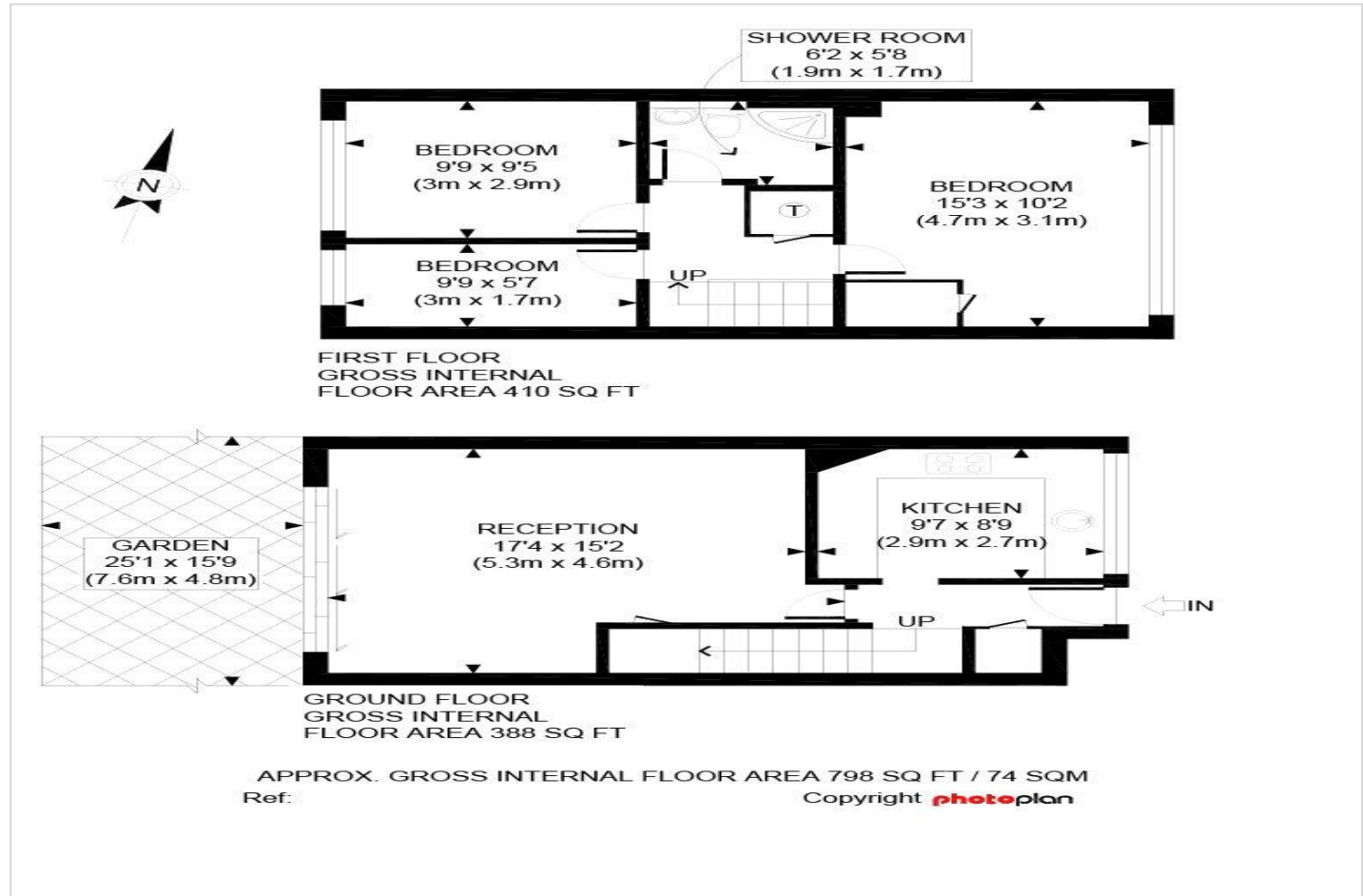



Property Location

Springfield Road, Sydenham, London, SE26 6HG

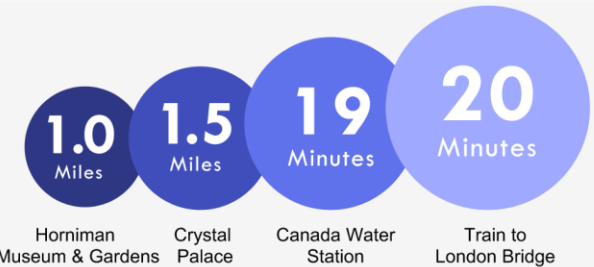
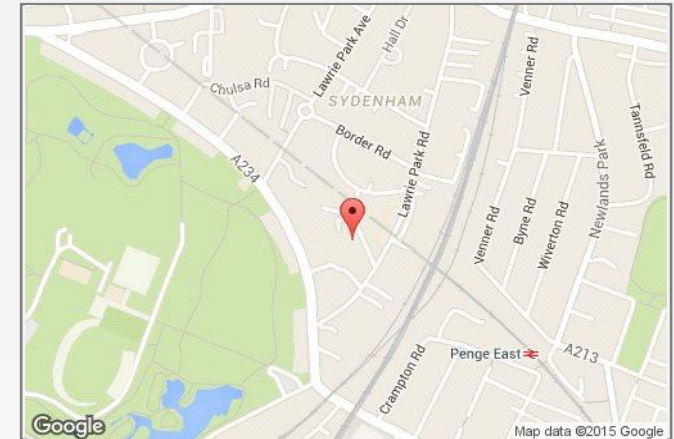

*All distances from branch postcode. Train time from nearest station.

Owner's Comments

"This has been our family home for many decades, we have many happy memories here and we will miss the house immensely. The neighbours are wonderful, everyone looks out for each other and there is a brilliant community spirit. The house is very light with large wide windows and we have a beautiful outlook, with leafy views over the tennis courts. We have recently upgraded the kitchen and bathroom. We have also had a new roof with a 20 year guarantee. We are in a prime position for local shops, parks and transport links, with Sydenham station nearby, giving easy access to central London."

These particulars do not form part of an offer or contract and must not be relied upon as statements or representation of fact. Any areas, measurements, journey times or distances are approximate. The text, images, photographs and plans are for guidance only and are not necessarily comprehensive. It should not be assumed that the property has all necessary planning, building regulation or other consents and we have not tested any services, equipment or facilities. References to tenure are based on information supplied by the seller. Buyer should verify all information themselves by inspection or otherwise prior to a legal commitment to purchase. Photos and images are subject to copyright.

**FOR MORE INFORMATION
CONTACT US TODAY.**

020 8776 6660

Robinson Jackson
256 Kirkdale,
Sydenham,
London SE26 4NL

sydenham@robinson-jackson.com

