



Parrock Street | Gravesend, Kent, DA12 1EZ



Price on Application

Leasehold

EPC = TBC

ROBINSON MICHAEL & JACKSON
Our service will *move* you

Parrock Street, Gravesend

This brand new two bedroom top floor flat is situated in Gravesend Town Centre within walking distance of BR Station and has been finished to a high spec throughout. Call today to book a viewing.

Property Features

- Double Glazing
- Gas Central Heating
- Security Entry phone
- Open Plan Living
- Ready for Occupation
- Walk to Town



Interior

Entrance Hall: Laminate wood flooring. Radiator. Security entry phone. Cupboard housing gas fired central heating boiler.

Lounge: 6.55m x 2.87m (21'6" x 9'5") Double glazed window to front. Laminate wood flooring. Radiator. Inset spot lights. Arch to kitchen.

Kitchen: 2.87m x 2.08m (9'5" x 6'10") Ceiling skylight window. Newly fitted wall and base units with roll top work surface over. Built-in oven and hob with extractor hood over. Sink and drainer sink unit. Inset spot lights.

Bedroom 1: 4.37m x 2.84m (14'4" x 9'4") Double glazed window to front. Carpet. Radiator. Built-in wardrobe cupboard.

Bedroom 2: 3.02m x 2.87m (9'11" x 9'5") Double glazed ceiling skylight window. Built-in wardrobe cupboard.

Bathroom: 2.74 (9')m x 2.1 (6'11")m (Widening to 3.02 (9'11")m) Ceiling double glazed skylight window. Newly installed white suite comprising panelled bath. Separate tiled shower cubicle. Pedestal wash hand basin. Low level w.c. Heated towel rail.

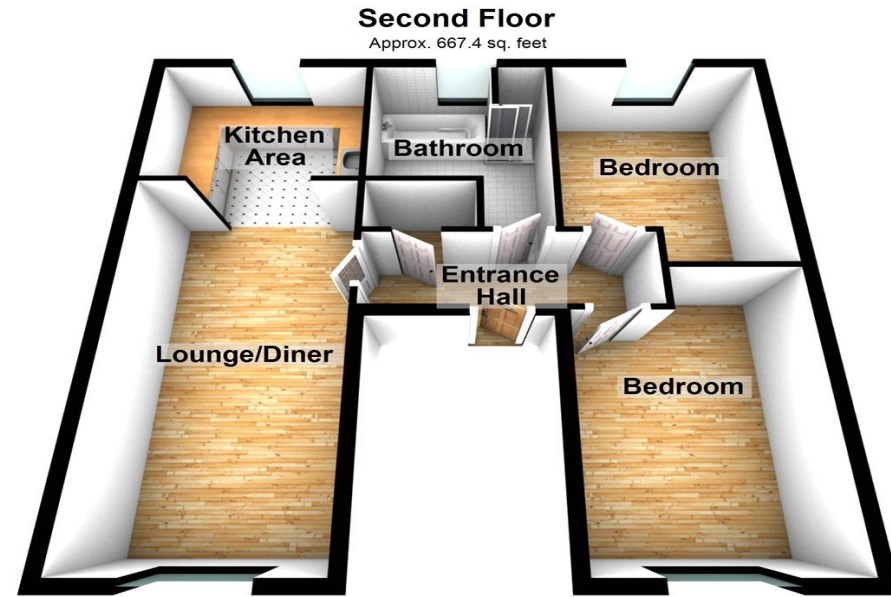

Please be advised this plan is offered for marketing purposes only. It can not be relied upon for exact or precise measurements, angles, window or door openings. Whilst every effort is made to ensure the accuracy the company or provider accepts no responsibility for the content.
Plan produced using PlanUp.

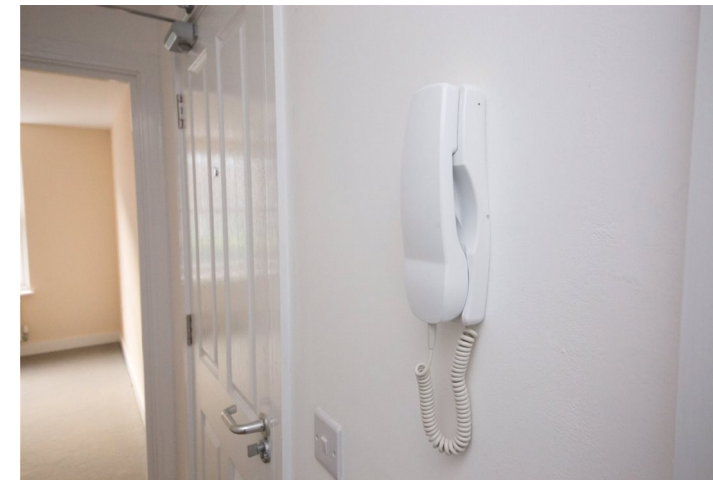



Property Location

Parrock Street, Gravesend, Kent, DA12 1EZ

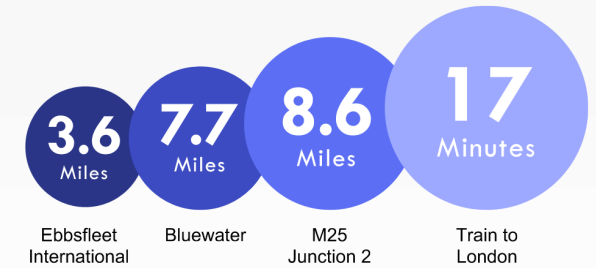
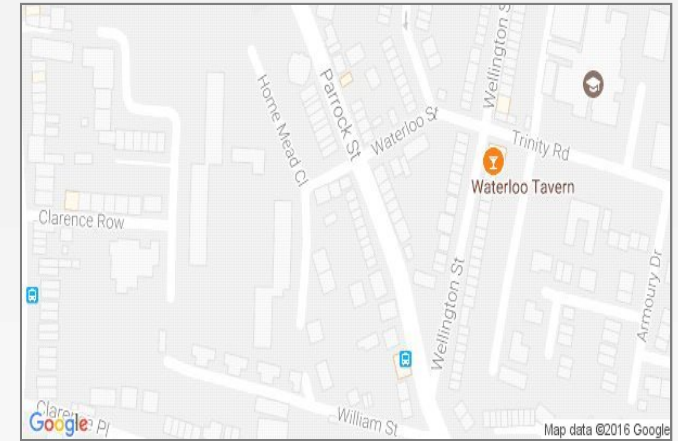

*All distances from branch postcode. Train time from nearest station.

PLEASE NOTE THAT THE PHOTOGRAPHS SHOWN HAVE BEEN TAKEN FROM THE SHOW FLAT.

**FOR MORE INFORMATION
CONTACT US TODAY.**

01474 333111

Robinson Michael & Jackson
21 King Street,
Gravesend,
Kent DA12 2EB

gravesend@robinson-jackson.com



These particulars do not form part of an offer or contract and must not be relied upon as statements or representation of fact. Any areas, measurements, journey times or distances are approximate. The text, images, photographs and plans are for guidance only and are not necessarily comprehensive. It should not be assumed that the property has all necessary planning, building regulation or other consents and we have not tested any services, equipment or facilities. References to tenure are based on information supplied by the seller. Buyer should verify all information themselves by inspection or otherwise prior to a legal commitment to purchase. Photos and images are subject to copyright.