



# Lords Wood Lane

Chatham | Kent | ME5 8JT



# Lords Wood Lane

Chatham, Kent, ME5 8JT

£425,000

Freehold

Offered to the market with NO CHAIN, this large Three bedroom bungalow sits on a generous plot and is in excess of 1170 sq ft internally.

## Benefitting from:

- Three bedroom detached bungalow
- Large rear garden
- No chain
- Sought after location
- Recently fitted bathroom suite
- Potential to improve
- Council Tax: D
- EPC Rating: C



## Accommodation

### Entrance Porch

**Lounge** 5.4m x 4.4m (17'9" x 14'5")

**Kitchen** 4.1m x 2.82m (13'5" x 9'3")

**Dining Room** 5.74m x 2.95m (18'10" x 9'8")

**Bedroom One** 6.25m x 3.5m (20'6" x 11'6")

**Ensuite W/C** 2.08m x 1.17m (6'10" x 3'10")

**Bedroom Two** 5.54m x 5.18m (18'2" x 17')

**Bedroom Three** 5.33m x 3.38m (17'6" x 11'1")

**Bathroom** 4.67m x 3.33m (15'4" x 10'11")

## Exterior

Large enclosed rear garden

Off road parking to front



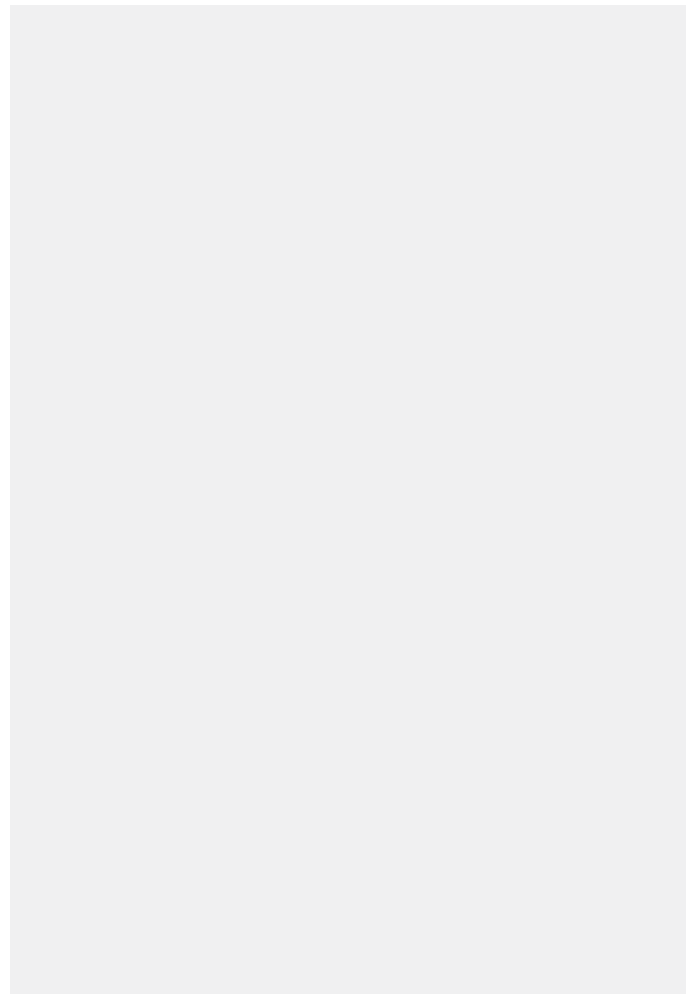



## Important Notice

These particulars do not form part of an offer or contract and must not be relied upon as statements or representation of fact. Any areas, measurements, journey times or distances are approximate. The text, images, photographs and plans are for guidance only and are not necessarily comprehensive. It should not be assumed that the property has all necessary planning, building regulation or other consents and we have not tested any services, equipment or facilities. References to tenure are based on information supplied by the seller. Buyer should verify all information themselves by inspection or otherwise prior to a legal commitment to purchase. Photos and images are subject to copyright.

## Location



(All distances & times are approximates)

## FOR MORE INFORMATION CONTACT US TODAY.

Kendell Laretive - Assistant Manager

01634 868000

Robinson Michael & Jackson  
381 Walderslade Road,  
Walderslade,  
Kent ME5 9LL

walderslade@robinson-jackson.com

SALES | MORTGAGES | LEGALS

ROBINSON MICHAEL & JACKSON

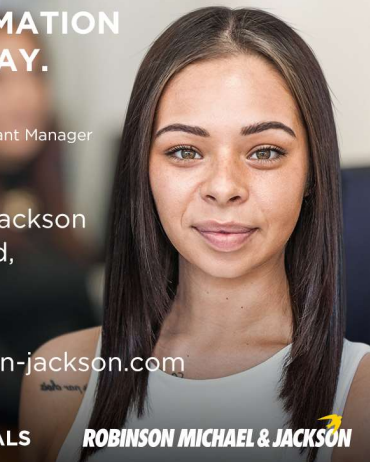

## Ground Floor

Approx. 1170.0 sq. feet

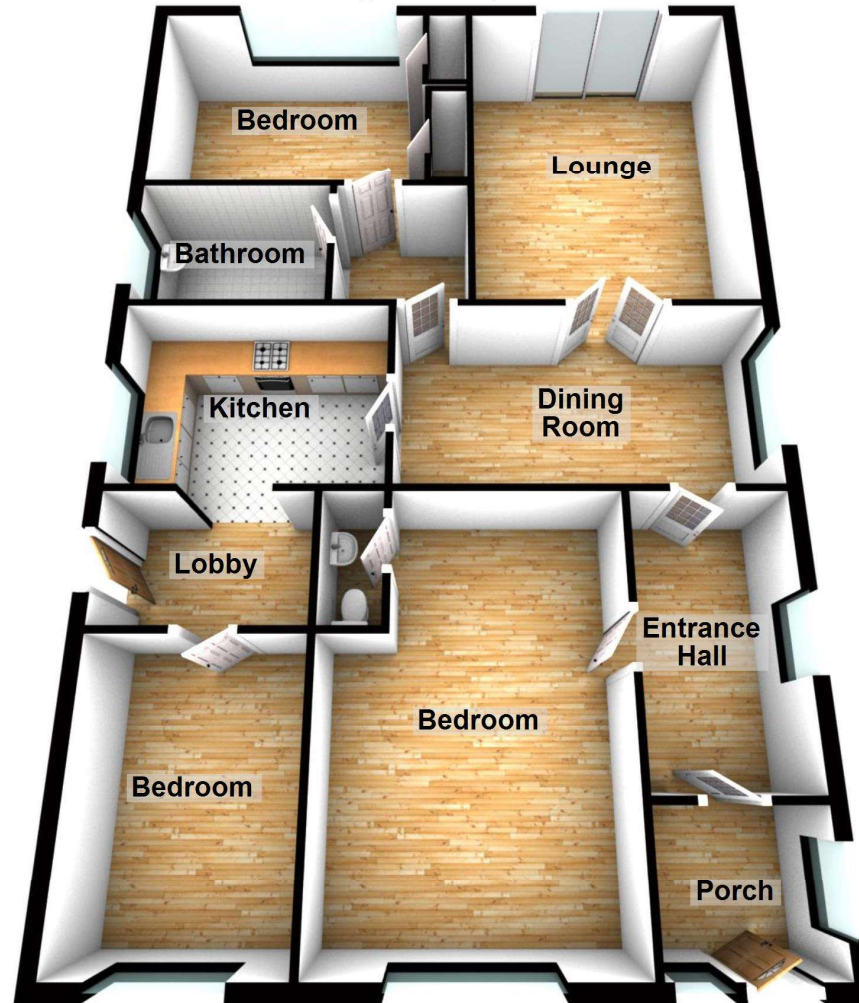

Total area: approx. 1170.0 sq. feet

Please be advised this plan is offered for marketing purposes only. It can not be relied upon for exact or precise measurements, angles, window or door openings. Whilst every effort is made to ensure the accuracy the company or provider accepts no responsibility for the content.  
Plan produced using PlanUp.

