



Maritime Gate | Northfleet, Kent, DA11 9EG



Offers in excess of £375,000 Freehold

ROBINSON MICHAEL & JACKSON

Our service will *move* you

Maritime Gate, Northfleet

This modern built immaculate three-bedroom semi-detached property is on the popular Maritime Gate development. The property benefits from having good transport links and allocated parking for 2 cars.

Property Features

- Council Tax: D
- EPC Rating: C
- Ground Floor Cloakroom
- Lounge
- Kitchen/Diner
- Conservatory
- First Floor Bathroom
- Maintenance Free Garden
- Two Allocated Parking Spaces



Interior

Entrance Hall: 1.85m x 1.1m (6'1" x 3'7") Entrance door. Laminate wood flooring. Radiator. Door to reception room 1. Door to ground floor cloakroom.

GF Cloakroom: 1.78m x 0.9m (5'10" x 2'11") Frosted double glazed window to front. Low level w.c. Vanity wash hand basin. Radiator. Coved ceiling.

Lounge: 4.57m x 4.06m (15' x 13'4") Double glazed window to front with shutters. Laminate wood flooring. Double radiator. Under-stairs cupboard. Carpeted staircase to first floor.

Kitchen/Diner: 4.57m x 2.84m (15' x 9'4") Double glazed window to rear. Modern fitted wall and base units with roll top work surface over. Built-in oven and hob with extractor hood over. Tiled splash back. Double radiator. Vinyl flooring. 1 1/2 bowl sink and drainer unit with mixer tap. Space for appliances. Coved ceiling. Double glazed French doors leading to conservatory. Double glazed French doors leading to conservatory.

Conservatory: 3.96m x 2.92m (13' x 9'7") Double glazed fully opening double glazed doors to garden.

First Floor Landing: Double glazed window to side. Carpet. Built-in storage cupboard. Built-in airing cupboard. Coved ceiling. Access to loft. Doors to: -

Bedroom 1: 2.95 (9'8") m + Wardrobes x 2.57 (8'5") m Double glazed window to front with shutters. Laminate wood flooring. Radiator. Built-in wardrobes with sliding doors. Coved ceiling.

Bedroom 2: 3.23m x 2.34m (10'7" x 7'8") Double glazed window to rear with shutters. Radiator. Laminate wood flooring. Coved ceiling.

Bedroom 3: 2.13m x 2m (7' x 6'7") Double glazed window to rear. Laminate wood flooring. Radiator. Coved ceiling.

Bathroom: 1.9m x 1.73m (6'3" x 5'8") Frosted double glazed window to rear. Suite comprising modern suite comprising panelled bath with independent shower and screen over. Vanity wash hand basin with cupboard below. Low level w.c. Tiled walls. Tiled flooring. Inset spotlights. Extractor fan. Heated towel rail.

Exterior

Rear Garden: Approx. 22'9 x 16'0: Paved patio area. Laid to Astro turf with slate borders. Fenced to side and rear.

Parking: Two allocated parking spaces to front.

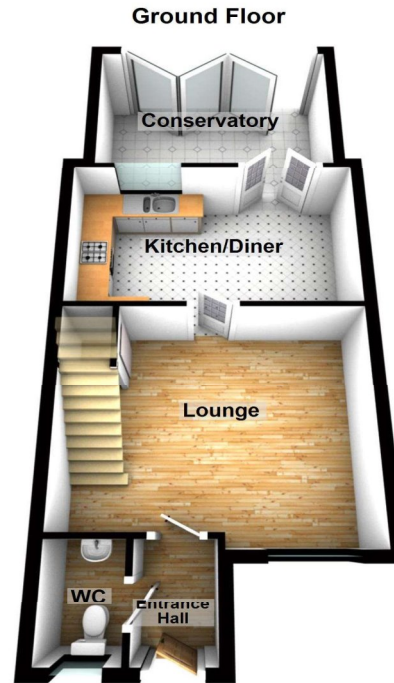

Total area: approx. 846.4 sq. feet

Please be advised this plan is offered for marketing purposes only. It can not be relied upon for exact or precise measurements, angles, window or door openings. Whilst every effort is made to ensure the accuracy the company or provider accepts no responsibility for the content.
Plan produced using PlanUp.





Property Location

Maritime Gate, Northfleet, Kent, DA11 9EG

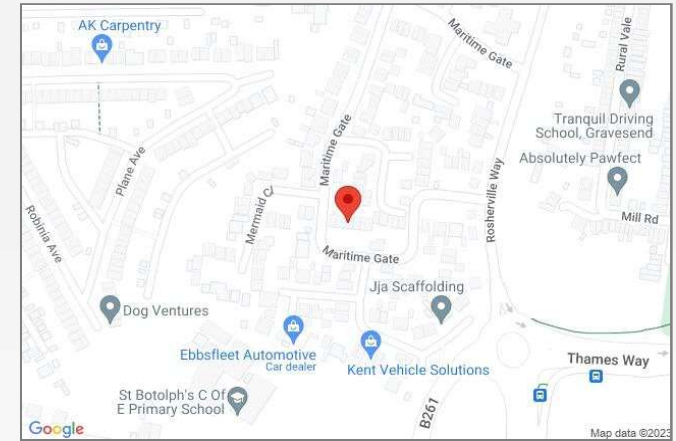

Additional Information

The popular Maritime Gate development combines stylish living with close proximity to rail links to the capital and excellent local amenities for modern lifestyles. High Speed One from Ebbsfleet International rail station offers services into London St. Pancras in just 19 minutes.

FOR MORE INFORMATION CONTACT US TODAY.

01474 333111
 Robison Michael & Jackson
 21 King Street,
 Gravesend,
 Kent DA12 2EB
gravesend@robinson-jackson.com