



Rectory Road | Swanscombe, Kent, DA10 0JT



Guide Price £450,000 to £475,000 Freehold

**ROBINSON-JACKSON**  
Our service will *move* you

# Rectory Road, Swanscombe

Robinson-Jackson are delighted to offer this CHAIN FREE semi-detached bungalow to the market on Rectory Road in Swanscombe.

On approach the home is nestled away on a private and quiet close of Rectory Road.

Comprising of 2-bedrooms (previously 3 bedrooms) this semi-detached home has been modernised throughout and is ready to move straight into.

The property consists of an entrance hallway, reception area, 2- bedrooms (with built-in wardrobes), shower area, kitchen and lean-to.

Externally you will find a large driveway with garage to the front. To the rear the garden is well established offering privacy and external workshop and storage.

This is truly a MUST SEE home and internal viewing is essential to fully appreciate everything this property has to offer. Please contact Robinson-Jackson today to book your viewing.

The property is located close to local amenities as well as the main Swanscombe Parade of Shops. The location is also ideal for commuters with the property being located a short drive from Ebbsfleet International Train Station. The property is also well placed for Bluewater Shopping Centre with a huge amount of shops and restaurants to choose from.

## Property Features

- Semi Detached Bungalow
- Generous Plot with Outbuildings
- Garage & Driveway
- Close To Ebbsfleet International Train Station
- Short Drive To Bluewater
- Well Presented Throughout



## Interior

**Bedroom 1** 4.04m x 3.68m (13'3" x 12'1")

**Bedroom 2** 3.05m x 3.02m (10' x 9'11")

**Kitchen** 3.68m x 3.23m (12'1" x 10'7")

**Lean Too** 3m x 2.41m (9'10" x 7'11")

**Reception Room** 6.93m x 4.24m (22'9" x 13'11")

## Exterior

Private driveway.

Rear Garden: L shape. Mainly laid to lawn. Established trees and shrubs.

## Rectory Road, DA10

Approximate Gross Internal Area 83.6 sq m / 901 sq ft

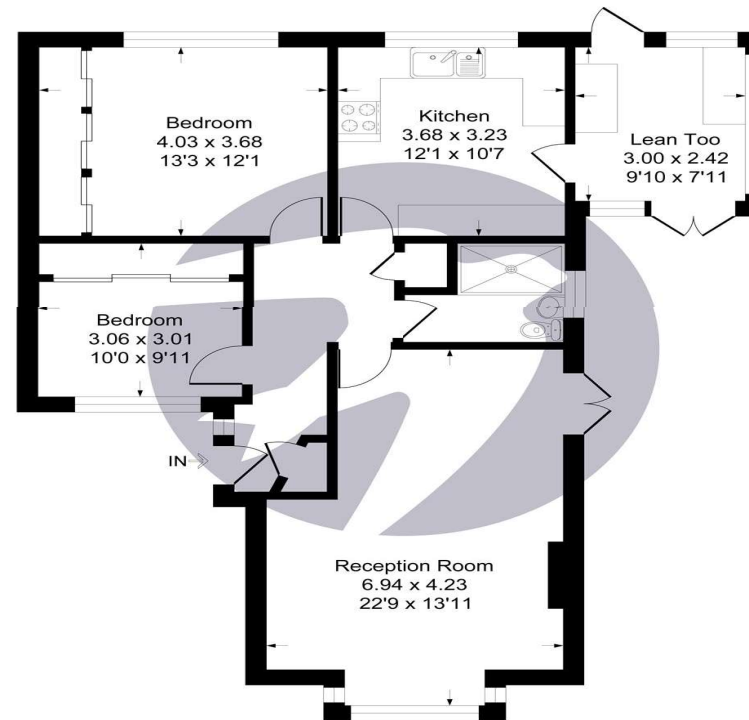



## Property Location

Rectory Road, Swanscombe, Kent, DA10 0JT

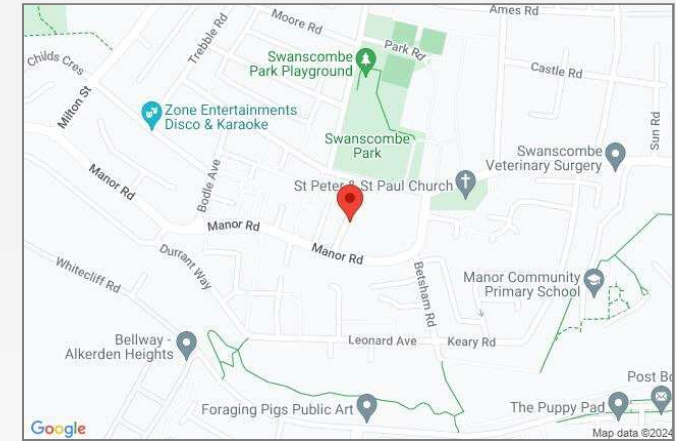

## Additional Information

Dartford Borough Council - Tax Band D

Total floor area: 73 sq. metres

FOR MORE INFORMATION  
CONTACT US TODAY.

01322 624440

Robinson Jackson  
39 High Street,  
Swanscombe  
Kent,  
DA10 0AG

swanscombe@robinson-jackson.com



These particulars do not form part of an offer or contract and must not be relied upon as statements or representation of fact. Any areas, measurements, journey times or distances are approximate. The text, images, photographs and plans are for guidance only and are not necessarily comprehensive. It should not be assumed that the property has all necessary planning, building regulation or other consents and we have not tested any services, equipment or facilities. References to tenure are based on information supplied by the seller. Buyer should verify all information themselves by inspection or otherwise prior to a legal commitment to purchase. Photos and images are subject to copyright.