



George Lane | Lewisham, London, SE13 6HW



Guide Price £575,000

Freehold

ROBINSON-JACKSON
Our service will *move* you

George Lane, Lewisham

Three bedroom 1950's built terrace house situated in a quiet residential street, within walking distance of Hither Green station, driveway parking, 80ft rear garden, fitted kitchen, large reception.

Property Features

- Double Glazed Windows
- Large Rear Garden
- Three Bedrooms
- White Bathroom Suite
- Great Location
- Total floor area 88m² = 947ft² (*guidance only)



Interior

ENTRANCE HALL Entrance door, laminated wood floor, stairs to first floor.

LOUNGE Double glazed window to rear and double glazed door to garden, laminated wood floor, radiator.

KITCHEN Double glazed window to front, range of wall and base units, integrated gas hob, oven and extractor fan, stainless steel sink unit with mixer tap, tiled splash back and tiled floor, plumbed for washing machine, storage.

BEDROOM 1 Two double glazed windows to front, fully fitted carpet, radiator.

BEDROOM 2 Double glazed window to rear, fully fitted carpet, radiator.

BEDROOM 3 Double glazed window to front, fully fitted carpet, radiator.

BATHROOM Double glazed window to rear, panel enclosed bath with shower attachment, wash hand basin, tiled walls and floor, extractor fan.

WC Double glazed window to rear, low level WC, wash hand basin, tiled walls and floor.

Exterior

GARDEN Patio area, laid to lawn.

DRIVEWAY Paved

Ground Floor



First Floor

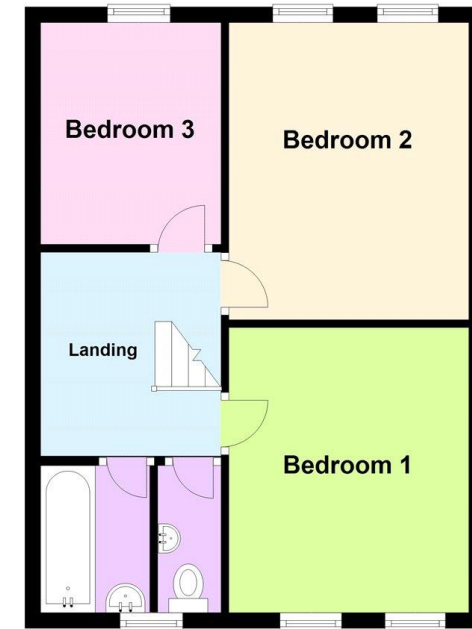



Property Location

George Lane, Lewisham, London, SE13 6HW

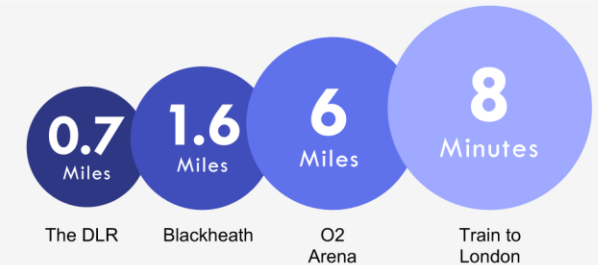

*All distances from branch postcode. Train time from nearest station.

Location

The property is located in the ever-popular leafy Hither Green area famous for its outstanding primary schools and excellent transport links. Served by three main train lines the area is popular with commuters as journeys to Central London take as little as 10 minutes. Access to Canary Wharf/Bank (via the DLR) is available via Lewisham Station, which can be reached by train in 4 minutes. The property is a stone throw away from two superb green areas - Manor House Gardens and Mountsfield Park - one of London's best open spaces and home of the annual People's Day.

Additional Information

Local Authority: London Borough of Lewisham / Council Tax: Band C (£1,811.54 pa) / EPC Rating: C

**FOR MORE INFORMATION
CONTACT US TODAY.**

020 8297 8777

Robinson Jackson
27 Lewis Grove,
Lewisham,
London, SE13 6BG

lewisham@robinson-jackson.com

