



Red Lodge Road | Bexley, Kent, DA5 2JW

 2  1  1 £425,000 Freehold

ROBINSON-JACKSON
Our service will *move* you

Red Lodge Road, Bexley

Situated on the borders of Bexley and Joydens Wood is this immaculately presented 2 bedroom terraced house that benefits from a ground floor WC, off road parking and a modern kitchen extension.

Property Features

- Council Tax: C
- EPC Rating: To be confirmed
- Off Road Parking
- Ground Floor WC
- Modern Extended Kitchen
- Large Family Bathroom
- Fully Double Glazed
- Gas Central Heating



Interior

Entrance Hall Composite door and double glazed window to front. Radiator. Tiled floor. Understairs cupboard.

Living Room Double glazed window to front. Built-in media wall. Radiator x2. Carpet.

Ground Floor WC Corner wash hand basin with storage cupboard under. Low level WC. Extractor fan. Tiled floor.

Kitchen Double glazed window to rear. Double glazed uPVC door to rear. Double glazed Velux window x2. Range of high gloss wall and base units with Quartz work tops. Centre island with breakfast bar. Stainless steel inset sink and rinser. Electric hob with extractor over. Integrated washing machine and dishwasher. Space for American style fridge freezer. Radiator. Tiled floor.

Bedroom 1 Double glazed window to front x2. Radiator. Carpet. Built-in wardrobe.

Bedroom 2 Double glazed window to rear. Radiator. Carpet.

Bathroom Double glazed window to rear. Fully tiled. Bathtub with tiled surround and step. Corner shower cubicle. Low level WC. Floating vanity ink unit. Large backlit wall mirror. Chrome heated towel rail.

Exterior

Front Brick paved driveway for 1 large car or 2 small cars.

Garden Patio area with steps down to lawn. Decked area with garden shed. Rear access path.

Ground Floor
Approx. 47.7 sq. metres (513.7 sq. feet)

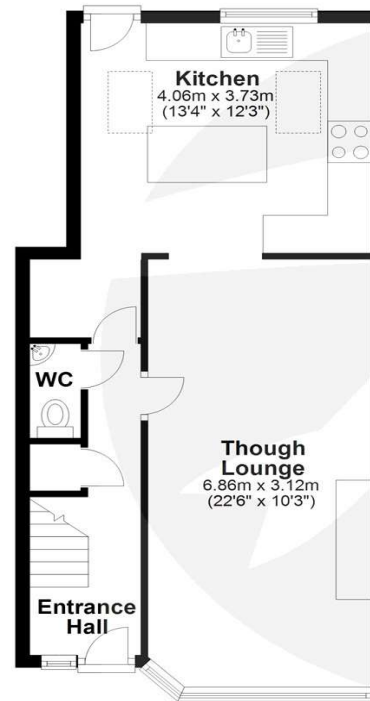

First Floor
Approx. 31.9 sq. metres (343.5 sq. feet)

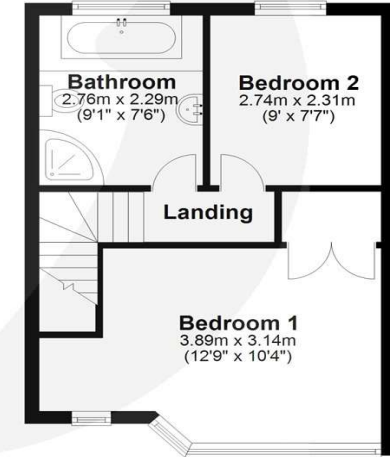

Total area: approx. 79.6 sq. metres (857.2 sq. feet)

Please note that this is for illustration purposes only and should not be used as an exact representation of the property. All measurements are approximate.
Plan produced using PlanUp.





Property Location

Red Lodge Road, Bexley, Kent, DA5 2JW

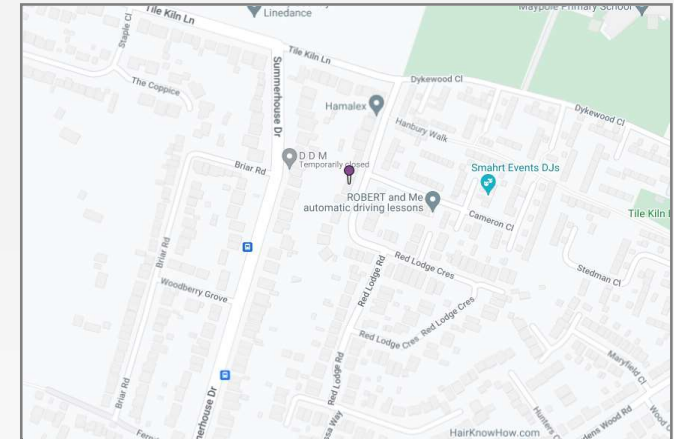

*All distances from branch postcode. Train time from nearest station.

Additional Information

Bexley Village is the heart of the local community and the pretty High Street has resisted turning into another cloned shopping destination. You'll find independent stores, family-run businesses, pubs, restaurants and the mainline train station.

Bexley is also home to two of the borough's grammars and some respected primary schools for families. Hall Place is Bexley Village's most notable attraction. This Grade 1 listed Tudor mansion hosts regular events, and has its own café and neighbouring restaurant.

Joydens Wood is an 'urban village' located between Bexley and Wilmington, with a tranquil woodland managed by the Woodland Trust at its heart. The woodland spans an impressive 333 acres, and is home to a variety of trees, plants, wooden sculptures and remains dating back to Roman times.

Furthermore, Joydens Wood has a selection of popular primary schools and provides convenient access to both Wilmington Grammar schools. Local family-run businesses include a post office, a newsagents, a dry cleaners, a launderette and a butchers.

**FOR MORE INFORMATION
CONTACT US TODAY.**

01322 559900
Robinson Jackson
77 Bexley High Street,
Bexley,
Kent DA5 1JX
bexley@robinson-jackson.com



These particulars do not form part of an offer or contract and must not be relied upon as statements or representation of fact. Any areas, measurements, journey times or distances are approximate. The text, images, photographs and plans are for guidance only and are not necessarily comprehensive. It should not be assumed that the property has all necessary planning, building regulation or other consents and we have not tested any services, equipment or facilities. References to tenure are based on information supplied by the seller. Buyer should verify all information themselves by inspection or otherwise prior to a legal commitment to purchase. Photos and images are subject to copyright.