



Highcombe Close | Mottingham, SE9 4QJ



Guide Price £475,000 - £495,000

Freehold

EPC = D

ROBINSON-JACKSON
Our service will *move* you

Highcombe Close, Nottingham

Offered to the market chain free is this three bedroom semi detached house sitting on a large corner plot. Benefitting from off street parking, detached garage and a large rear garden.

Property Features

- 17ft Reception Room
- Dining Room
- 12ft Fitted Kitchen
- First Floor Bathroom
- Large Garden With Detached Garage
- Chain Free



Interior

Entrance Porch: Tiled flooring.

Entrance Hall: Under stairs storage and carpet as fitted.

Reception Room: 5.28m x 4m (17'4" x 13'1") Feature fireplace with brick surround, square arch to dining room and carpet as fitted.

Dining Room: 3.3m x 3.05m (10'10" x 10') Square arch to living room, double doors to rear garden and carpet as fitted.

Kitchen: 3.86m x 2.7m (12'8" x 8'10") Fitted with a range of wall and base units with complimentary work surfaces. Part tiled walls and vinyl flooring.

Landing: Access to loft and carpet as fitted.

Bedroom 1: 5.30m x 3.38m (17'5" x 11'1") Built in wardrobe and carpet as fitted.

Bedroom 2: 3.38m x 3.07m (11'1" x 10'1") Carpet as fitted.

Bedroom 3: 3.25m x 2.4m (10'8" x 7'10") Built in wardrobe and carpet as fitted.

Bathroom: Fitted with a white four piece suite comprising of a pedestal wash hand basin, low level WC, Bidet and panelled bath. Tiled walls and carpet as fitted.

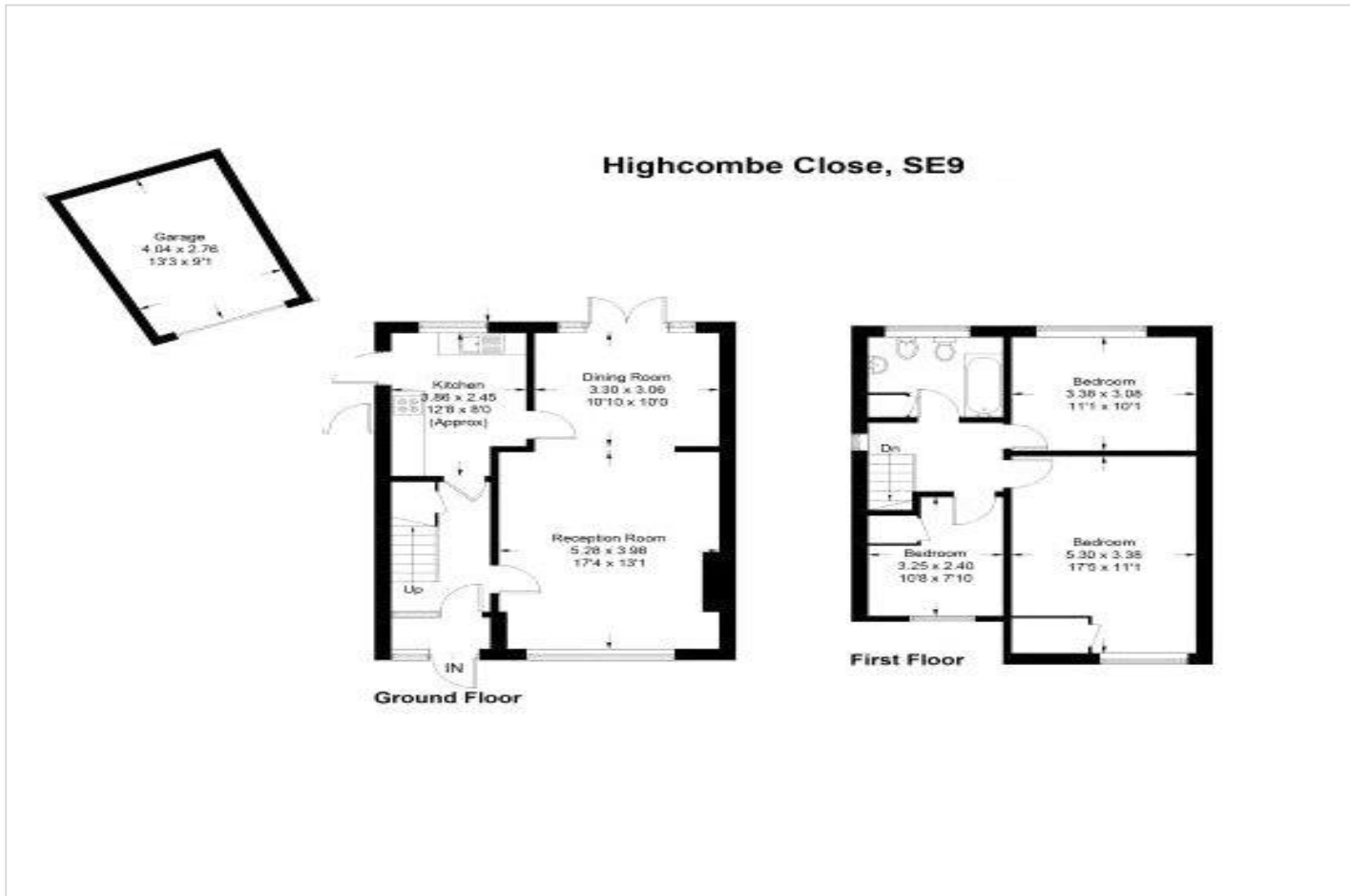



Property Location

Highcombe Close, Mottingham, SE9 4QJ



Exterior

Rear Garden: Approx 22.86m (75') x 22.86m (75') Large rear garden mainly laid to lawn with paved patio area and gate to size.

Detached Garage: 4.04m x 2.76m (13'3" x 9'1") Up and over door.

Off Street Parking: Driveway to side.

**FOR MORE INFORMATION
CONTACT US TODAY.**

020 8859 9600

Robinson Jackson
2-4 Court Yard,
Eltham,
London SE9 5PZ

eltham@robinson-jackson.com

