



Prince John Road | Eltham, SE9 6DD



3



1



2

Guide Price £450,000 - £470,000

Freehold

EPC = C

ROBINSON-JACKSON
Our service will *move* you

Prince John Road, Eltham

A well presented three bedroom, two reception room semi detached family home. Conveniently located for local schools, bus routes, Eltham mainline station and High Street.

Property Features

- Two Reception Rooms
- 19ft Fitted Kitchen
- First Floor Bathroom
- Separate WC
- Mature Established Rear Garden
- Double Glazing & Central Heating



Interior

Entrance Hall: Under stairs storage cupboard, part engineered wood flooring and part carpet as fitted.

Living Room: 4.38m x 3.69m (14'4" x 12'1") Double glazed window to front and carpet as fitted.

Dining Room: 3.29m x 2.88m (10'10" x 9'5") Double glazed window to front and carpet as fitted.

Kitchen: 5.99m x 2.40m (19'8" x 7'10") Fitted with a range of wall and base units with complimentary work surfaces. Space for appliances, large storage cupboard housing boiler, part tiled walls and vinyl flooring.

Landing: Access to loft and carpet as fitted.

Bedroom 1: 4.41m x 3.79m (14'6" x 12'5") Double glazed window to front and wood style laminate flooring.

Bedroom 2: 3.29m x 3.00m (10'10" x 9'10") Double glazed window to front and wood style laminate flooring.

Bedroom 3: 3.79m x 2.38m (12'5" x 7'10") Double glazed window to rear and wood style laminate flooring.

Bathroom: Fitted with a white two piece suite comprising of a vanity wash hand basin with storage under, panelled bath with shower over and glass shower screen. Airing cupboard, part tiled walls and vinyl flooring.

Separate WC: Fitted with a low level WC, vinyl flooring.

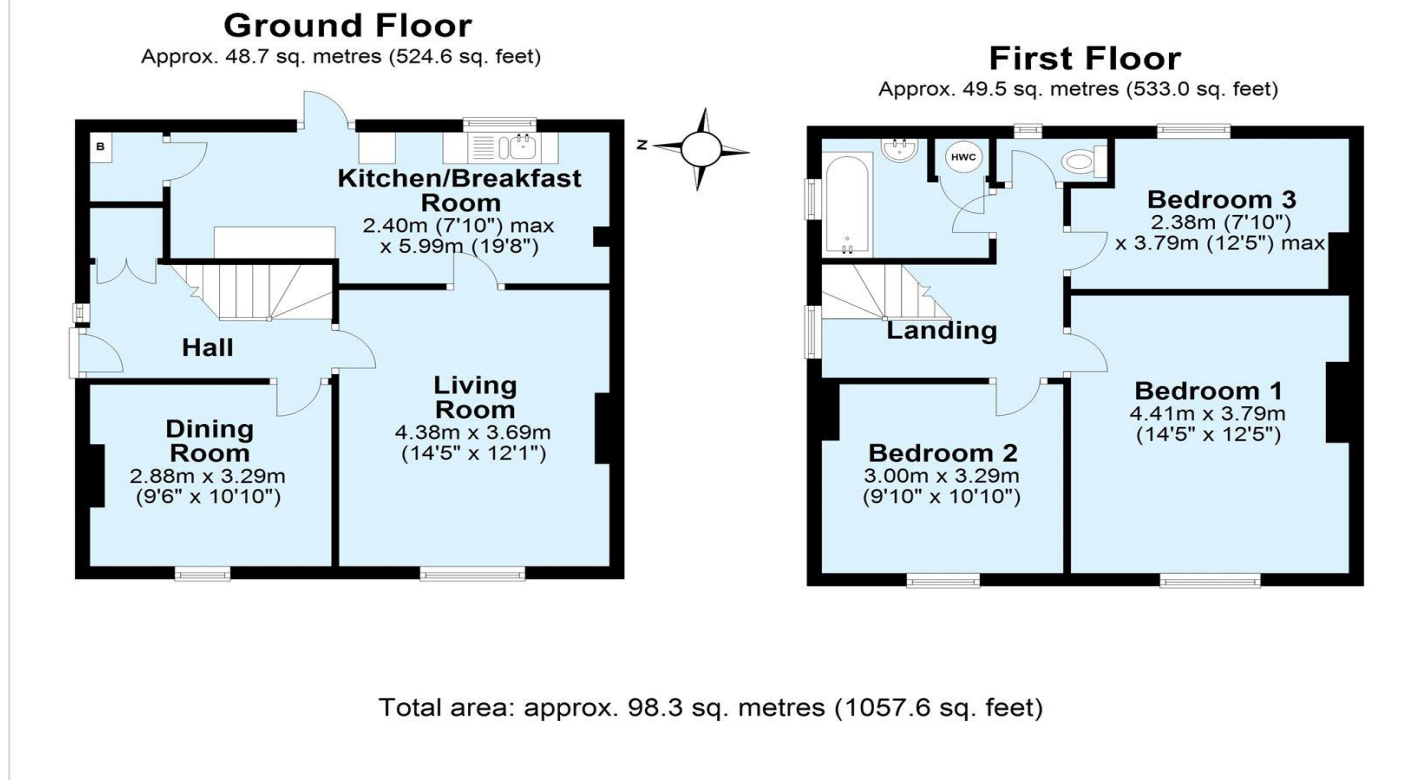



Exterior

Rear Garden: Mature established rear garden mainly laid to lawn with flower and shrub borders. Paved patio area, shed, pond and gate to side.

Front Garden: Mainly laid to lawn gate to side providing access to rear garden.

Additional Information

Eltham is a popular town in the Royal Borough of Greenwich, with £2 million having been spent on a High Street revitalisation programme which include a new multi-screen cinema complex and restaurants. There's a mainline train station offering a direct route to London and the magnificent Art Deco Eltham Palace. The Heritage Restaurant & Bar at the Tudor Barn, a modern leisure centre, the Bob Hope Theatre and Well Hall Pleasaunce can all be found in the town.

Property Location

Prince John Road, Eltham, SE9 6DD



**FOR MORE INFORMATION
CONTACT US TODAY.**

020 8859 9600
Robinson Jackson
2-4 Court Yard,
Eltham,
London SE9 5PZ
eltham@robinson-jackson.com

