



Hutchins Road
Thamesmead
SE28 8SA

A two bedroom modern style home, conveniently located for local shops, schools and bus routes into Abbey Wood for mainline station and forthcoming Crossrail.

- 16ft Living Room
- 12ft Fitted Kitchen
- First Floor Three Piece Bathroom Suite
- Central Heating
- Off Street Parking

Guide Price £300,000 to £320,000

 2  1  1
Freehold EPC Rating: D

ROBINSON-JACKSON
Our service will *move* you

Ground Floor

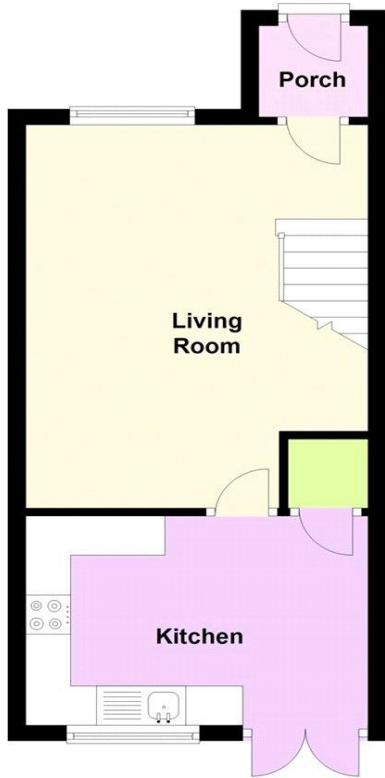

First Floor

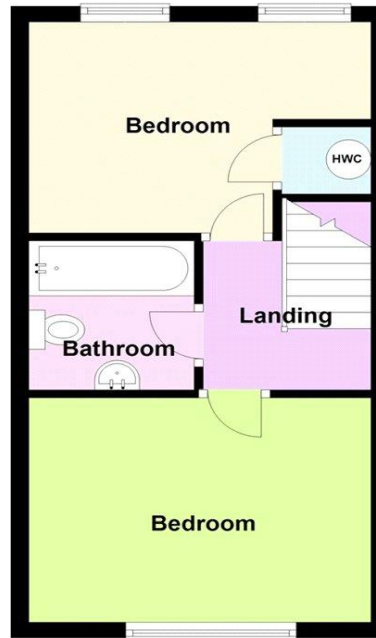

FOR MORE INFORMATION
CONTACT US TODAY.

020 8317 4111

Robinson Jackson
123-125 Plumstead Common Road,
Plumstead,
London SE18 2UQ

plumstead@robinson-jackson.com



Interior

Entrance Hall: Wood style laminate flooring.

Living Room: 4.88m (16') x 2.97m (9'9") (extending to 3.84m (12'7")) Double glazed window to front. Tiled flooring.

Kitchen: 3.8m x 2.67m (12'6" x 8'9") Fitted with a range of wall and base units with complementary work surfaces. Integrated oven and hob with filter hood. Tiled flooring. Part tiled walls. Double glazed window to rear.

Landing: Carpet as fitted and access to loft.

Bedroom 1: 3.84m x 2.84m (12'7" x 9'4") Double glazed window to rear. Vinyl floor tiles.

Bedroom 2: 2.8m (9'2") (extending to 3.35m (11') x 2.7m (8'10")) Double glazed window to front. Carpet as fitted.

Bathroom: Fitted with a three piece suite comprising of a WC, vanity wash hand basin and a panelled bath. Part tiled walls and vinyl flooring.

Exterior

Rear Garden: Mainly laid to lawn with patio area.

Driveway: Providing off street parking for two cars to front.