



Ringlet Grove | Iwade, Sittingbourne, ME9 8XE



Asking Price £230,000 Freehold

ROBINSON MICHAEL & JACKSON
Our service will *move* you

Ringlet Grove, Iwade

Immaculate two bedroom ground floor apartment with parking and private garden!

Property Features

- Council Tax: B
- EPC Rating: B
- Great Location
- Parking
- Private Garden
- Two Bedrooms
- Excellent Presentation
- Share of Freehold



Interior

Living Room: 4.6m x 3.05m (15'1" x 10')

Dining Room: 3m x 3.7m (9'10" x 12'2")

Kitchen: 3.56m x 2.57m (11'8" x 8'5")

Bedroom 1: 2.64m x 5.13m (8'8" x 16'10")

Bedroom 2: 2.72m x 4.04m (8'11" x 13'3")

Bathroom:

Exterior

Allocated parking next to the property.

Private garden with paved patio area and artificial laid lawn.

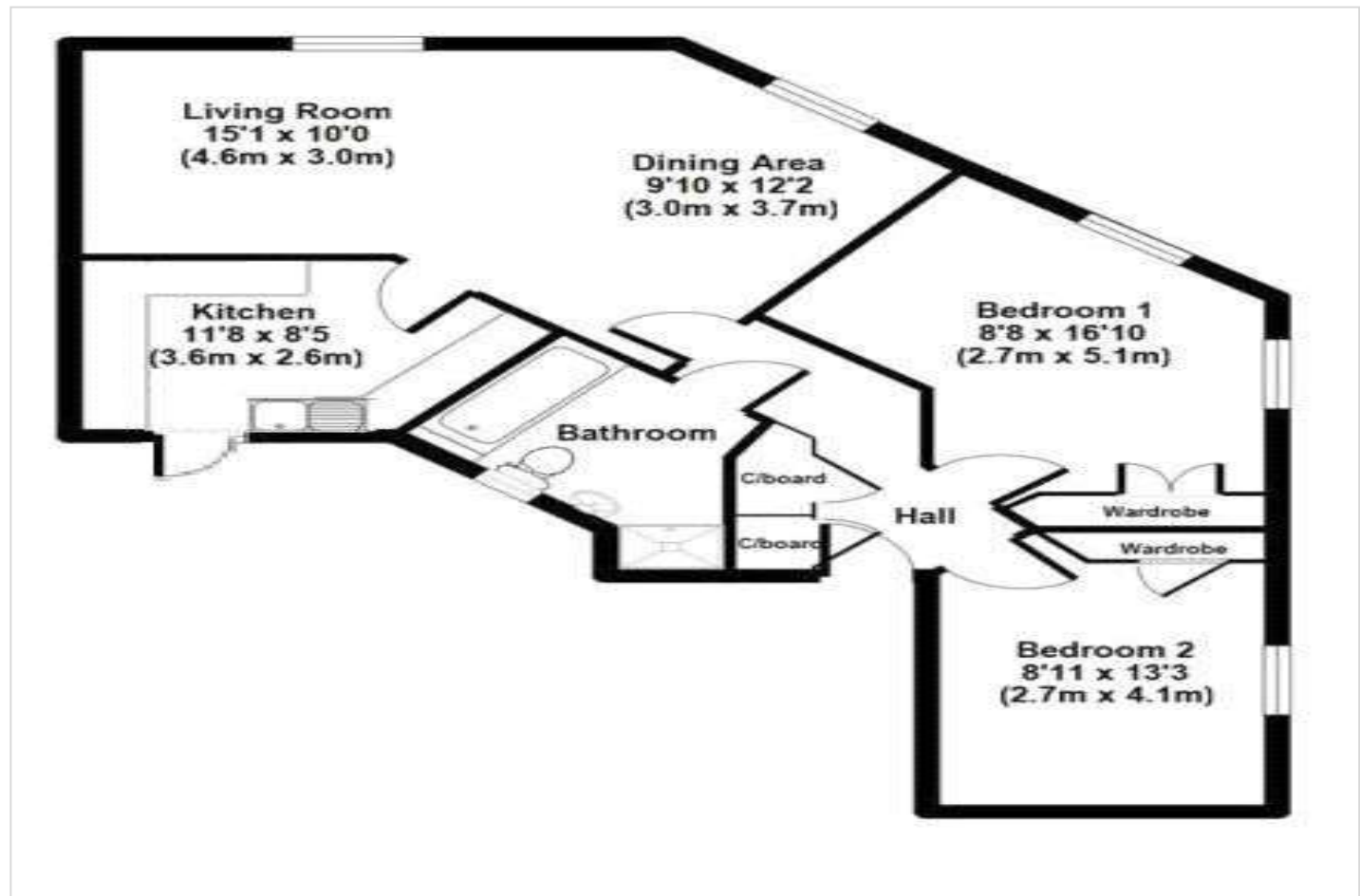



Property Location

Ringlet Grove, Iwade, Sittingbourne, ME9 8XE



FOR MORE INFORMATION CONTACT US TODAY.

01795 479999
Robinson Michael & Jackson
38 West Street,
Sittingbourne,
Kent ME10 1AP
sittingbourne@robinson-jackson.com



These particulars do not form part of an offer or contract and must not be relied upon as statements or representation of fact. Any areas, measurements, journey times or distances are approximate. The text, images, photographs and plans are for guidance only and are not necessarily comprehensive. It should not be assumed that the property has all necessary planning, building regulation or other consents and we have not tested any services, equipment or facilities. References to tenure are based on information supplied by the seller. Buyer should verify all information themselves by inspection or otherwise prior to a legal commitment to purchase. Photos and images are subject to copyright.