



Detling Road | Northfleet, Gravesend, DA11 8DH

 3  1  1 Offers in excess of £290,000 Freehold

EPC = E

ROBINSON MICHAEL & JACKSON 
Our service will **move** you

Detling Road, Northfleet

Located in a quiet cul-de-sac within walking distance to local amenities and transport links is this spacious three bedroom terraced residence. With off street parking to the rear

Property Features

- No Forward Chain
- Three Well Proportioned Bedrooms
- Close to Local Amenities and Transport
- In Need of Modernisation
- Abundance of Potential - Subject to Planning
- 80ft. Approx Rear Garden
- Garage to Rear



Interior

Entrance Hall: Door to entrance hall. Radiator. Carpet. Doors to:-

Lounge: 8.2m x 4.01m (26'11" x 13'2") Double glazed bay window to front. Double glazed window to rear. Radiator. Carpet.

Kitchen: 3.28m x 2.24m (10'9" x 7'4") Double glazed window to rear. Wall and base units with roll top work surface over. Stainless steel sink unit with mixer tap. Four ring electric hob and oven. Utility section. Laminate flooring.

First Floor Landing: 3.28m x 2.4m (10'9" x 7'10") Loft access. Carpet. Doors to:-

Bedroom 1: 4.4m x 2.84m (14'5" x 9'4") Double glazed bay window to front. Radiator. Built-in wardrobe. Carpet.

Bedroom 2: 3.78m x 2.9m (12'5" x 9'6") Double glazed window to rear. Radiator. Carpet. Built-in cupboard.

Bedroom 3: 2.82m x 2.44m (9'3" x 8') Double glazed window to front. Radiator. Built-in storage. Carpet.

Bathroom: 2.34m x 1.47m (7'8" x 4'10") Double glazed frosted window to rear. Suite comprising walk-in shower cubicle. Pedestal wash hand basin. Tiled splash back. Radiator. Carpet.

Separate W.C.: 1.47m x 0.79m (4'10" x 2'7") Double glazed frosted window to rear. Low level w.c. Partly tiled walls. Carpet.

Exterior

Rear Garden: Approx: 80ft: Patio section. Tiered garden. Built-in cupboard housing boiler. Outside w.c

Garage: To rear. Rear vehicular access. Mechanics inspection pit. Hardstanding.

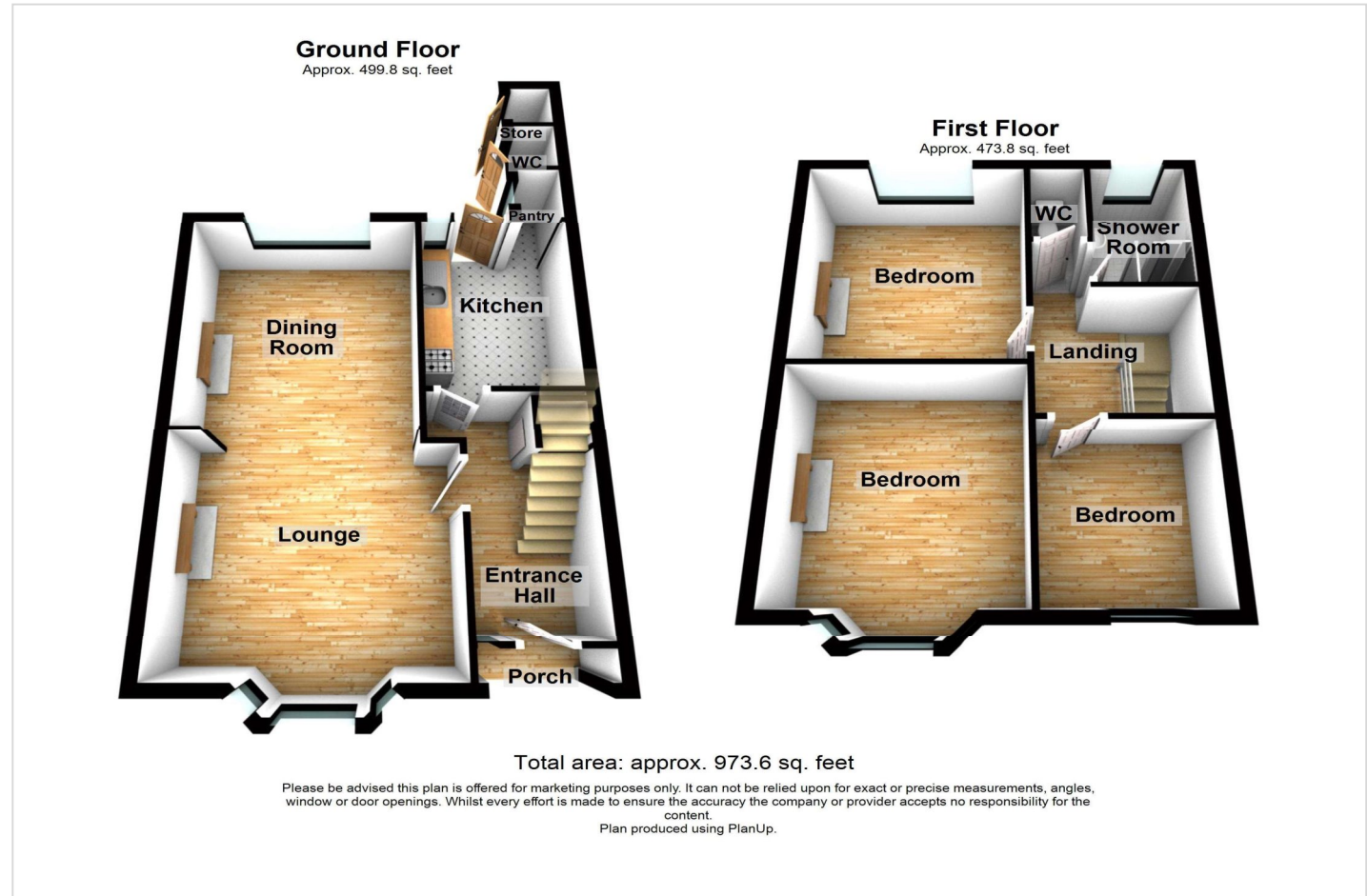



Property Location

Detling Road, Northfleet, Gravesend, DA11 8DH

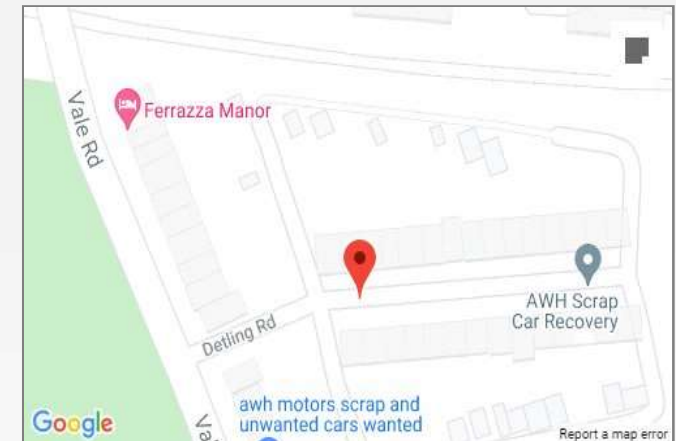

Additional Information

The property is within close proximity to schools, bus routes to Town Centre and mainline stations featuring links to London in as little as 22 minutes. There are superstores within easy reach. The Bluewater Shopping Centre is approximately 10 minutes by car.

**FOR MORE INFORMATION
CONTACT US TODAY.**

01474 333111
Robinson Michael & Jackson
21 King Street,
Gravesend,
Kent DA12 2EB
gravesend@robinson-jackson.com

