



ROBINSON
MICHAEL
& JACKSON
LOCAL OVERSEAS
01474 32777
FOR SALE

Gatwick Road | Gravesend, DA12 5AJ



3



1



1

Offers in excess of £350,000

Freehold

EPC = C

ROBINSON MICHAEL & JACKSON

Our service will **move** you

Gatwick Road, Gravesend

Situated in the sought after Singlewell area is this three-bedroom mid terrace residence with approximately 70' rear garden. Offered with the benefit of no forward chain. Call now to view

Property Features

- No forward chain
- Sought after location
- Walking distance to local amenities
- Approximately 70' rear garden



Interior

Entrance Hall: 4.75m x 1.12m (15'7" x 3'8") Double glazed door into entrance hall. Stairs to first floor. Single radiator. Laminate flooring.

Lounge: 4.62m x 3.58m (15'2" x 11'9") Double glazed bay window to front. Coved ceiling. Double radiator. Carpet.

Kitchen: 5.54m x 3.84m (18'2" x 12'7") Double glazed door to rear. Double glazed window to rear. Wall and base units with roll top work surface over. Built-in oven and hob with extractor hood over. Sink and drainer unit with mixer tap and tiled splash back. Space for washing machine. Double radiator. Laminate flooring.

First Floor Landing: 2.64m x 2.03m (8'8" x 6'8") Loft access. Carpet. Doors to: -

Bedroom 1: 4.62m x 3.33m (15'2" x 10'11") Double glazed window to front. Coved ceiling. Single radiator. Carpet.

Bedroom 2: 3.78m x 3.35m (12'5" x 11') Double glazed window to rear. Single radiator. Carpet.

Bedroom 3: 2.64m x 2.06m (8'8" x 6'9") Double glazed window to front. Single radiator. Carpet.

Bathroom: 2.16m x 2.06m (7'1" x 6'9") Double glazed frosted window to rear. Suite comprising panelled bath with mixer tap. Wash hand basin. Low level w.c. Tiled flooring. Single radiator. Fully tiled walls.

Exterior

Rear Garden: Approx. 70ft x 20ft: Patio area. Laid to lawn. Supplied with power. Outside tap.

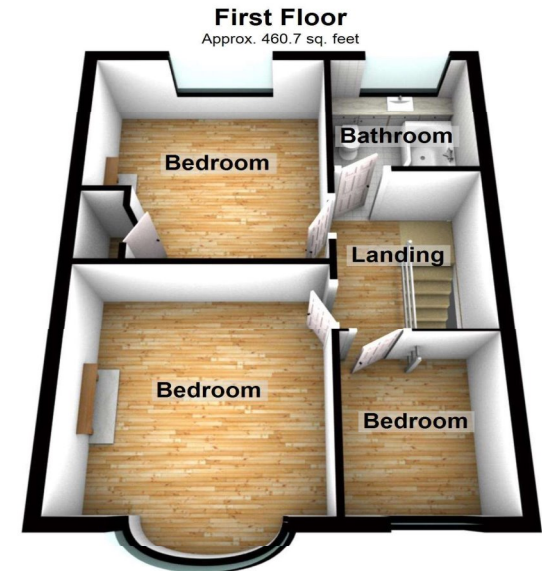
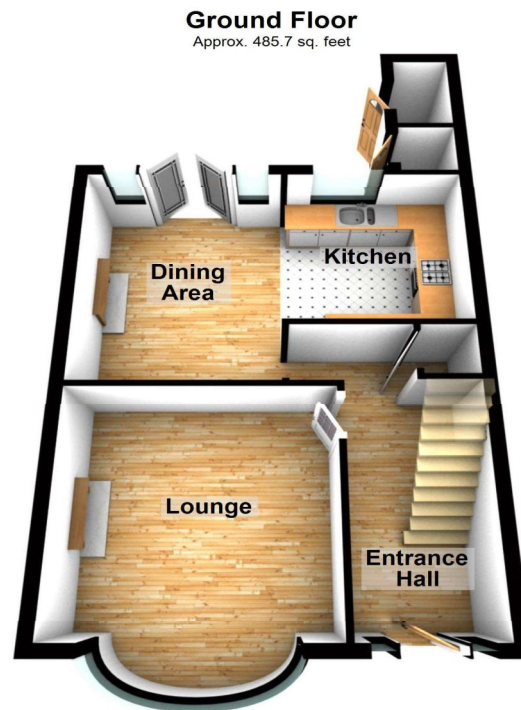

Total area: approx. 946.3 sq. feet

Please be advised this plan is offered for marketing purposes only. It can not be relied upon for exact or precise measurements, angles, window or door openings. Whilst every effort is made to ensure the accuracy the company or provider accepts no responsibility for the content.

Plan produced using PlanUp.





Property Location

Gatwick Road, Gravesend, DA12 5AJ

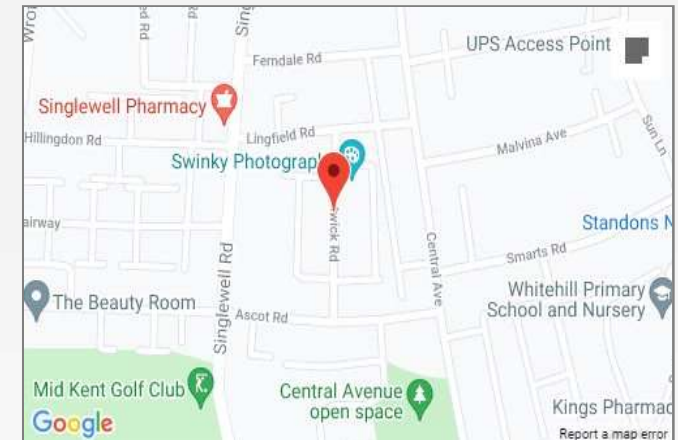

Additional Information

Gravesend is sought-after by families looking for high-calibre education. As well as a number of private schools, including Gads Hill, Bronte and Cobham Hall, there is the duo of well-respected grammar schools – Gravesend Grammar for Boys and Gravesend Grammar for Girls. The choice of primary schools is extensive and further education is provided in the shape of Northwest Kent College, The University of Greenwich and Mid. Kent College.

**FOR MORE INFORMATION
CONTACT US TODAY.**

01474 333111
Robinson Michael & Jackson
21 King Street,
Gravesend,
Kent DA12 2EB
gravesend@robinson-jackson.com