



Hatton Close | Northfleet, Kent, DA11 8SD



1



1



1

Offers in excess of £180,000

Leasehold

EPC = C

**ROBINSON MICHAEL & JACKSON**  
Our service will *move* you



## Hatton Close, Northfleet

Situated in the sought-after Painters Ash Location is this one-bedroom ground floor maisonette with allocated parking and private rear garden. Viewing recommended!

### Property Features

- Approx. 970-year lease
- Peppercorn Ground Rent
- No Service Charge
- Double Bedroom with Built in Wardrobe
- Allocated Parking
- Private Rear Garden



## Interior

**Entrance:** Double glazed door into entrance hall.

Doors to: -

**Lounge:** 5.18m x 3.3m (17' x 10'10") Double glazed window to front. Electric heater. Two built-in storage cupboards.

**Kitchen:** 3.15m x 1.7m (10'4" x 5'7") Double glazed window to rear. Double glazed door to garden. Wall and base units with roll top work surface over. Stainless steel sink unit with mixer tap. Space for appliances. Tiled flooring.

**Bedroom:** 3.05m x 2.72m (10' x 8'11") Double glazed window to rear. Built-in wardrobe. Carpet.

**Bathroom:** 1.83m x 1.5m (6' x 4'11") Enclosed bathroom comprising panelled bath with shower over. Pedestal wash hand basin. Low level w.c. Tiled walls. Laminate flooring.

## Exterior

**Rear Garden:** Approx. 30ft: Paved patio area. Laid to lawn.

**Parking:** One allocated parking space.

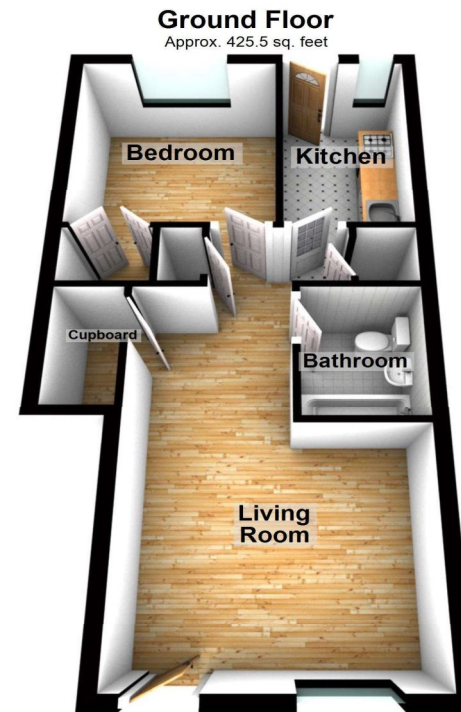

Total area: approx. 425.5 sq. feet

Please be advised this plan is offered for marketing purposes only. It can not be relied upon for exact or precise measurements, angles, window or door openings. Whilst every effort is made to ensure the accuracy the company or provider accepts no responsibility for the content.  
Plan produced using PlanUp.





## Property Location

Hatton Close, Northfleet, Kent, DA11 8SD

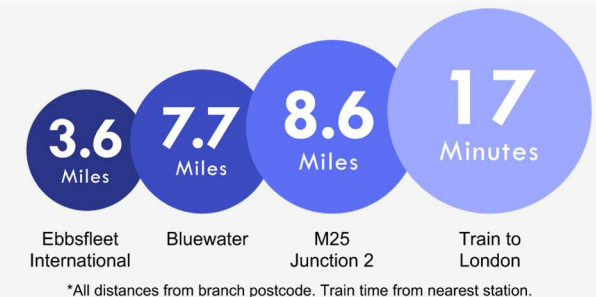

## Leasehold Information

- Approx. 970-year lease
- Peppercorn Ground Rent
- No Service Charge

## Additional Information

Gravesend is the stop before Ebbfleet International and benefits from the new high speed rail connection. Commuters can travel into St. Pancras International from Gravesend in just 17 minutes. Going in the opposite direction you can be in Paris in just two hours. Trains from Gravesend also run into London Bridge, Waterloo East and Charing Cross. There are direct bus routes to Bluewater and major towns in Kent, like Dartford and Rochester. The A2 passes through Gravesend and offers a direct road route into Central London or out to the M25 and Canterbury.

**FOR MORE INFORMATION  
CONTACT US TODAY.**

01474 333111  
Robinson Michael & Jackson  
21 King Street,  
Gravesend,  
Kent DA12 2EB  
[gravesend@robinson-jackson.com](mailto:gravesend@robinson-jackson.com)

