



Redwing Crescent Waterstone Way DA9 9TE

Leasehold



Council Tax: C
EPC Rating: B

Robinson-Jackson are delighted to offer this beautiful 1-bedroom apartment located on the lovely Waterstone Park Development with balcony. The property comprises of a spacious bedroom with floor to ceiling windows allowing plenty of natural light, a modern reception space leading to a double balcony and a sizable bathroom.

- Open plan living space
- Allocated parking
- Walking distance to Greenhithe station
- Close proximity to Bluewater shopping centre

Guide Price £210,000 to £220,000

ROBINSON-JACKSON
Our service will *move* you

Redwing Crescent, DA9

Approximate Gross Internal Area = 46 sq m / 498 sq ft

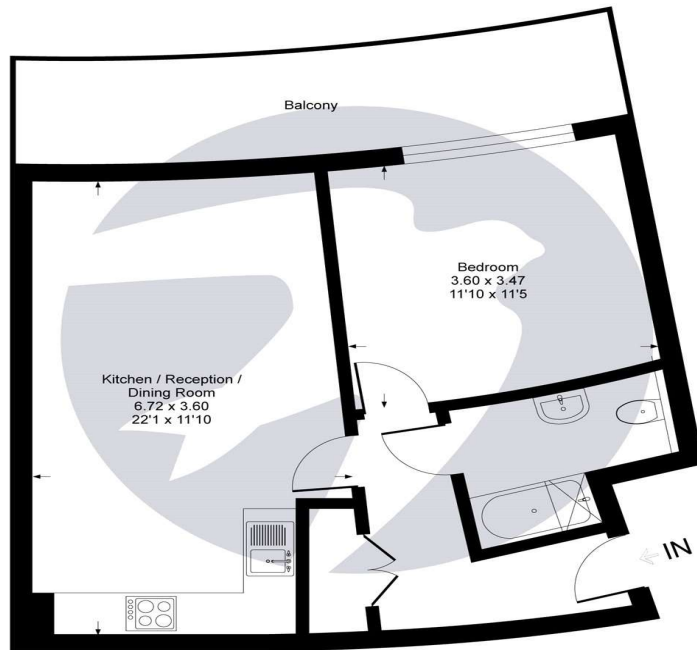

First Floor



This plan is for layout guidance only. Not drawn to scale unless stated. Windows and door openings are approximate. Whilst every care is taken in the preparation of this plan, please check all dimensions, shapes and compass bearings before making any decisions reliant upon them. Produced by Planpix



FOR MORE INFORMATION
CONTACT US TODAY.

01322 624440

Robinson Jackson
39 High Street,
Swanscombe
Kent,
DA10 0AG

swanscombe@robinson-jackson.com



Interior

Lounge: Double glazed windows and door leading to balcony. Radiator. Carpet.

Kitchen: Range of matching wall and base units with complimentary work surface over. Stainless steel sink with drainer. Integrated electric oven, gas hob and extractor. Integrated fridge freezer. Tiled flooring.

Bedroom: Double glazed window and door to balcony. Radiator. Carpet.

Bathroom: Low level WC. Pedestal wash hand basin. Panelled bath with shower over and shower screen. Radiator. Part tiled walls. Spotlights. Vinyl flooring.

Exterior

Private balcony.

Allocated parking.

Additional Information

Dartford Borough Council - Tax Band C

Total floor area: 42 sq. metres

Leasehold Information

Lease created on: 1st January 2006 for 250 years

Remaining term on lease: 233 years

Current annual ground rent: £300pa

Current annual service charge: £1592.61

(All information regarding lease term and service charges have been provided by the seller and should be verified by your solicitor).