



16

Marion Close

Chatham | Kent | ME5 9QA



Marion Close

Chatham, Kent, ME5 9QA

Asking Price

£350,000

Freehold

Offered to the market with no forward chain! This perfectly situated two bedroom link detached bungalow is within walking distance to the local village and oozes potential to make your own!

Benefitting from:

- No chain
- Link detached bungalow
- Extended to the rear
- Drive and garage
- Sought after location
- Within walking distance to the village
- Council Tax: D
- EPC Rating: D



Accommodation

Entrance Hall

Kitchen 5.16m x 2.36m (16'11" x 7'9")

Dining Room 4.85m x 3.56m (15'11" x 11'8")

Living Room 4.01m x 3.45m (13'2" x 11'4")

Reception Room 3.94m x 3.63m (12'11" x 11'11")

Reception/Study 4.72m x 2.34m (15'6" x 7'8")

Bedroom One 3.96m x 3.02m (13' x 9'11")

WC off the main bedroom

Bedroom Two 3.6m x 3.05m (11'10" x 10')

Shower Room 2.5m x 2.36m (8'2" x 7'9")

Exterior

Front and rear gardens:

- Mainly laid to lawn
- Secure fencing
- Drive & Garage
- Side access





Council Tax - D

EPC Rating - D





Important Notice

These particulars do not form part of an offer or contract and must not be relied upon as statements or representation of fact. Any areas, measurements, journey times or distances are approximate. The text, images, photographs and plans are for guidance only and are not necessarily comprehensive. It should not be assumed that the property has all necessary planning, building regulation or other consents and we have not tested any services, equipment or facilities. References to tenure are based on information supplied by the seller. Buyer should verify all information themselves by inspection or otherwise prior to a legal commitment to purchase. Photos and images are subject to copyright.

Location



(All distances & times are approximates)

FOR MORE INFORMATION CONTACT US TODAY.

Kendell Laretive - Assistant Manager

01634 868000

Robinson Michael & Jackson
381 Walderslade Road,
Walderslade,
Kent ME5 9LL

walderslade@robinson-jackson.com

SALES | MORTGAGES | LEGALS

ROBINSON MICHAEL & JACKSON

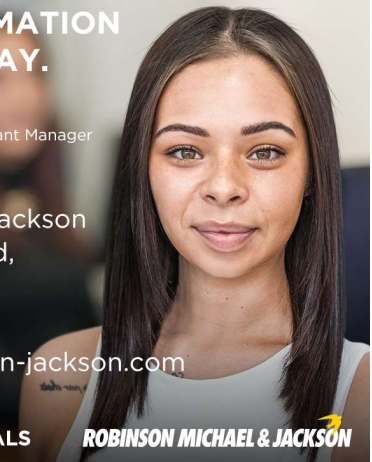

Ground Floor

Approx. 1367.8 sq. feet

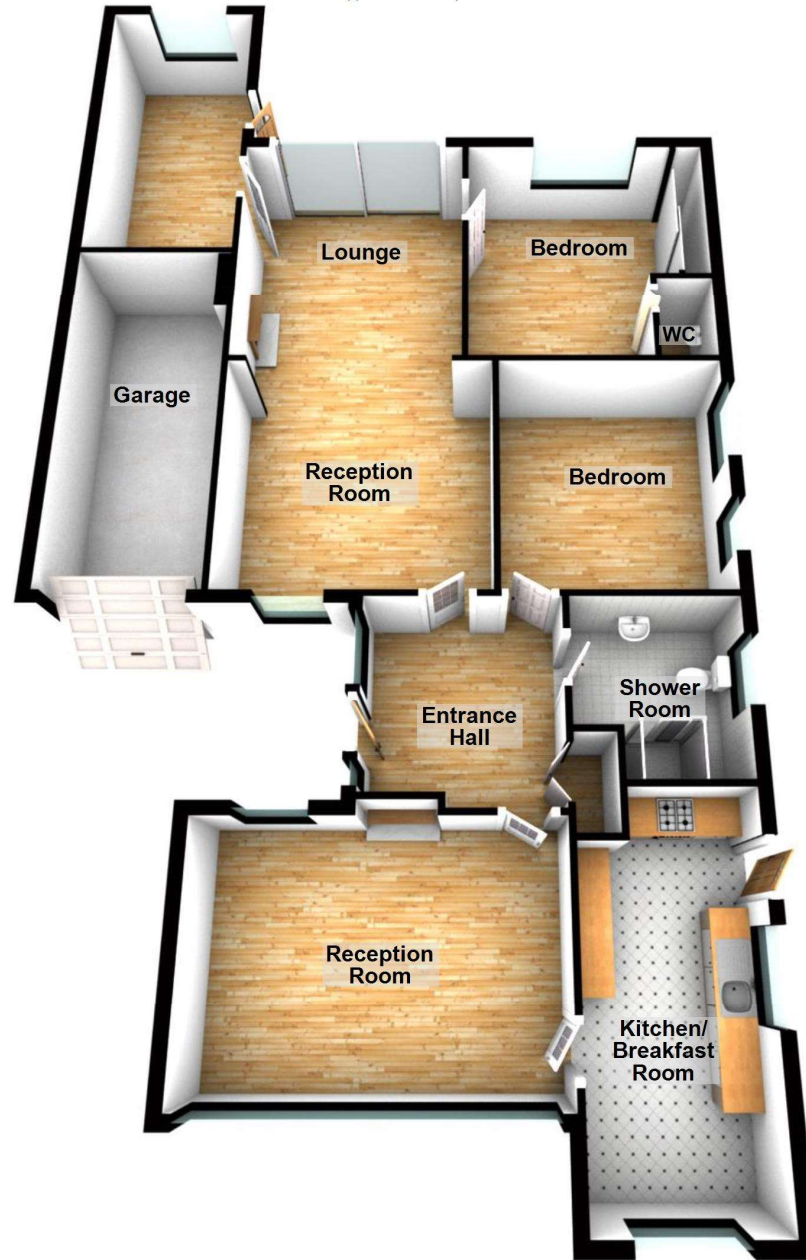

Total area: approx. 1367.8 sq. feet

Please be advised this plan is offered for marketing purposes only. It can not be relied upon for exact or precise measurements, angles, window or door openings. Whilst every effort is made to ensure the accuracy the company or provider accepts no responsibility for the content.
Plan produced using PlanUp.

