



Deals Gateway
Lewisham
SE13 7QG
Leasehold

A superb one bedroom apartment found on the ground floor of this impressive development of ONESE8 which is located moments from Deptford bridge DLR and is also just a short walk from Greenwich town centre. The site benefits from having communal leisure facilities including gymnasium and lap pool plus concierge service. There is also a shop on site. The accommodation briefly comprises of a kitchen living space, double bedroom, and a bathroom. There is also electric heating, double glazing, and video entry.



Council Tax: B
EPC Rating: C

Asking Price £250,000

ROBINSON-JACKSON
Our service will *move* you

Floor Plan

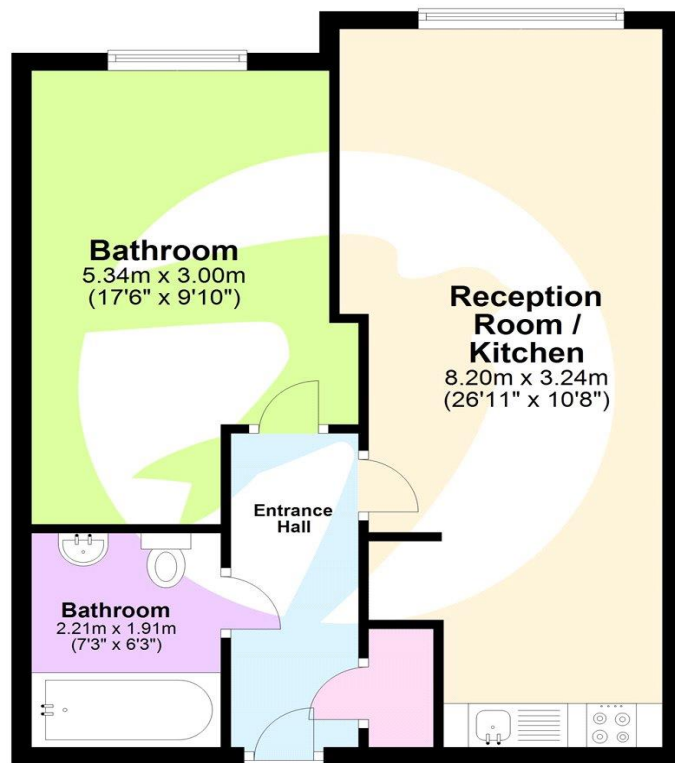

FOR MORE INFORMATION
CONTACT US TODAY.

020 8297 8777

Robinson Jackson
27 Lewis Grove,
Lewisham,
London, SE13 6BG

lewisham@robinson-jackson.com



Location

While it's easy to hop on the train or DLR at Lewisham station to explore the rest of London, there's plenty in the town itself. There's an indoor shopping centre and a daily street market, a surprising amount of green space and restaurants serving world cuisine.

Families can choose from a wide selection of state primary and secondary schools, as well as some respected independent options. Blackheath is Lewisham's close neighbour, with fine dining, boutique shops and bustling bars.

Leasehold Information

Lease Term: 104 years*

Service Charge: £1,906.04 per year (£953.02 half annually paid in advance) *

Ground Rent: £200 per year*

Reserve Fund: £280.80 per year (£140.40 half annually in advance) *

(*to be verified by Vendors Solicitor)

Additional Information

Local Authority: London Borough of Lewisham

Council Tax: Band B (£1,498.20 pa)

Property Features

- One bedroom flat
- Open plan living
- Fully fitted bathroom
- Kitchen with build in appliances
- Close to local amenities and transport links
- CHAIN FREE
- Total floor area: 41m² = 441ft² (guidance only)