



Russell Close | Bexleyheath, Kent, DA7 4HX



Price on Application

To be advised

EPC = To be confirmed

ROBINSON-JACKSON
Our service will *move* you

Russell Close, Bexleyheath

Situated within a popular cul de sac and within walking distance to Bexleyheath Broadway Centre, is this 2 bedroom First Floor Maisonette. 927 Year Lease.

Property Features

- First Floor Maisonette
- Two Bedrooms
- 14'11 Living Room
- Residents Parking
- Close To All Amenities Of Bexleyheath
- 927 Year Lease
- Ground Rent £5.00 Per Annum



Interior

Entrance Hall 3.86m x 0.81m
(12'8" x 2'8")

Lounge 4.22m x 3.15m (13'10" x 10'4")

Kitchen 4.55m x 3.23m (14'11" x 10'7")

Bedroom 1 4.22m x 3.15m (13'10" x 10'4")

Bedroom 2 2.72m x 2.44m (8'11" x 8')

Bathroom 1.88m x 1.6m (6'2" x 5'3")

Exterior

Residents Parking

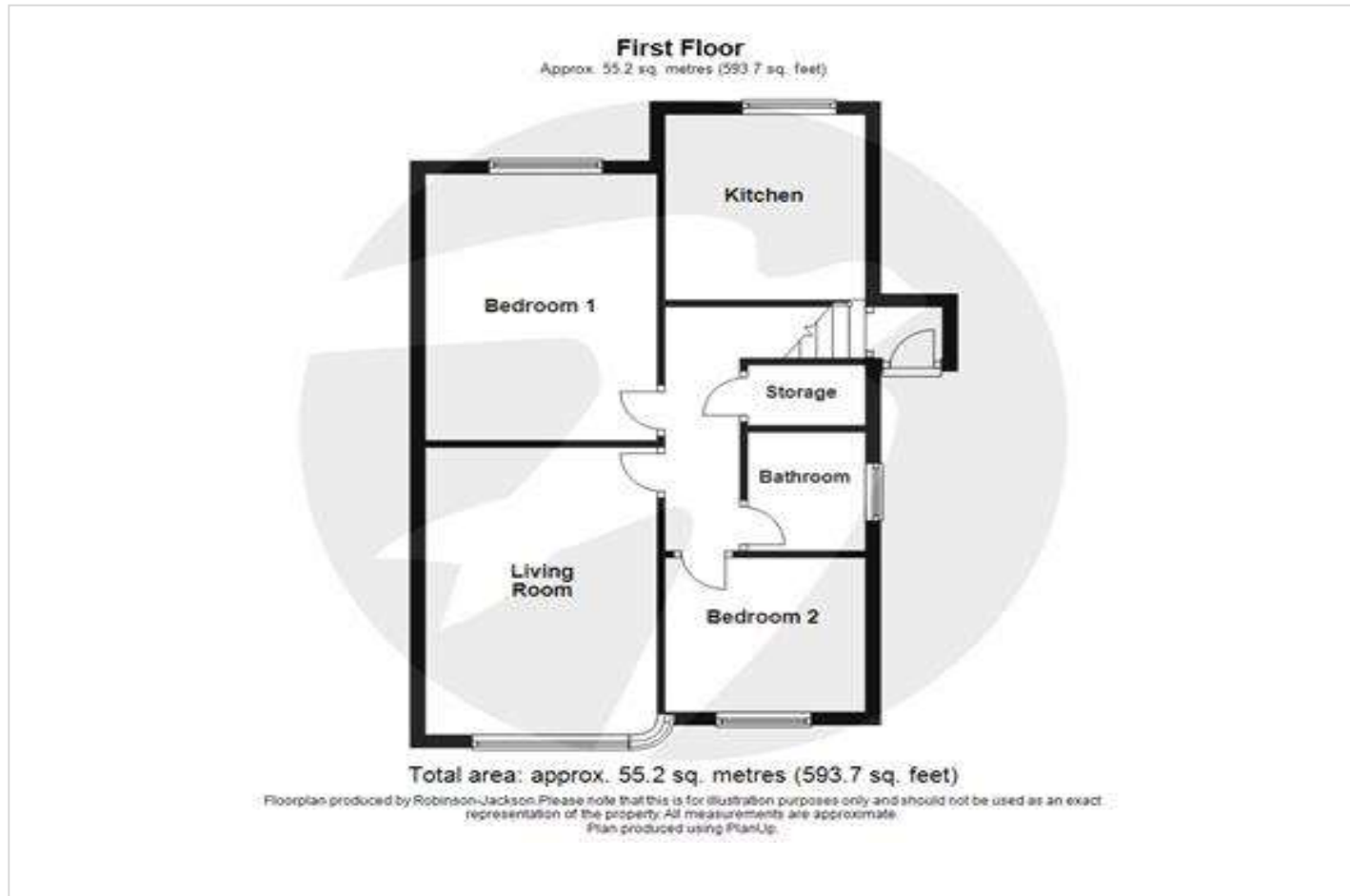



Property Location

Russell Close, Bexleyheath, Kent, DA7 4HX



Additional Information

Bexleyheath is home to the borough's largest shopping facility, where you'll find high-street names, and supermarkets. There's a bowling alley, a cinema, Crook Log Leisure Centre, regular specialist markets and family-friendly restaurants too.

Families are also attracted to Bexleyheath for the schooling – with two of the borough's grammars and excellent primaries close by. The Red House – an Arts & Crafts property designed for the artist and socialist William Morris - is Bexleyheath's premier cultural attraction.

FOR MORE INFORMATION CONTACT US TODAY.

020 8298 7000

Robinson Jackson
124 Broadway,
Bexleyheath,
Kent DA6 7DQ

bexleyheath@robinson-jackson.com

