



Waltham Close | West Dartford, Kent, DA1 3LT



Guide Price £475,000 to £510,000

Freehold

**ROBINSON-JACKSON**  
Our service will *move* you

## Waltham Close, West Dartford

Robinson Jackson are pleased to offer this well presented and maintained three bedroom family home located in the ever sought after West Dartford. Benefitting from a double storey extension and large

### Property Features

- Council Tax: D
- EPC Rating: D
- Extended Family Home
- Located in a Cul-De-Sac
- Catchment to Sought After Grammar Schools
- Large Rear Garden
- Garage and Parking
- Popular West Dartford Location



## Interior

**Entrance Hall** Entrance door. Frosted window to side. Stairs to first floor. Under stairs storage cupboard. Radiator. Laminate flooring

**Kitchen** 5.18m x 1.75m (17' x 5'9") Double glazed window to rear. Range of wall and base units with complementary worksurfaces over incorporating sink drainer. Integrated double oven, hob and extractor hood. Integrated fridge freezer. Integrated dishwasher and Plumbed for washing machine. Radiator. Part tiled walls. Vinyl flooring.

**Through Lounge** 10.54m x 3.07m (34'7" x 10'1") double glazed Bay window to front. Double glazed French doors to rear. Radiators. Vinyl flooring.

**Landing** Frosted double glazed window to side. Access to insulated loft. Carpet.

**Bedroom One** 6.38 (20'11")m x 2.84 (9'4")m red to 2.5 (8'2")m Double glazed window to rear. Radiator. Carpet.

**Bedroom Two** 4.1m x 3.07m (13'5" x 10'1") Double glazed bay window to front. Ceiling spotlights. Radiator. Carpet.

**Bedroom Three** 2.06m x 1.85m (6'9" x 6'1") Double glazed window to front. Radiator. Carpet.

**Bathroom** 5.18 (17')m red. to 2.92 (9'7")m x 2.4 (7'10")m red.to1.68 (5'6")m Frosted double glazed windows to rear and side. Textured ceiling. Tiled walls. Low level WC. Pedestal wash hand basin. Shower cubicle. Panelled corner bath. Radiator. Carpet.

**Ground Floor**  
Approx. 49.1 sq. metres (529.0 sq. feet)

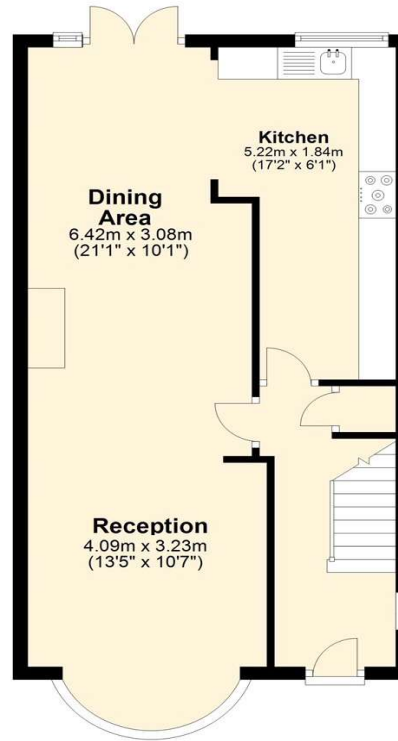

**First Floor**  
Approx. 48.9 sq. metres (526.7 sq. feet)

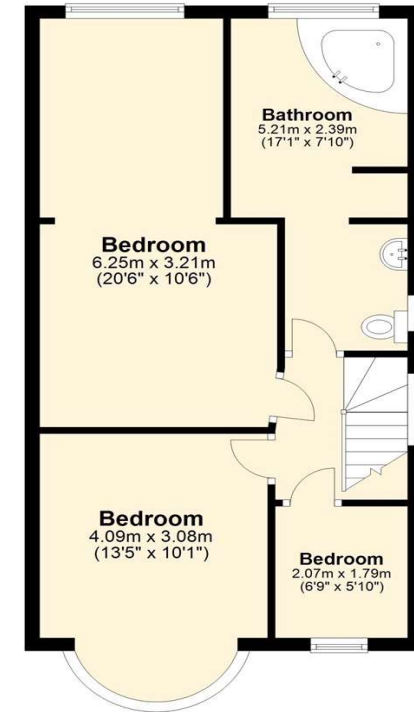

Total area: approx. 98.1 sq. metres (1055.6 sq. feet)





## Additional Information

The boiler is located in the loft

The property measures: 98 Sqm

## Exterior

Front Garden: Pattern imprinted driveway for upto three cars

Rear Garden: Approx 150'. Patio. Lawn. Established flower beds. Side gated access.

## Property Location

Waltham Close, West Dartford, Kent, DA1 3LT

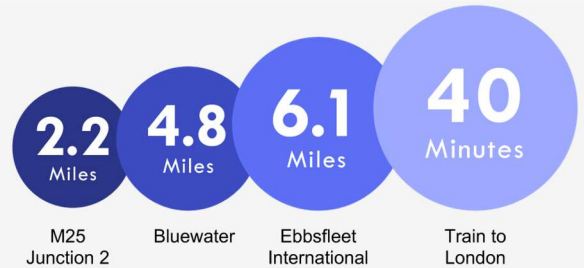
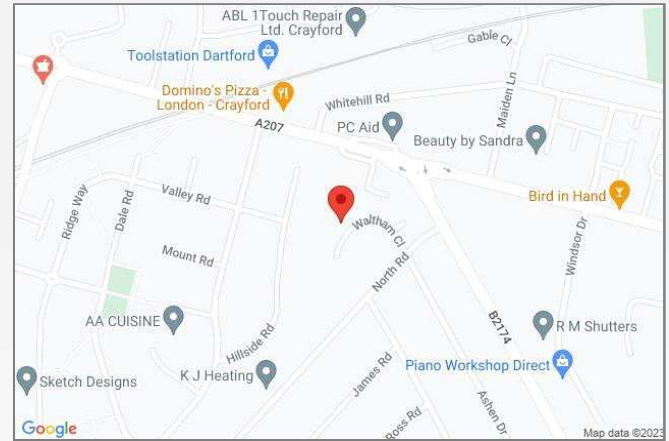

\*All distances from branch postcode. Train time from nearest station.

**FOR MORE INFORMATION  
CONTACT US TODAY.**

01322 281281  
Robinson Jackson  
22 Market Street,  
Dartford,  
Kent DA1 1EZ  
dartford@robinson-jackson.com



These particulars do not form part of an offer or contract and must not be relied upon as statements or representation of fact. Any areas, measurements, journey times or distances are approximate. The text, images, photographs and plans are for guidance only and are not necessarily comprehensive. It should not be assumed that the property has all necessary planning, building regulation or other consents and we have not tested any services, equipment or facilities. References to tenure are based on information supplied by the seller. Buyer should verify all information themselves by inspection or otherwise prior to a legal commitment to purchase. Photos and images are subject to copyright.