



Starts Hill Road | Orpington, Kent, BR6 7AP



3



2



1

Guide Price £450,000 to £475,000 Freehold

ROBINSON-JACKSON
Our service will *move* you

Starts Hill Road

Orpington

An opportunity to purchase this three bedroom terraced house situated conveniently for Darrick Wood School & the Princess Royal Hospital. The property benefits from a ground floor wc & garage to rear.

Property Features

- Central Heating & Double Glazing
- Modern & Stylish Decor
- Ground Floor Cloakroom
- Front & Rear Gardens
- Garage To Rear
- Sought After Location
- Close To Locksbottom Shops
- Council Tax: D
- EPC Rating: D



Interior

Entrance Porch: Double glazed door to front. Double glazed window to side.

Kitchen: 2.9m x 2.82m (9'6" x 9'3") Fitted with a matching range of wall and base units with solid wood work surfaces. Integrated oven, gas hob and extractor canopy. Ceramic sink unit & drainer. Space for washing machine. Built in dishwasher. Double glazed window to rear.

Ground Floor Cloakroom: Fitted with a wash hand basin and wc. Double glazed opaque window to rear.

Inner Hall: Double glazed door leading to rear garden.

Lounge: 4.8m x 4.65m (15'9" x 15'3") Double glazed window to front, stairs to first floor, radiator and wood laminate flooring.

Landing: Access to loft, airing cupboard and fitted carpet.

Bedroom 1: 4.17m x 2.87m (13'8" x 9'5") Double glazed window to front, radiator and wood laminate flooring.

Bedroom 2: 2.84m x 2.8m (9'4" x 9'2") Double glazed window to rear, built in wardrobes, radiator and wood laminate flooring.

Bedroom 3: 2.8m x 1.68m (9'2" x 5'6") Double glazed window to front, built in cupboard, radiator and wood laminate flooring.

Bathroom: Fitted with a modern three piece suite with contrasting chrome fittings comprising a panelled bath with shower over, bi-fold glass shower screen, pedestal wash hand basin and wc. Heated towel rail. Double glazed opaque window to rear.

Ground Floor

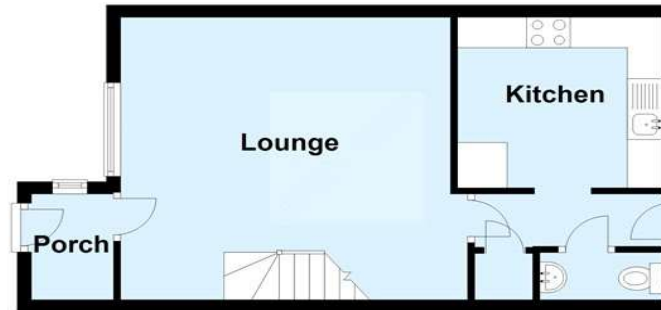

First Floor

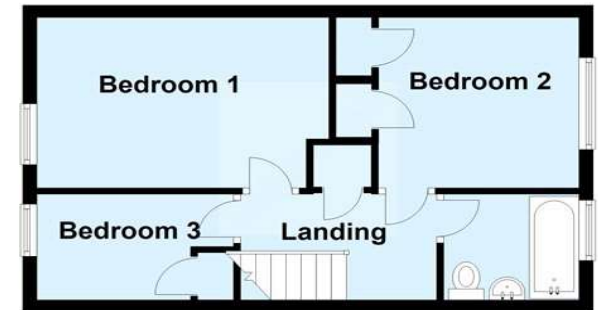

This plan is for general layout guidance and may not be to scale.
Plan produced using PlanUp.





Property Location

Starts Hill Road, Orpington, Kent, BR6 7AP



Exterior

Front Garden: With a lawn and pathway to front.

Rear Garden: Mainly paved offering low maintenance.

Garage: (Accessed via Wellbrook Road) With up and over door.

Additional Information

Starts Hill Road is well located for Locksbottom & Farnborough amenities alike, Darrick Wood Schools and Princess Royal Hospital. Orpington & Bromley are only a short drive away.

Please note: We are required to advise you that the owner of the above property is related to an employee within the Robinson Jackson Group.

**FOR MORE INFORMATION
CONTACT US TODAY.**

01689 833322
Robinson Jackson
292 High Street,
Orpington,
Kent BR6 0NF
orpington@robinson-jackson.com

