



12 Wharfside Close | DA8 1QR



4



1



1

Guide Price £385,000

Freehold

ROBINSON-JACKSON
Our service will *move* you

Wharfside Close,

We are pleased to present this rarely available, 4 bedroom town house, within walking distance of Erith town centre, train station and local schools. Added benefits including a 13'2 balcony with stunning river views and being sold with no chain.

Property Features

- Council Tax: D
- EPC Rating: C
- 13' Riverside balcony
- 6'8 x 7'4 Utility room
- 8' x 7' Fitted kitchen
- 17'5 x 8'5 Garage
- Top floor family bathroom and ground for WC
- No Chain

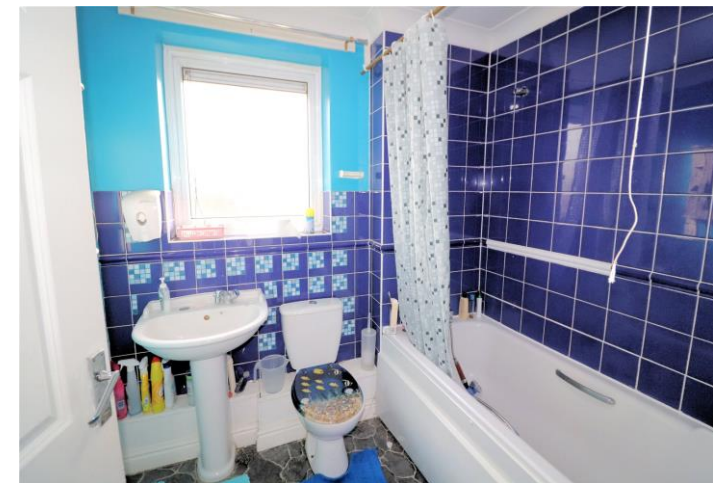

Interior

Entrance Hall Part glazed UPVC entrance door. Radiator. Carpet. Understairs storage cupboard.

WC 0.79m x 1.42m (2'7" x 4'8") Wall mounted wash hand basin with separate taps. Low level wc. Radiator. Extractor.

Utility Room 2.03m x 2.24m (6'8" x 7'4") Double glazed UPVC door leading to garden. Plumbing for washing machine. Space for tumble dryer. Radiator. Door leading to bedroom 4.

Bedroom 4 2.54m x 2.24m (8'4" x 7'4") Double glazed window to rear. Radiator. Fitted wardrobes. Carpet. Coved ceiling.

First Floor Landing Radiator. Carpet.

Lounge 6.32 (20'9")m x 2.26 (7'5")m x 5.03 (16'6")m L shaped Double glazed window to rear. Double glazed UPVC door to balcony. Two radiators. Wood laminate flooring.

Kitchen 2.46m x 2.29m (8'1" x 7'6") Double glazed window to front. Range of wall and base units with work surfaces over. 1.5 stainless steel sink unit with mixer tap. Tiled splash back. Gas cooker point. Extractor to remain. Space for dishwasher. Wood laminate flooring.

Bedroom 3 2.3m x 2.46m (7'7" x 8'1") Double glazed window to front. Radiator. Fitted wardrobes. Carpet. Coved ceiling.

Second Floor Landing Storage cupboard housing hot water tank. Radiator. Carpet.

Bedroom 1 3.28m x 4.72m (10'9" x 15'6") Double glazed window to rear. Double glazed UPVC door to Juliet balcony. Radiator. Built in double wardrobe. Carpet. Coved ceiling.

Bedroom 2 4.2m x 2.46m (13'9" x 8'1") Double glazed window to front. Radiator. Built in wardrobe. Carpet. Access to loft.

Bathroom 1.85m x 2.18m (6'1" x 7'2") Opaque double glazed window to front. Three price suite comprising: Panelled bath with separate taps and shower attachment over, pedestal wash hand basin with mixer tap and low level wc. Radiator. Vinyl flooring. Part tiled walls Coved ceiling.

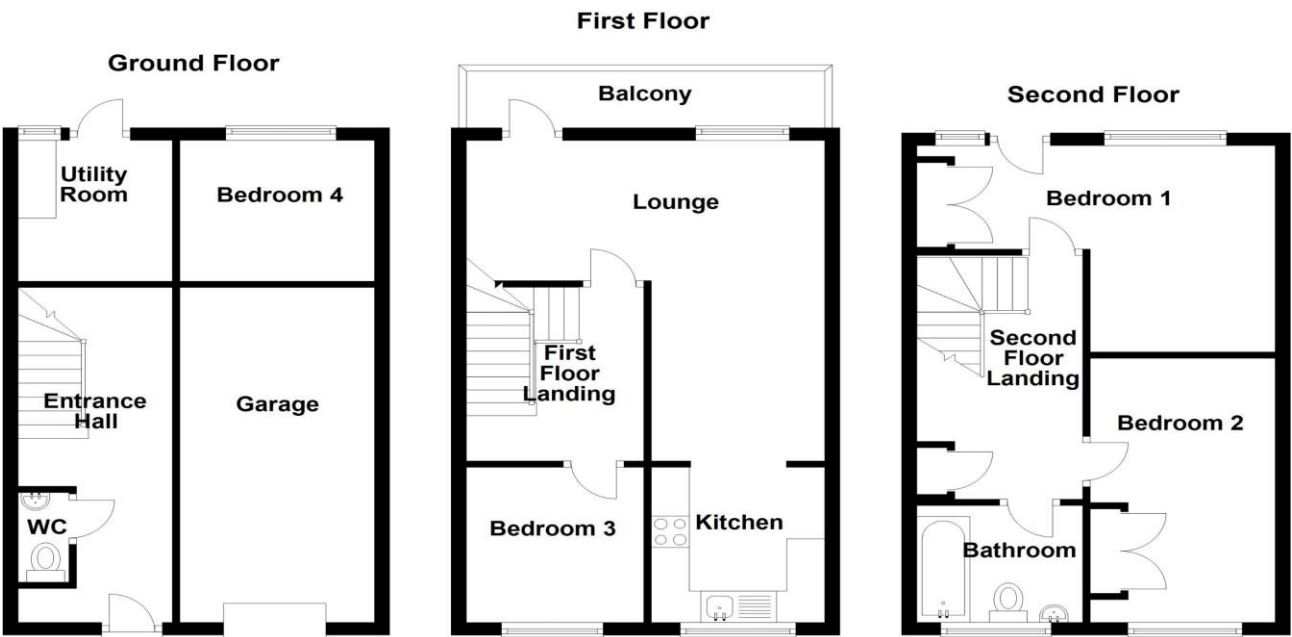



Exterior

- Garden** 4.57m x 2.46m (15' x 8'1") Paved patio area.
- Balcony** 4.01m (13'2") Astroturf.
- Garage** 5.3m x 2.57m (17'5" x 8'5") Up and over door. Power and light.
- Parking** Off street parking to front for 1 vehicle.
- Service Charge:** £31.19 per month (to be verified by Vendors solicitor)

Additional Information

Erith & Northumberland Heath are adjacent neighbourhoods enjoying close proximity to Bexley borough's main thoroughfare, Bexleyheath Broadway. Firmly residential, Northumberland Heath is a quiet enclave with some charming Victorian properties and a small village-like centre.

Erith is a larger town that has undergone rejuvenation in recent years, with a revamped town centre, a waterfront setting (home to London's longest pier) and an ambitious house building programme. Don't miss the annual Erith Riverside Festival.

Property Location

Wharfside Close, DA8 1QR

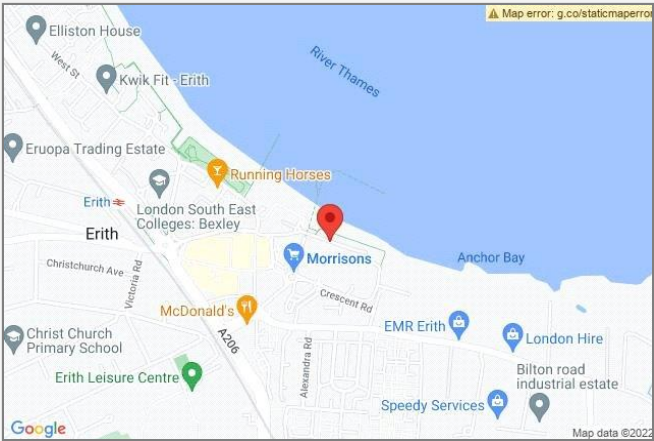

**FOR MORE INFORMATION
CONTACT US TODAY.**

01322 340000
Robinson Jackson
226 Bexley Road,
Northumberland Heath,
Kent DA8 3HB
northheath@robinson-jackson.com



These particulars do not form part of an offer or contract and must not be relied upon as statements or representation of fact. Any areas, measurements, journey times or distances are approximate. The text, images, photographs and plans are for guidance only and are not necessarily comprehensive. It should not be assumed that the property has all necessary planning, building regulation or other consents and we have not tested any services, equipment or facilities. References to tenure are based on information supplied by the seller. Buyer should verify all information themselves by inspection or otherwise prior to a legal commitment to purchase. Photos and images are subject to copyright.