



Saltings Road | Snodland, Kent, ME6 5JB



3



1



1

Asking Price £300,000 to £325,000

Freehold

ROBINSON MICHAEL & JACKSON

Our service will **move** you

Saltings Road, Snodland

Situated in the sought after village of Snodland is this three bedroom semi detached residence. With local amenities within walking distance. Being offered with no forward chain. Call now to view

Property Features

- Council Tax: C
- EPC Rating: D
- No Chain
- Three Bedrooms
- Large Garden
- Great Amenities
- Huge Potential
- Ideal First Time Buy



Interior

Cloakroom

Reception Room 5.3m x 3.35m (17'5" x 11')

Kitchen Breakfast Room 4.01m x 2.97m
(13'2" x 9'9")

Utility Room 3.02m x 1.35m (9'11" x 4'5")

Master Bedroom 3.78m x 3.02m (12'5" x 9'11")

Bedroom Two 3.35m x 2.72m (11' x 8'11")

Bedroom Three 2.51m x 2.4m (8'3" x 7'10")

Shower Room

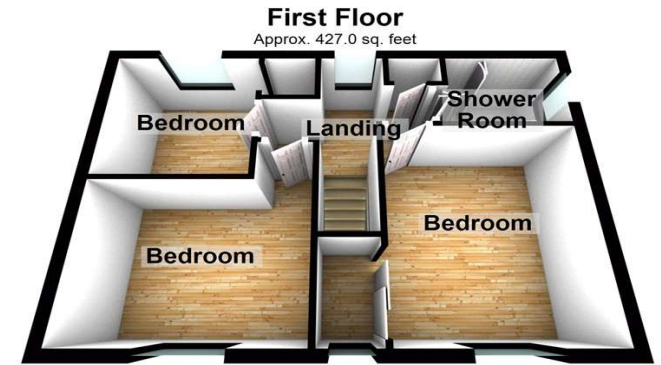

Total area: approx. 854.0 sq. feet

Please be advised this plan is offered for marketing purposes only. It can not be relied upon for exact or precise measurements, angles, window or door openings. Whilst every effort is made to ensure the accuracy the company or provider accepts no responsibility for the content.
Plan produced using PlanUp.





Property Location

Saltings Road, Snodland, Kent, ME6 5JB



Additional Information

Snodland is a town in the borough of Tonbridge and Malling in Kent, England. It lies on the River Medway, between Rochester and Maidstone, and approximately 27 miles from central London. Snodland has a small high street which is within walking distance to the local school which is Holmesdale Technology College. Close Motorways links include A228 and the M20.

**FOR MORE INFORMATION
CONTACT US TODAY.**

01634 722777
Robinson Michael & Jackson
109 High Street
Strood,
Kent ME2 4TJ
strood@robinson-jackson.com

