



Elm Road | Greenhithe, Kent, DA9 9DL



2



2



2

Asking Price £325,000 to £340,000

Freehold

ROBINSON-JACKSON
Our service will *move* you

Elm Road, Greenhithe

Robinson Jackson are delighted to bring to the market this spacious two double bedroom home that benefits from two reception rooms, an en-suite four piece bathroom and ground floor bathroom.

Property Features

- Council Tax: B
- EPC Rating: D
- West Facing Garden
- Two Separate Reception Rooms
- Very Well Maintained By The Current Owners
- 0.6 Miles Walk To Stone Crossing Station
- 0.7 Miles To Bluewater
- 0.6 Miles To Stone Lodge School
- 0.8 Miles To The Brent Primary School



Interior

Entrance Hall: Double glazed entrance door. Radiator. Wood effect flooring. Carpeted stairs to first floor.

Dining Room: Double glazed window to front. Plantation shutters. Radiator. Wood effect flooring. Built In storage unit housing electric meter.

Lounge: Double glazed window to rear. Radiator. Wood effect flooring. Under stairs storage cupboard.

Kitchen: Frosted double glazed door to side. Double glazed window to side. Matching range of wall and base units. Complimentary work-surfaces. Stainless steel one and a half bowl sink unit. Feature radiator. Plumbed for washing machine. Built in dishwasher. Speaker for fridge freezer. Wine fridge. Stainless steel electric oven. Four ring gas hob. Cooker hood. Tiled splashback. Tiled floor.

Ground Floor Bathroom: Frosted double glazed window to rear. Extractor fan. Tiled walls. Tiled floor. Panel bath. Boiler. Stainless

Steel heated towel rail. Low level WC. Vanity wash hand basin. Separate shower over bath.

Landing: Access to loft. Carpet.

Bedroom One: Two double glazed windows to front. Plantation shutters to remain. Radiator. Carpet. Cupboard over stairs used as a wardrobe. Carpet.

Bedroom Two: Double glazed window to rear. Radiator. Carpet. Cupboard over stairs used for wardrobe.

Bathroom: Velux window. Tiled double walk in shower. Low level WC. Freestanding roll top bath. Vanity wash hand basin. Cupboard housing hot water tank. Part tiled walls. Tiled floor. Stainless steel heated towel rail.

Ground Floor
Approx. 42.6 sq. metres (458.0 sq. feet)

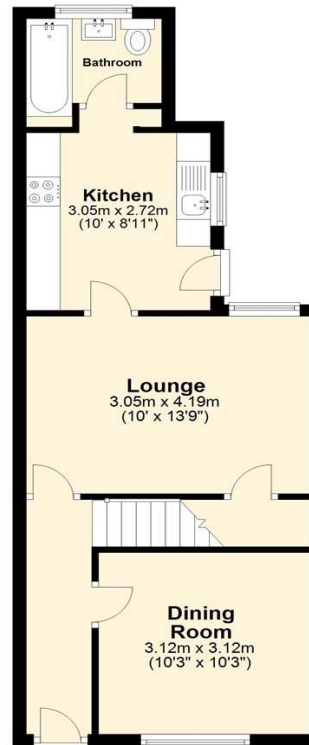

First Floor
Approx. 38.6 sq. metres (415.8 sq. feet)



Total area: approx. 81.2 sq. metres (873.8 sq. feet)





Exterior

Front Garden: Paved.

Rear Garden: Approx 60ft. Patio. Raised decked area. Laid to lawn.

Shed. Rear pedestrian access. Outside tap.

Additional Information

Total floor area: 81 sq. metres

The garden is West facing.

The boiler is located in the ground floor bathroom.

Council Tax - Dartford Band B £1604.24

Property Location

Elm Road, Greenhithe, Kent, DA9 9DL

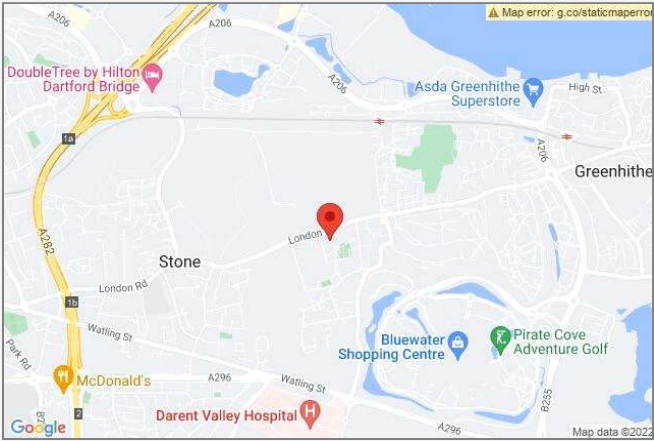

**FOR MORE INFORMATION
CONTACT US TODAY.**

01322 624440

Robinson Jackson
39 High Street,
Swanscombe
Kent,
DA10 0AG

swanscombe@robinson-jackson.com



These particulars do not form part of an offer or contract and must not be relied upon as statements or representation of fact. Any areas, measurements, journey times or distances are approximate. The text, images, photographs and plans are for guidance only and are not necessarily comprehensive. It should not be assumed that the property has all necessary planning, building regulation or other consents and we have not tested any services, equipment or facilities. References to tenure are based on information supplied by the seller. Buyer should verify all information themselves by inspection or otherwise prior to a legal commitment to purchase. Photos and images are subject to copyright.