



Seymour Place
 London
 SE25 4XU
 Leasehold

Spacious ground floor modern purpose built flat offered chain free with two double bedrooms, long lease, double glazing and laminate flooring set within a popular location, well located for Norwood Junction Station and within walking distance local independent shops, eateries and bars and South Norwood country park



- Double glazing
- Central heating
- Laminate flooring
- Ground floor
- Chain free
- Long lease

Council Tax: C
 EPC Rating: D

Guide Price £300,000



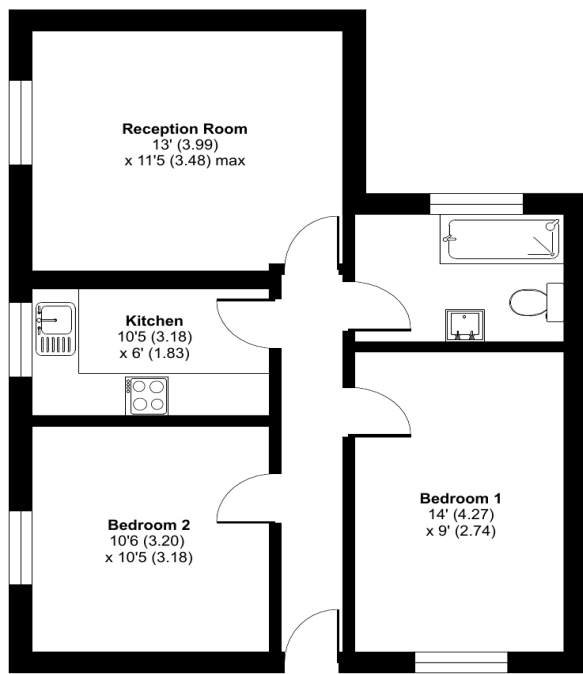

GROUND FLOOR

Approximate Area = 587 sq ft / 54.5 sq m
For identification only - Not to scale



**FOR MORE INFORMATION
CONTACT US TODAY.**

020 8776 6660
Robinson Jackson
256 Kirkdale,
Sydenham,
London SE26 4NL
sydenham@robinson-jackson.com



Floor plan produced in accordance with RICS Property Measurement Standards incorporating International Property Measurement Standards (IPMS2 Residential). © ntechcom 2023.

Interior

Communal Entrance Wooden entrance door, carpet.

Entrance Hall Wooden entrance door, laminate flooring, dado rail.

Lounge Double glazed window to front, radiator, laminate flooring, dado rail.

Kitchen Double glazed window to front, range of fitted wall and base units with work surface over, one bowl stainless steel sink unit with mixer tap, oven, hob and extractor fan to remain, plumbing for washing machine, space for fridge/freezer, tiled flooring, tiled splash back.

Bedroom One Double glazed window to side, radiator, laminate flooring, dado rail.

Bedroom Two Double glazed window to front, radiator, laminate flooring, dado rail.

Bathroom Opaque double glazed window to side, radiator, three piece bathroom suite comprising of: panelled bath with mixer tap and shower attachment, inset wash hand basin with mixer tap and vanity unit under and low level wc, wall mounted boiler, tiled flooring, tiled walls, extractor fan.

Leasehold Information

Time remaining on lease: Approx. 116 years

Ground Rent: £250 Per annum

Service Charge: £900 Per annum

Additional Information

Central heating

Laminate flooring where stated

Ground floor

Chain free

Long lease

Leasehold

Norwood Junction Station

Conveniently located for local independent shops, eateries and bars and South Norwood country park