



Olivine Close | Sittingbourne, Kent, ME10 5NE



2



1



1

Asking Price £260,000 Freehold

ROBINSON MICHAEL & JACKSON

Our service will **move** you

Olivine Close, Sittingbourne

A smartly presented two bedroom property offered to the market with no onward chain, situated in the popular Sonora Fields development.

Property Features

- Council Tax: C
- EPC Rating: C
- Two double bedrooms
- No chain
- Sonora Fields
- Downstairs cloakroom
- First time buyers
- Must be seen



Interior

Entrance Hall

Cloakroom 1.85m x 0.81m (6'1" x 2'8")

Kitchen 3.18m x 1.9m (10'5" x 6'3")

Lounge 4.42m x 3.8m (14'6" x 12'6")

Bedroom One 3.8m x 2.77m (12'6" x 9'1")

Bedroom Two 3.8m x 2.24m (12'6" x 7'4")

Bathroom 1.96m x 1.85m (6'5" x 6'1")

Exterior

Rear garden: Lawn and patio

Ground Floor

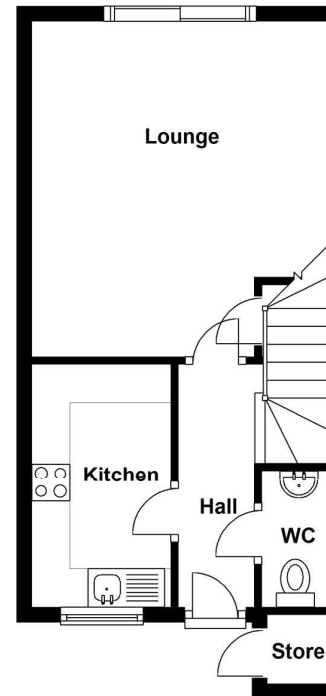

First Floor

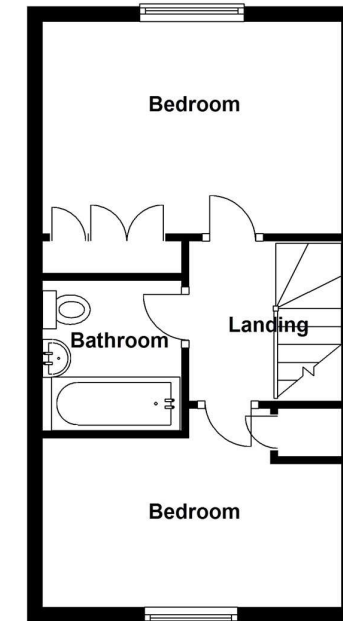

Please be advised this plan is offered for marketing purposes only. It can not be relied upon for exact or precise measurements, angles, window or door openings. Whilst every effort is made to ensure the accuracy the company or provider accepts no responsibility for the content.
Plan produced using PlanUp.



Property Location

Olivine Close, Sittingbourne, Kent, ME10 5NE

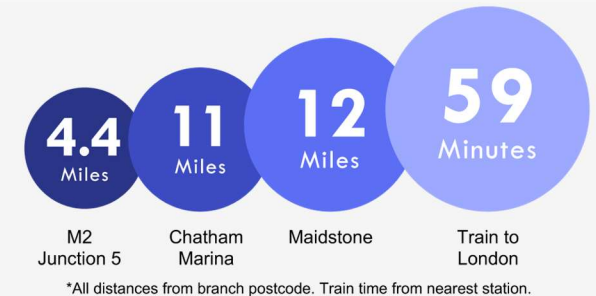

Additional Information

**FOR MORE INFORMATION
CONTACT US TODAY.**

01795 479999
Robinson Michael & Jackson
38 West Street,
Sittingbourne,
Kent ME10 1AP
sittingbourne@robinson-jackson.com

