



Keyes Road | Dartford, Kent, DA1 5EW

 3  1  2 Guide Price £375,000 to £400,000 Freehold

ROBINSON-JACKSON
Our service will *move* you

Keyes Road, Dartford

Robinson Jackson are pleased to offer this three bedroom semi detached family home located ideally for Dartford Mainline Station, Town Centre and popular schools. Benefits include...

Property Features

- Council Tax: C
- EPC Rating: To be confirmed
- No Chain
- Potential to Extend (STPP)
- Two Reception Rooms
- Good access to Amenities
- Ground Floor Wc
- Additional Storage Area
- Ample Private Rear Garden



Interior

Entrance Hall Door to front. Double glazed window to front. Radiator. Carpet.

Lounge 4.11m x 3.94m (13'6" x 12'11") Double glazed window to rear. Feature fireplace. Radiator. Carpet.

Dining Room 3.12m x 3.02m (10'3" x 9'11") Double glazed French doors to rear. Radiator. Carpet.

Kitchen 3.12m x 2.9m (10'3" x 9'6") Double glazed window to front. Wall and base units with complementary worksurfaces over incorporating stainless steel sink drainer. Space for cooker. Plumbed for washing machine. Tiled walls. Vinyl flooring.

Storage room Cupboard housing boiler. Door to ground floor Wc. Carpet.

Landing Loft access. Double glazed window to front. Wall mounted heater. Radiator. Carpet.

Bedroom One 3.94m x 3.53m (12'11" x 11'7") Double glazed window to rear. Carpet.

Bedroom Two 3.56m x 3.12m (11'8" x 10'3") Double glazed window to rear. Fitted wardrobes. Carpet.

Bedroom Three 2.44m x 2.72m (8' x 8'11") Double glazed window to front. Fitted cupboards. Carpet.

Bathroom 2.41m x 1.65m (7'11" x 5'5") Double glazed window to side. Low level Wc. Vanity wash hand basin. Panelled Bath with electric shower over. Tiled walls. Radiator. Carpet.

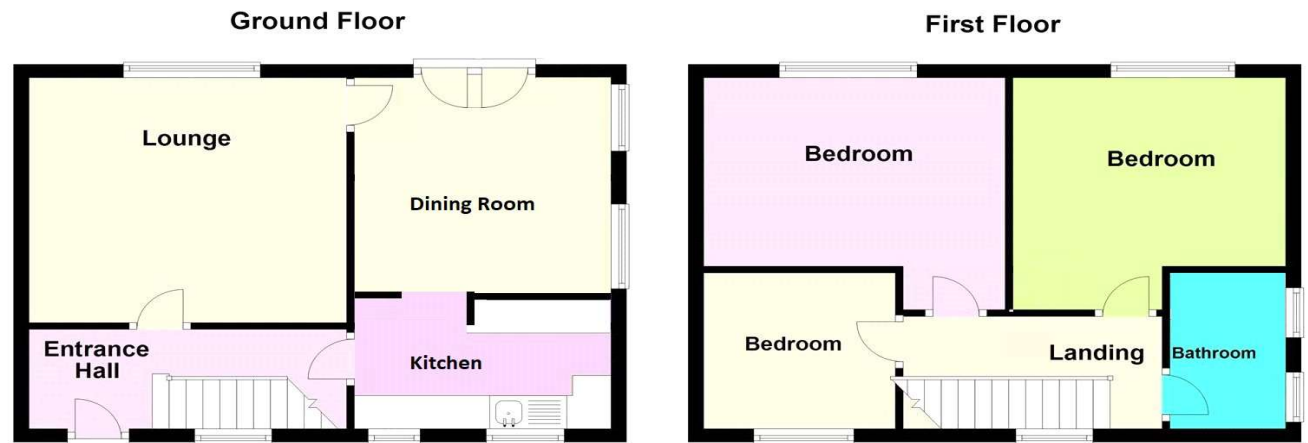

This plan is for general layout guidance and may not be to scale.
Plan produced using PlanUp.





Additional Information

The boiler is located in the storage cupboard.

The property measures: 88 Sqm

Exterior

Front Garden: Laid to lawn

Rear Garden: Approx 60'. Patio. Side gated access. Lawn. Established shrub borders.

Property Location

Keyes Road, Dartford, Kent, DA1 5EW

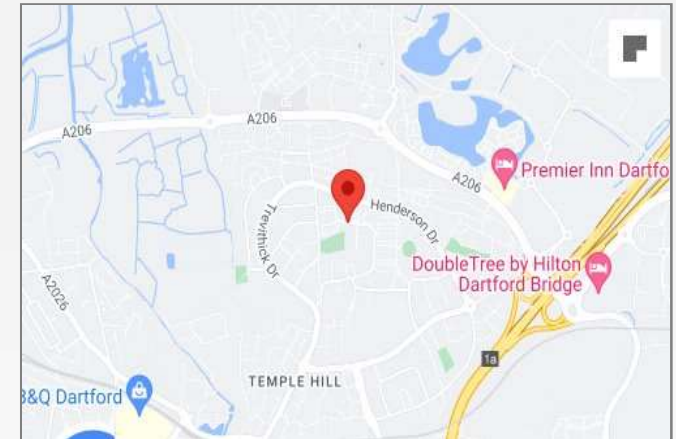

**FOR MORE INFORMATION
CONTACT US TODAY.**

01322 281281
Robinson Jackson
22 Market Street,
Dartford,
Kent DA1 1EZ
dartford@robinson-jackson.com

