



Kent House Road | Beckenham, BR3 1JY

4 1 2

£800,000  
Freehold

**ROBINSON-JACKSON**  
Our service will *move* you

# Kent House Road, Beckenham

1930's semi-detached house offered chain free with four double bedrooms, off street parking, garage, secluded rear garden, double glazing, ample storage, in need of TLC offering fantastic potential set within a popular location, ideal for Beckenham Junction Station, conveniently located for local high street shops and amenities, Alexandra Recreation Ground and Cator Park

## Property Features

- Council Tax: F
- EPC Rating: D
- Four Double Bedrooms
- 1930's Semi-Detached House
- Chain Free
- Freehold
- Off Street Parking
- Garage
- Secluded Rear Garden
- Double Glazing
- Ample Storage
- In Need of TLC
- Fantastic Potential
- Ideal for New Beckenham Station



## Interior

**Lounge** Double glazed window to front, carpet, radiator

**Entrance Hall** Double glazed window to front, wood flooring, radiator

**Dining Room** Double glazed door to garden, carpet

**Kitchen** Double glazed window to rear and side, double glazed door to side, laminate work surface, stainless steel sink, integrated oven and hob, washing machine plumbed for, space for fridge/freezer, laminate flooring

**Master Bedroom** Double glazed to front, built in wardrobe, carpet, radiator

**Bedroom Two** Double glazed window to rear, built in cupboard, carpet, radiator

**Bedroom Three** double glazed window to rear, carpet, radiator

**Bedroom Four** Double glazed window to front, carpet, radiator

**Bathroom** Double glazed window to side, panelled bath, electric shower, wash hand basin with in vanity unit, low flush WC, vinyl flooring

**Garage** To side

**Parking** Driveway

**Garden** To rear, laid to lawn

**Ground Floor WC** Double glazed window to side. low flush WC, wash hand basin

## Exterior

Off street parking

Garage to side

Secluded rear garden mainly laid to lawn

Ground Rent: Not Available

Service Charge: Not Available

Ground Rent Review Date:

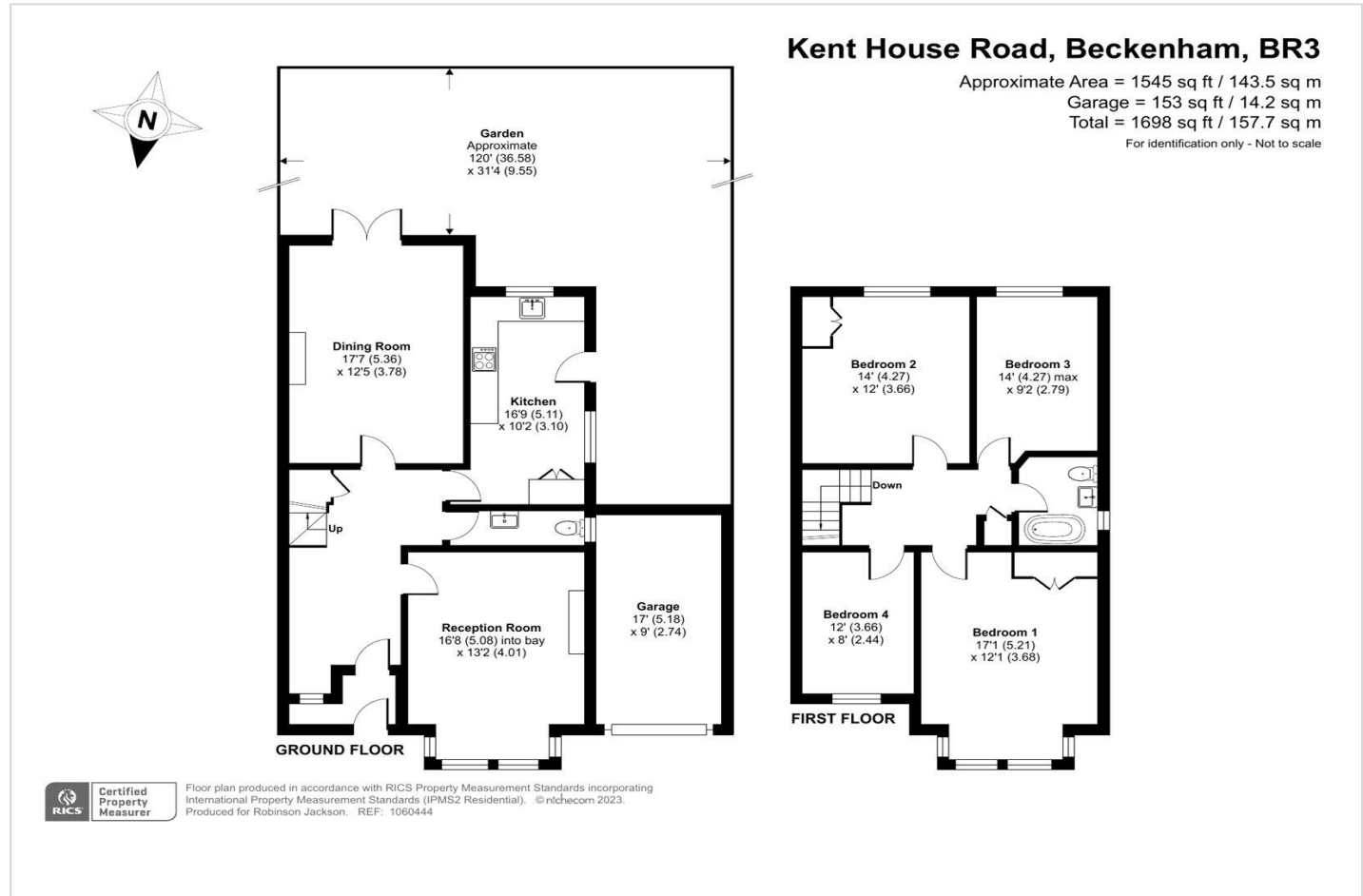



## Property Location

Kent House Road, Beckenham, BR3 1JY

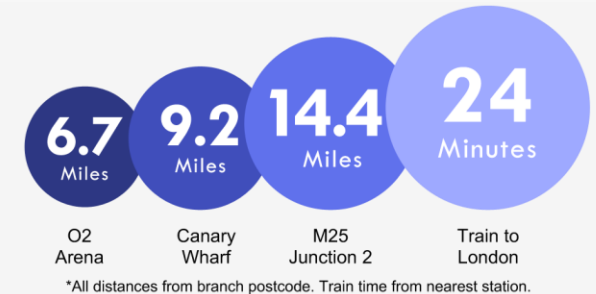
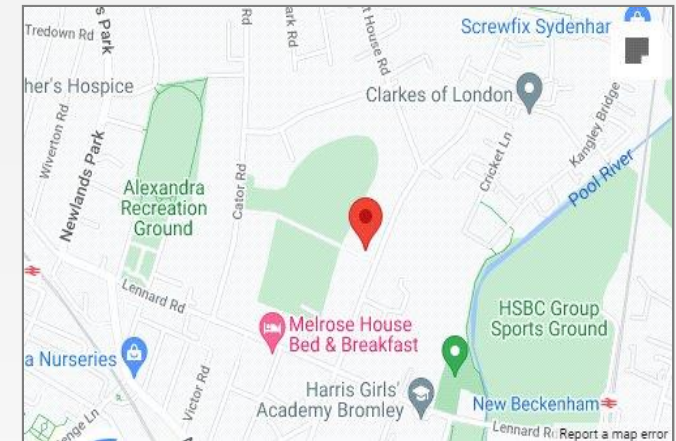

## Additional Information

Double glazing

Central heating

Ample storage

Chain free

Freehold

In need of TLC

Fantastic potential

Ideal for New Beckenham Station

Conveniently located for local high street shops and amenities,  
Alexandra Recreation Ground Cator Park

**FOR MORE INFORMATION  
CONTACT US TODAY.**

020 8776 6660

Robinson Jackson  
256 Kirkdale,  
Sydenham,  
London SE26 4NL

sydenham@robinson-jackson.com



These particulars do not form part of an offer or contract and must not be relied upon as statements or representation of fact. Any areas, measurements, journey times or distances are approximate. The text, images, photographs and plans are for guidance only and are not necessarily comprehensive. It should not be assumed that the property has all necessary planning, building regulation or other consents and we have not tested any services, equipment or facilities. References to tenure are based on information supplied by the seller. Buyer should verify all information themselves by inspection or otherwise prior to a legal commitment to purchase. Photos and images are subject to copyright.