



**ROBINSON
MICHAEL
& JACKSON**
LOCAL OFFICE
01634 263000
FOR SALE

Moor Park Close

Rainham | Gillingham | ME8 8QT



Moor Park Close

Rainham, Gillingham, ME8 8QT

Asking Price £420,000
Freehold

This four bedroom detached is perfect for those seeking a spacious and modern family home. Boasting a large lounge, large kitchen, good-sized bedrooms, and a private garden.

Benefitting from:

- 1306.6 Square Feet
- 0.56 Miles to Rainham Train Station
- Downstairs Cloakroom and Shower
- Study
- Modern Bathroom
- South Facing Garden
- Garage and Driveway
- Close to Schools and Town Centre
- Council Tax: E
- EPC Rating: D



Accommodation

Entrance Double glazed door to front.

Entrance Hall Stairs to first floor. Cupboard. Laminate flooring. Radiator.

Study 2.06m x 2.6m (6'9" x 8'6") Double glazed window to front. Carpet. Radiator.

Lounge Area 6.4m x 3.53m (21' x 11'7") Laminate flooring. Radiator.

Dining Area 3.53m x 2.77m (11'7" x 9'1") Double glazed sliding door to rear. Laminate flooring.

Kitchen/Breakfast Room 6.4m x 3.35m (21' x 11') Double glazed door and window to rear. Range of wall and base units with worksurface over. Fitted hob and double oven. Space for appliances. Wall mounted boiler. Breakfast bar. Vinyl flooring.

Shower Room 2.06m x 1.37m (6'9" x 4'6") Low level WC. Pedestal wash hand basin. Walk in shower cubicle. Radiator. Tiled wall and flooring.

Landing Loft access. Airing cupboard. Carpet.

Bedroom One 3.58m x 3.56m (11'9" x 11'8") Double glazed window to front. Fitted bedroom furniture. Carpet. Radiator.

Bedroom Two 3.58m x 2.5m (11'9" x 8'2") Double glazed window to rear. Carpet. Radiator.

Bedroom Three 2.57m x 2.5m (8'5" x 8'2") Double glazed window to rear. Carpet. Radiator.

Bedroom Four 2.6m x 2.13m (8'6" x 7') Double glazed window to rear. Carpet. Radiator.

Bathroom 2.18m x 1.7m (7'2" x 5'7") Double glazed window to rear. Low level WC. Pedestal wash hand basin. Panelled bath with shower over. Tiled flooring. Heated towel rail. Tiled walls.





Exterior

Rear Garden 11.89m (39') Patio. Side access. Laid to lawn. Shed.

Garage 5.08m x 2.36m (16'8" x 7'9") Up and over door. Electric security door. Light and power.

Driveway Block paved to front.

Additional Information

Rainham and Gillingham lie in the Medway, both being circled by charming semi-rural villages. There are several shopping destinations for residents, including Hempstead Valley Shopping Centre and Gillingham Business Retail Park, as well as an abundance of local pubs and restaurants. Both towns are served by well-respected schools, including Rainham Mark Grammar.

Rainham and Gillingham have oodles of open space and facilities, including Capstone Country Park, Berengrave Nature Reserve, Riverside Country Park, the Planet Ice Skating Rink, the Ski & Snowboard centre and Great Lines Heritage Park





Important Notice

These particulars do not form part of an offer or contract and must not be relied upon as statements or representation of fact. Any areas, measurements, journey times or distances are approximate. The text, images, photographs and plans are for guidance only and are not necessarily comprehensive. It should not be assumed that the property has all necessary planning, building regulation or other consents and we have not tested any services, equipment or facilities. References to tenure are based on information supplied by the seller. Buyer should verify all information themselves by inspection or otherwise prior to a legal commitment to purchase. Photos and images are subject to copyright.



READY TO MOVE?
Scan to instruct us

FOR MORE INFORMATION CONTACT US TODAY.

Lee Franklin - Branch Manager

01634 263000

Robinson Michael & Jackson
17 High Street,
Rainham,
Kent ME8 7HX

rainham@robinson-jackson.com

SALES | MORTGAGES | LEGALS

ROBINSON MICHAEL & JACKSON



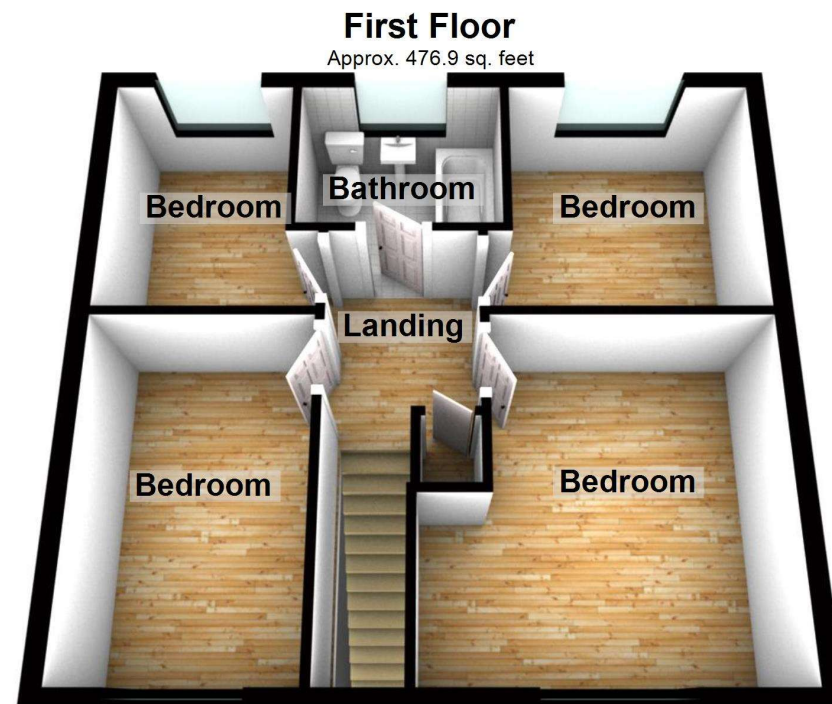
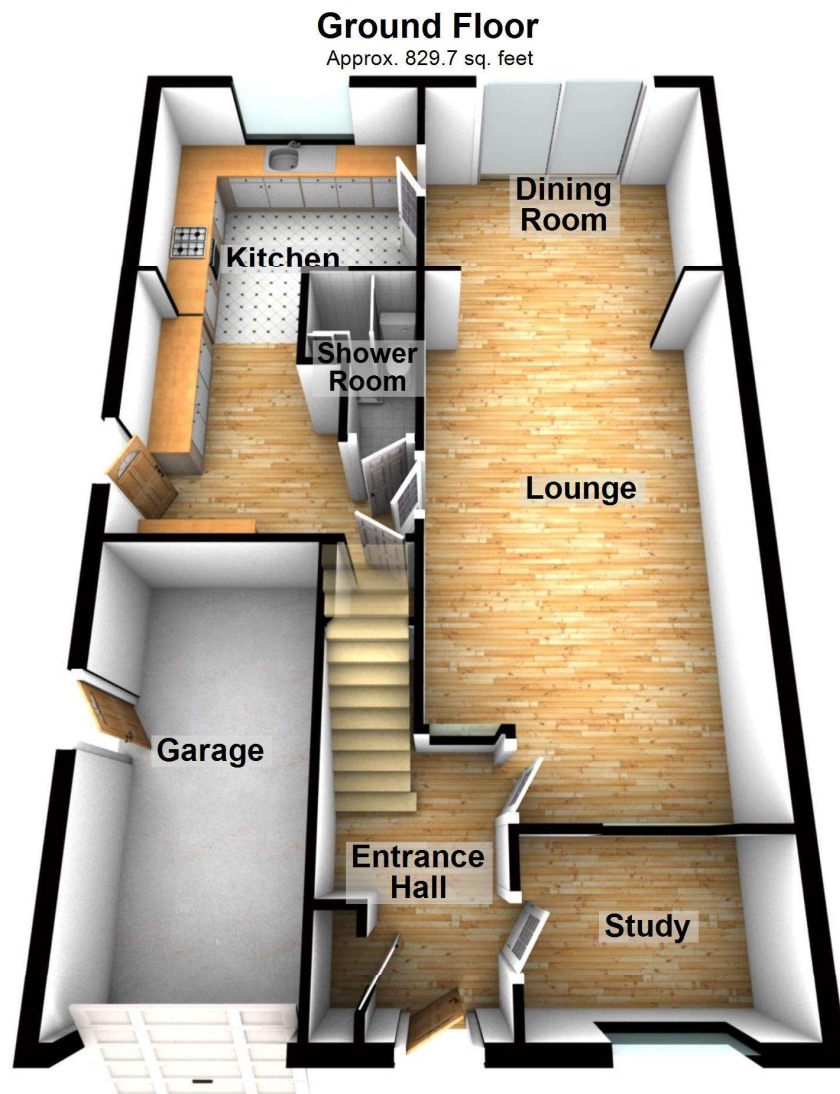

Total area: approx. 1306.6 sq. feet

Please be advised this plan is offered for marketing purposes only. It can not be relied upon for exact or precise measurements, angles, window or door openings. Whilst every effort is made to ensure the accuracy the company or provider accepts no responsibility for the content.
Plan produced using PlanUp.

