



Hither Green Lane | Hither Green, London, SE13 6QA



Asking Price £650,000

Freehold

ROBINSON-JACKSON
Our service will *move* you

Hither Green Lane, Hither Green

Three bedroom mid terrace 1930's house situated within easy walking distance of Hither Green station, some popular coffee shops close by also, driveway parking and large garden, NO ONWARD CHAIN.

Property Features

- Three bedrooms
- Two receptions
- Fitted kitchen
- Garden room
- Upstairs family bathroom
- Private rear garden
- Driveway
- Close to station and local amenities
- Total floor area: 111m²= 1,195ft² (guidance only)



Interior

ENTRANCE HALL: Entrance door stairs to first floor, under stairs storage, access to reception rooms, dining room and kitchen.

RECEPTION ROOM: 4.16m x 3.43m (13'8" x 11'3") Double glazed window to front, fireplace, fully fitted carpet, picture rails, radiator.

DINING ROOM: 3.99m x 3.56m (13'1" x 11'8") French door to garden room, fireplace, fully fitted carpet, radiator, picture rails.

GARDEN ROOM: 3.58m x 2.92m (11'9" x 9'7") Double glazed window and double glazed door to rear and side, double glazed roof, fully fitted carpet.

KITCHEN: 2.97m x 2.34m (9'9" x 7'8") Double glazed window and door to rear, range of wall and base units, space for free standing cooker with extractor hood over., stainless steel sink with mixer tap, plumbed for washing machine, tiled splash back, laminate flooring, wall mounted boiler.

LANDING: Fully fitted carpet, loft hatch, picture rails, access to all bedroom and bathroom.

BEDROOM 1: 3.71m x 3.66m (12'2" x 12') Double glazed window to front, fully fitted carpet, radiator, picture rails.

BEDROOM 2: 3.73m x 3.66m (12'3" x 12') Double glazed window to rear, built in wardrobes, fully fitted carpet, radiator, picture rails.

BEDROOM 3: 2.29m x 2.26m (7'6" x 7'5") Double glazed window to front, fully fitted carpet, radiator, picture rails.

BATHROOM: Double glazed window to rear, panel enclosed bath with shower attachment and glass shower scree, wash hand basin with built in cupboard, low level w.c., heated towel rail, extractor fan, partly tiled walls and tiled floor.

Exterior

GARDEN: Extends to 73'0ft, paved patio area, laid to lawn, various shrubs and plants, garden shed.

DDRIVEWAY: Paved.

Ground Floor

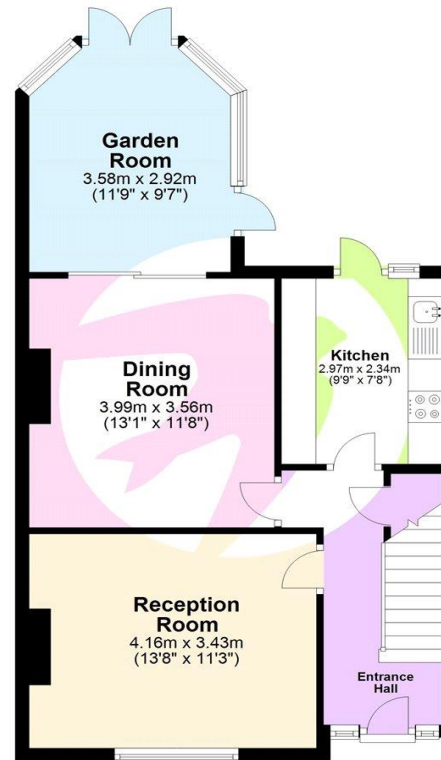

First Floor



This floor plan is for illustrative purposes only. It is not drawn to scale. Measurements are approximate.





Property Location

Hither Green Lane, Hither Green, London, SE13 6QA

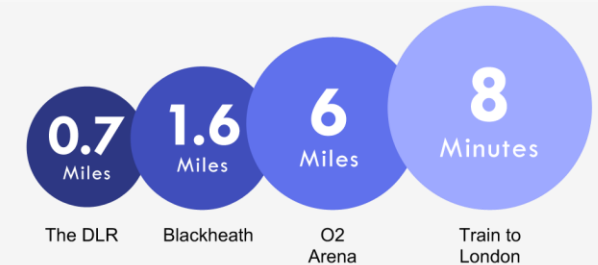
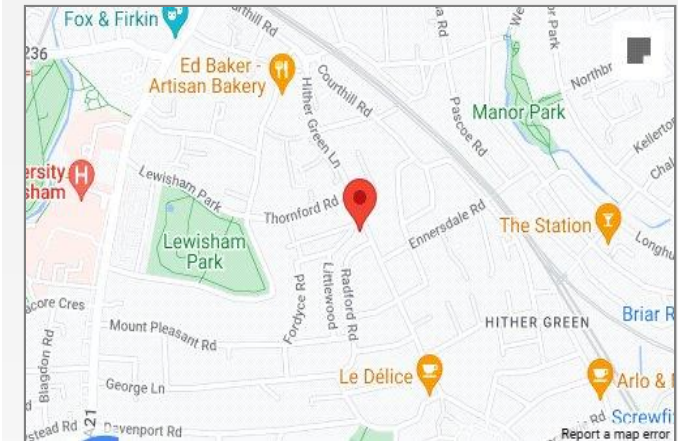

*All distances from branch postcode. Train time from nearest station.

Location

The property is located in the ever-popular leafy Hither Green area famous for its outstanding primary schools and excellent transport links. Served by three main train lines the area is popular with commuters as journeys to Central London take as little as 10 minutes. Access to Canary Wharf/Bank (via the DLR) is available via Lewisham Station, which can be reached by train in 4 minutes. The property is a stone throw away from two superb green areas - Manor House Gardens and Mountsfield Park - one of London's best open spaces and home of the annual People's Day.

Additional Information

Local Authority: London Borough of Lewisham / Council Tax: Band D (£1,926.27 pa) / EPC Rating: C

**FOR MORE INFORMATION
CONTACT US TODAY.**

020 8297 8777

Robinson Jackson
27 Lewis Grove,
Lewisham,
London, SE13 6BG

lewisham@robinson-jackson.com



These particulars do not form part of an offer or contract and must not be relied upon as statements or representation of fact. Any areas, measurements, journey times or distances are approximate. The text, images, photographs and plans are for guidance only and are not necessarily comprehensive. It should not be assumed that the property has all necessary planning, building regulation or other consents and we have not tested any services, equipment or facilities. References to tenure are based on information supplied by the seller. Buyer should verify all information themselves by inspection or otherwise prior to a legal commitment to purchase. Photos and images are subject to copyright.