



Walsingham Road | St Pauls Cray, Kent, BR5 3BN



£185,000 Leasehold

ROBINSON-JACKSON
Our service will *move* you

Walsingham Road

St Pauls Cray

An opportunity to purchase this one bedroom first floor flat situated conveniently for St Mary Cray Station & local shops. The property benefits from a balcony of the lounge and is offered Chain Free.

Property Features

- Central Heating & Double Glazing
- Private Balcony
- Communal Garden
- Approx 90 Year Lease
- Close To Station & Shops
- Chain Free
- Council Tax: B
- EPC Rating: C



Interior

Private Entrance Hall: Storage cupboard. Radiator.

Lounge/Dining Room: 4.24m x 3.63m (13'11" x 11'11")
Double glazed window. Radiator. Double glazed door opening onto:-

Balcony: 2.87m x 1.12m (9'5" x 3'8") Providing some small outside space.

Kitchen: 2.74m x 2.57m (9' x 8'5") Fitted with a range of wall and base units with work surfaces. Integrated oven, gas hob and extractor fan. Space for undercounter fridge and freezer. Space for washing machine. Double glazed window.

Bedroom: 3.05m x 3.02m (10' x 9'11") Double glazed window. Radiator.

Bathroom: Fitted with a three piece suite comprising a panelled bath, pedestal wash hand basin and wc.

Exterior

Communal Gardens:

Ground Floor

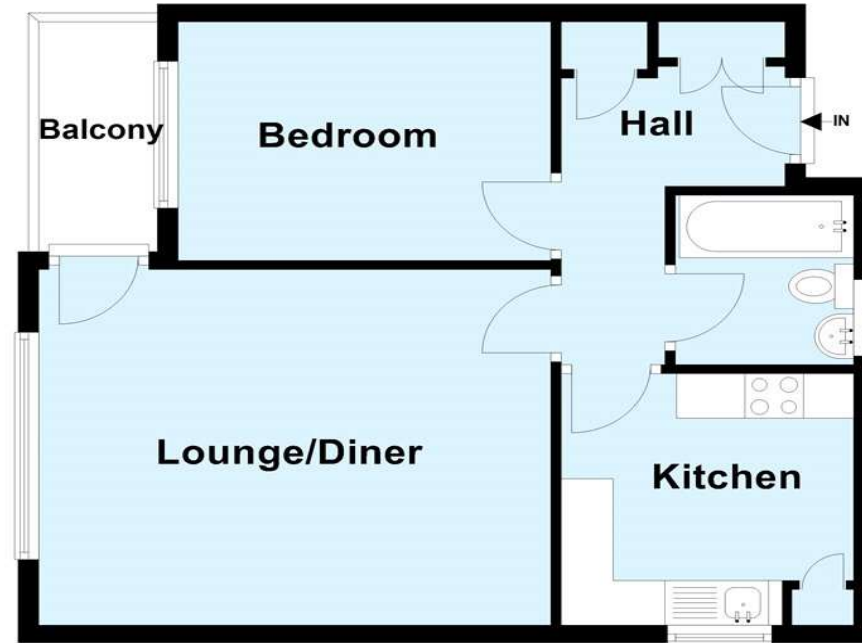

This plan is for general layout guidance and may not be to scale.
Plan produced using PlanUp.





Property Location

Walsingham Road, St Pauls Cray, Kent, BR5 3BN

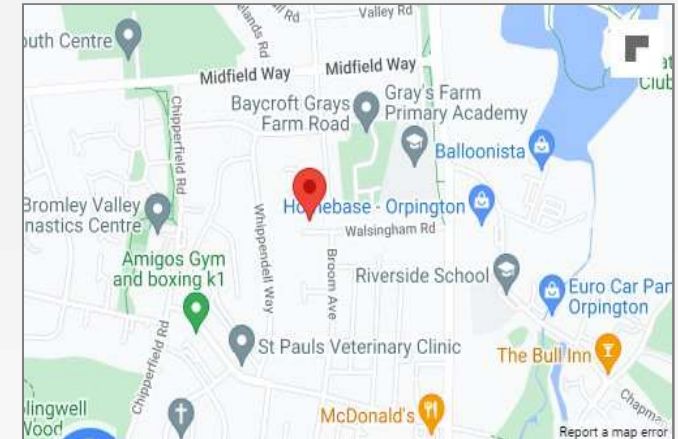

Leasehold Information

Original Lease Term: Tbc

Unexpired Lease: Approx 90 years

Current Ground Rent: Approx £10,000 per annum

Next Ground Rent review date: Tbc

Current Service Charge: Approx £50.00 per month

Please note these charges may be subject to reviews and should be verified by your solicitor.

Additional Information

Walsingham Road is conveniently located for local shops, bus routes, various schools, Nugent Park Shopping Centre and easy access for the A20/M20. The property is also only a short distance from St Mary Cray Station.

**FOR MORE INFORMATION
CONTACT US TODAY.**

01689 833322

Robinson Jackson
292 High Street,
Orpington,
Kent BR6 0NF

orpington@robinson-jackson.com

