



Johnson Close | Northfleet, Gravesend, DA11 8LL



Guide Price £350,000 - £375,000

Freehold

**ROBINSON MICHAEL & JACKSON**

Our service will *move* you

## Johnson Close, Northfleet

Located in a quiet residential cul-de-sac within easy access to schools and amenities is this spacious 3 bedroom semi detached on a corner plot benefitting from both garage and driveway to rear.

### Property Features

- Council Tax: E
- EPC Rating: D
- GUIDE PRICE £350,000 - £375,000
- No Forward Chain
- 2 Reception Rooms
- Utility/Conservatory
- Corner Plot
- Garage and Driveway to Rear
- Cul-De-Sac Location



## Interior

**Entrance Hall:** 2.87m x 1.78m (9'5" x 5'10") Entrance door into hallway. Carpet. Radiator. Door to porch. Stairs to first floor. Doors to:-

**Lounge:** 5.77m x 4.27m (18'11" x 14') Double glazed box window to front. Radiator. Electric heater to rear.

**Dining Room:** 2.44m x 1.85m (8' x 6'1") Double glazed window to side. Double glazed sliding door to rear. Radiator.

**Kitchen:** 5.77m x 4.93m (18'11" x 16'2") Double glazed window to rear. Wall and base units with work surface over. Stainless steel sink and drainer unit with mixer tap over. Tiled backsplash. Space for appliances. Carpet.

**Utility Room** 2.82m x 1.96m (9'3" x 6'5") Double glazed window to rear. Double glazed door to rear. Low level units with work surface over. Space for appliances. Carpet.

**First Floor Landing:** 5.74m x 3.25m (18'10" x 10'8") Double glazed window to side. Radiator. Carpet. Built-in storage cupboard. Loft access. Doors to:-

**Bedroom 1:** 3.3m x 2.54m (10'10" x 8'4") Double glazed window to front and side. Built-in wardrobes. Heater to rear.

**Bedroom 2:** 3.3m x 2.51m (10'10" x 8'3") Double glazed window to front and side. Heater to front. Carpet.

**Bedroom 3:** 3.25m x 3m (10'8" x 9'10") Double glazed window to side and rear. Heater to side. Carpet.

**Bathroom:** 2.4m x 1.47m (7'10" x 4'10") Double glazed frosted window to rear. Suite comprising panelled bath with shower over. Pedestal wash hand basin. Radiator. Tiled walls. Built-in cupboard housing water tank. Carpet.

**Separate W.C.:** 1.52m x 0.81m (5' x 2'8") Double glazed frosted window to rear. Low level w.c. Part tiled walls. Carpet.

## Exterior

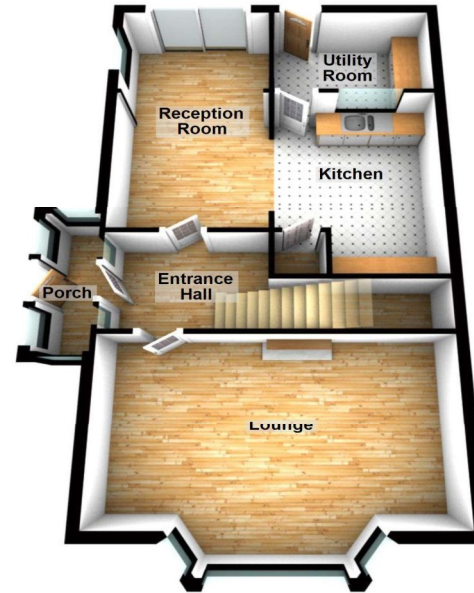
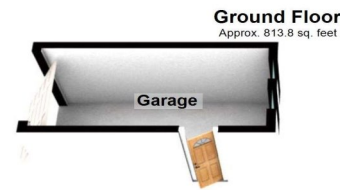

Please be advised this plan is offered for marketing purposes only. It can not be relied upon for exact or precise measurements, angles, window or door openings. Whilst every effort is made to ensure the accuracy the company or provider accepts no responsibility for the content.  
Plan produced using PlanUp.

Rear Garden: Approx. 40ft: Part patio area. Part laid to lawn. Shed to remain. Door to garage. Side pedestrian access.

Garage: To rear





## Property Location

Johnson Close, Northfleet, Gravesend, DA11 8LL

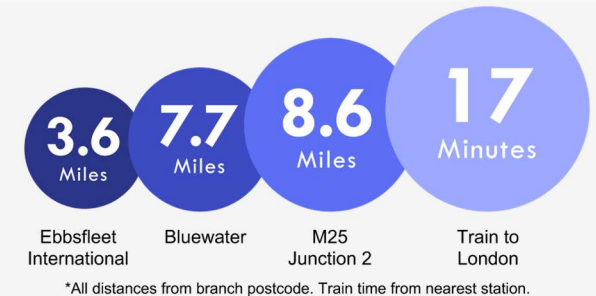

## Additional Information

With families flocking to Northfleet and Gravesend for excellent education, the town has some great facilities to match including:-

Cascades Leisure Centre and the Cygnets Leisure Centre both for swimming, gym, classes and fitness training. There are numerous clubs and team sports throughout Northfleet & Gravesend including Ebbsfleet United Football Club, Gravesend Rugby Club and Gravesend Golf Centre

**FOR MORE INFORMATION  
CONTACT US TODAY.**

01474 333111

Robinson Michael & Jackson  
21A & B King Street,  
Gravesend,  
DA12 2EB

[gravesend@robinson-jackson.com](mailto:gravesend@robinson-jackson.com)



These particulars do not form part of an offer or contract and must not be relied upon as statements or representation of fact. Any areas, measurements, journey times or distances are approximate. The text, images, photographs and plans are for guidance only and are not necessarily comprehensive. It should not be assumed that the property has all necessary planning, building regulation or other consents and we have not tested any services, equipment or facilities. References to tenure are based on information supplied by the seller. Buyer should verify all information themselves by inspection or otherwise prior to a legal commitment to purchase. Photos and images are subject to copyright.