



Farley Road London SE6 2AA

Share of Freehold



Robinson-Jackson are delighted to act as sole selling agents for this two bedroom first floor period conversion flat. Situated close to Catford town centre, the property is in close proximity to Catford/Catford Bridge stations, Mountsfield Park, popular with dog walkers and runners, with access to two tennis courts, two full sized football pitches, a play park and an in park cafe, and walking distance to Ladywell and Hither Green stations. The property benefits from being a share of freehold, being on the first floor, has a large family lounge, two bedrooms, separate kitchen and bathroom. The property is offered chain free and for the attractive price of £320,000. Please call Robinson-Jackson Catford to arrange your viewing on 0208 698 1234.

Asking Price £320,000

- Two Bedrooms
- First Floor
- Period Property
- Share of Freehold
- Close to Catford Town Centre
- No Onward Chain

Council Tax: C
EPC Rating: TBC

ROBINSON-JACKSON
Our service will *move* you

First Floor

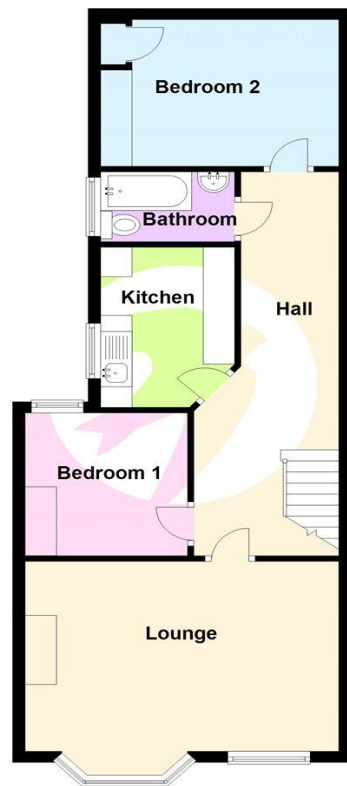

This floor plan is for illustrative purposes only. It is not drawn to scale. Measurements are approximate.
Plan produced using PlanUp.

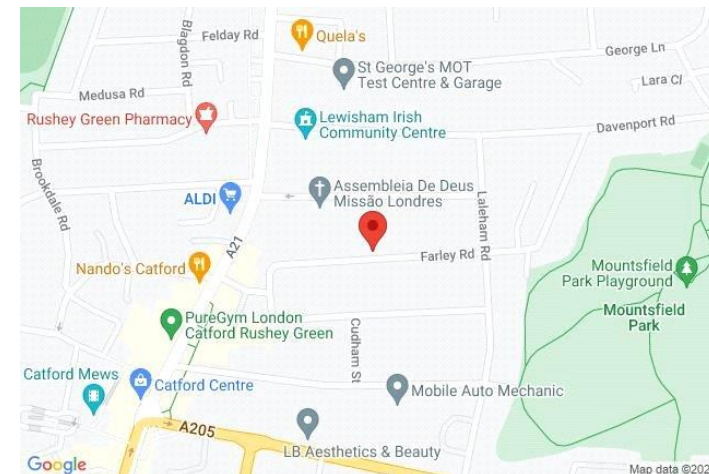

FOR MORE INFORMATION
CONTACT US TODAY.

020 8698 1234
Robinson Jackson
87 Rushey Green,
Catford
SE6 4AF
jamie.nicol@robinson-jackson.com



Interior

Lounge 4.22 (13'10")m into bay x 4.98 (16'4")m Double glazed bay window to front, double glazed window to front, double panel radiator, fitted carpet.

Kitchen 2.03m x 2.77m (6'8" x 9'1") Double glazed opaque window to side, range of wall and base units with work surface over, sink with mixer tap, wall mounted combi boiler, part tiled walls, vinyl floor cover.

Landing Loft hatch, storage cupboard, cupboard housing electric metre and fuse box double panel radiator.

Bedroom 1 3.23m x 3.56m (10'7" x 11'8") Double glazed window to rear, fitted wardrobe, fitted carpet.

Bedroom 2 2.72m x 2.6m (8'11" x 8'6") Double glazed window to rear, storage cupboard, double panel radiator, fitted carpet.

Bathroom Double glazed opaque window to side, double panel radiator, low level w.c., wash hand basin, panel enclosed bath with mixer tap, part tiled walls, vinyl floor cover.

Location

Catford is growing in popularity among commuters as journeys from its two mainline stations can take as little as 10 minutes to Central London.

The Broadway Theatre is an impressive Art Deco building, with a regular programme of shows and events. Catford's other premium attraction is Mountsfield Park – one of London's best open spaces and home of the annual People's Day. Catford's Black Cat sculpture remains a well-loved landmark.

Share of Freehold Information

Time remaining on lease: TBC*

Ground Rent: TBC*

Service Charge: TBC*

*(To be verified by vendor's solicitor)

Additional Information

Local Authority: London Borough of Lewisham

Council Tax: Band C (£1,712 pa)