



Belmont Road | Sittingbourne, Kent, ME10 1EF



Guide Price £260,000 to £280,000

Freehold

ROBINSON MICHAEL & JACKSON

Our service will *move* you

Belmont Road, Sittingbourne

Robinson Michael and Jackson are pleased to offer with no onward chain this two bedroom, two bathroom terraced property located on a popular road a short walk from Sittingbourne town Centre and station.

Accommodation comprises of an entrance hall which gives access to the open plan living/dining room. Beyond this is the kitchen, utility room and bathroom with separate cloakroom.

Upstairs there are two large double bedrooms and the family bathroom.

Externally there is a great size rear garden made up of patio and lawn with summer house.



Property Features

- Council Tax: C
- EPC Rating: D
- Two bedrooms
- Two bathrooms
- Downstairs cloakroom
- No chain
- In need of modernisation
- Close to town

Interior

Entrance Hall: 7.72m x 0.84m (25'4" x 2'9")

GF Cloakroom: 1.63m x 0.84m (5'4" x 2'9")

Lounge: 7.72m x 3.7m (25'4" x 12'2")

Kitchen: 3.12m x 3.15m (10'3" x 10'4")

Utility Room: 3.18m x 1.45m (10'5" x 4'9")

GF Bathroom: 2.67m x 2.95m (8'9" x 9'8")

Bedroom 1: 4.7m x 3.28m (15'5" x 10'9")

Bedroom 2: 3.76m x 3.35m (12'4" x 11')

Bathroom: 3.1m x 3.25m (10'2" x 10'8")

Exterior

Front:

Courtyard

Rear:

Patio

Lawn

Summer house

Mature shrubs

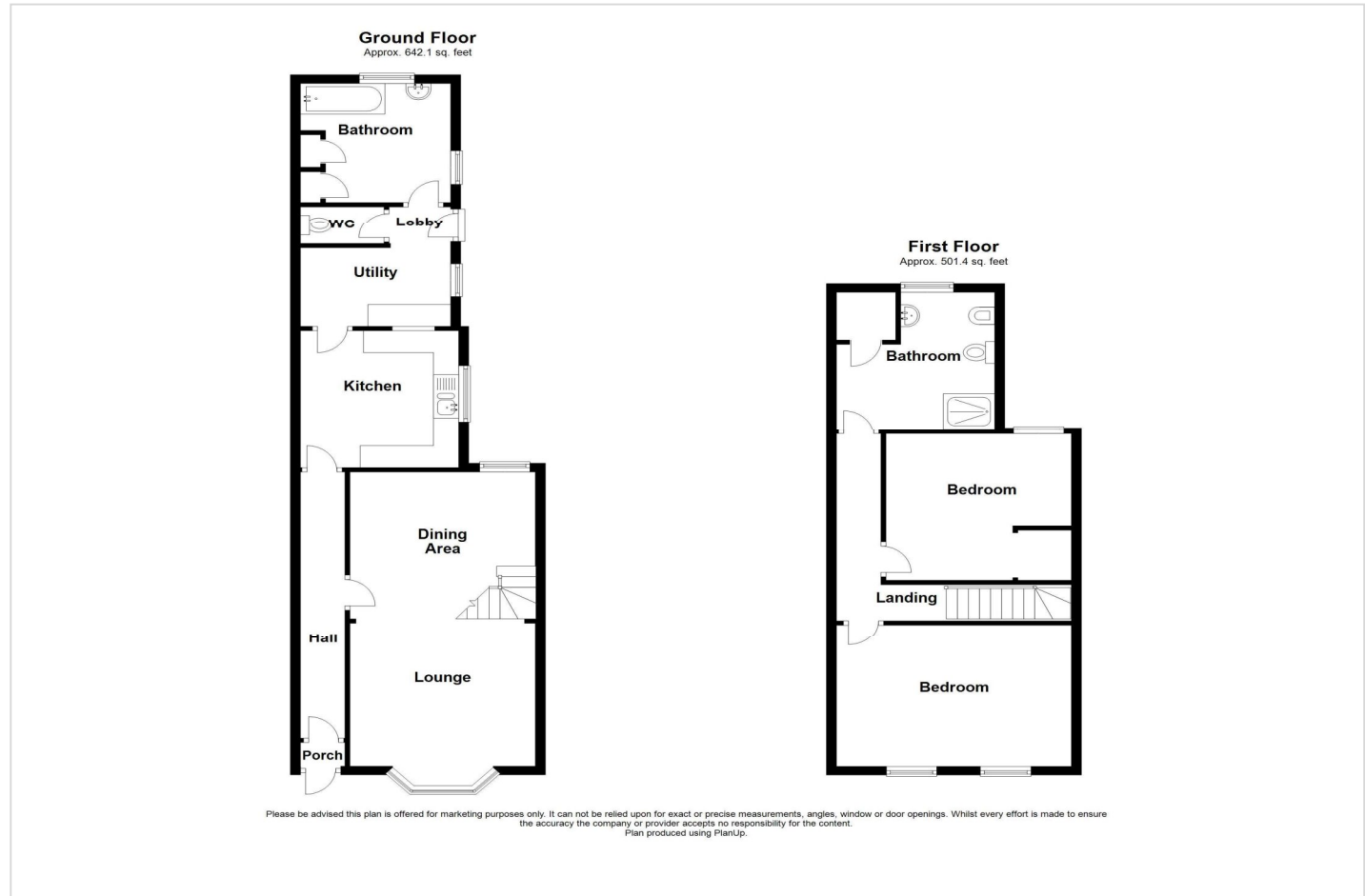



Property Location

Belmont Road, Sittingbourne, Kent, ME10 1EF



FOR MORE INFORMATION CONTACT US TODAY.

01795 479999
Robinson Michael & Jackson
38 West Street,
Sittingbourne,
Kent, ME10 1AP
sittingbourne@robinson-jackson.com



These particulars do not form part of an offer or contract and must not be relied upon as statements or representation of fact. Any areas, measurements, journey times or distances are approximate. The text, images, photographs and plans are for guidance only and are not necessarily comprehensive. It should not be assumed that the property has all necessary planning, building regulation or other consents and we have not tested any services, equipment or facilities. References to tenure are based on information supplied by the seller. Buyer should verify all information themselves by inspection or otherwise prior to a legal commitment to purchase. Photos and images are subject to copyright.