



The Boulevard | Greenhithe, Kent, DA9 9GT

 2  2  1

Guide Price: £325,000 to £350,000

Leasehold

ROBINSON-JACKSON
Our service will *move* you

The Boulevard, Greenhithe

Robinson Jackson are delighted to offer this beautiful CHAIN FREE apartment nestled in the heart of the prestigious Ingress Park development. This exquisite 2 double bedroom ground floor apartment offers a lifestyle of luxury, sophistication, and unparalleled serenity. With a substantial open-plan living space and generous balcony that provides river views, this residence is the epitome of modern living.

The apartment has been recently modernised with new carpets throughout and has been freshly decorated ready to move straight into.

The generously proportioned open plan living area is perfect for entertaining and relaxation. Flooded with natural light, it offers ample space for a dining area, a comfortable lounge, and a well equipped kitchen with island.

Other features include secure entry, two double bedrooms; one with ensuite shower room as well as a separate bathroom and private allocated underground parking.

This is truly a MUST SEE home and internal viewing is essential to fully appreciate everything this property has to offer. Please contact Robinson-Jackson today to book your viewing.

Property Features

- Prestigious Location on Ingress Park
- Ground Floor
- Generous Open Plan Living
- Large Balcony
- Chain Free
- Private Underground Parking
- Newly Refurbished



Interior

Entrance Hall: Telephone entry system. Two storage cupboards (one housing boiler).

Open plan living: 11.05m x 6.12m (36'3" x 20'1") Lounge area: Three double glazed windows to front. Double glazed doors leading to balcony. Two radiators. Carpet.

Kitchen area: Range of matching wall and base units with complimentary work surface over. Island with base units and breakfast bar overhang. Stainless steel sink with drainer. Integrated electric oven, gas hob and extractor. Integrated fridge freezer. Space for washing machine. Laminate flooring.

Bedroom One: 5.23m x 3.84m (17'2" x 12'7") Two double glazed windows to rear. Two built in wardrobes. Two radiators. Carpet.

Ensuite: Low level WC. Wash hand basin. Shower cubicle. Radiator. Part tiled walls. Tiled flooring.

Bedroom Two: 5.23m x 2.92m (17'2" x 9'7") Two double glazed windows to rear. Two radiators. Carpet.

Bathroom: Frosted double glazed window to side. Low level WC. Pedestal wash hand basin. Panelled bath with mixer taps. Radiator. Part tiled walls. Tiled flooring.

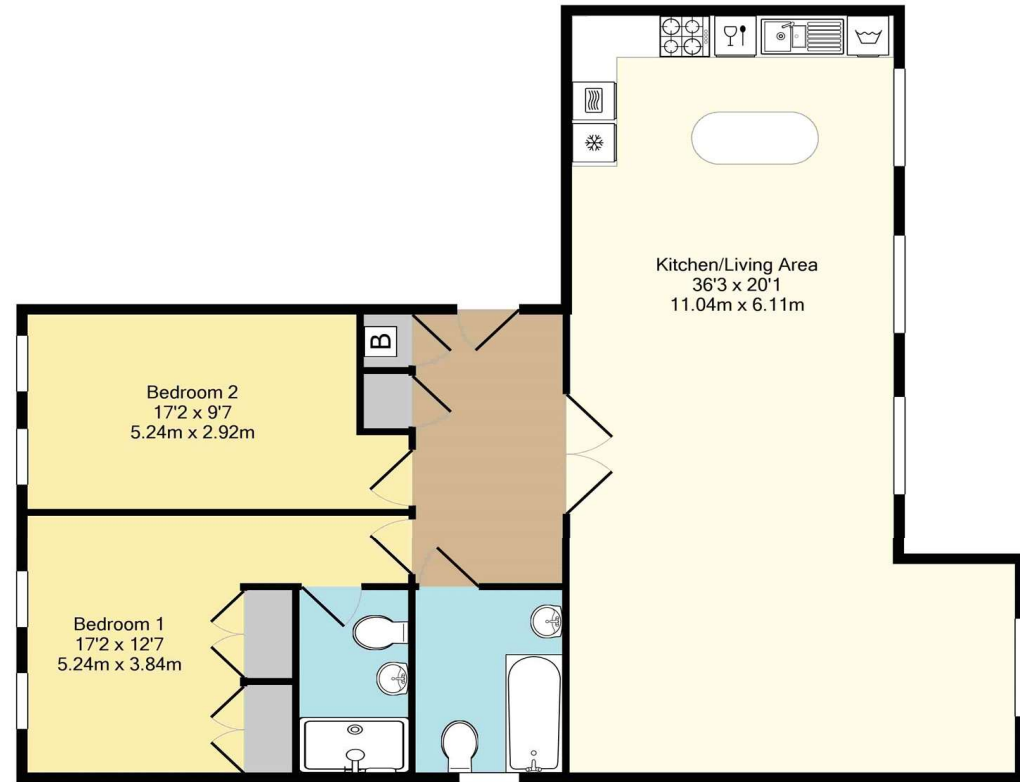

Exterior

Allocated parking bay in residents' carpark





Property Location

The Boulevard, Greenhithe, Kent, DA9 9GT

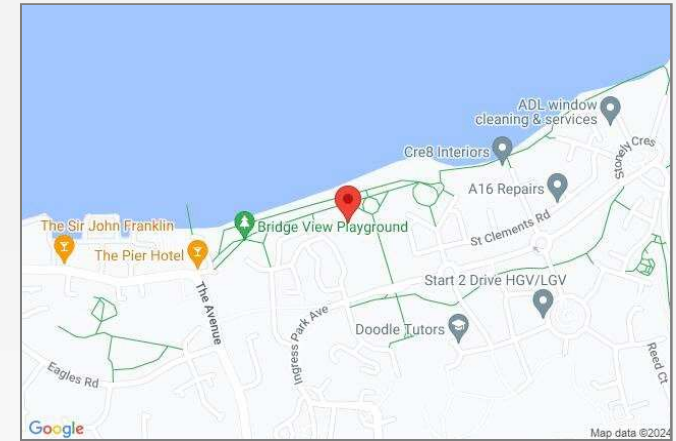

Additional Information

Dartford Borough Council - Tax Band E

Total floor area: 107 sq. metres

Leasehold Information

Lease created in 2000

Remaining term on lease: 975 years (2024)

Current annual ground rent: £352pa

Current annual service charge: £4,500pa

(All information regarding lease term and service charges have been provided by the seller and should be verified by your solicitor).

FOR MORE INFORMATION
CONTACT US TODAY.

01322 624440

Robinson Jackson
39 High Street,
Swanscombe
Kent,
DA10 0AG

swanscombe@robinson-jackson.com

