



Croydon Close | Lordswood, Kent, ME5 8RS



Offers in excess of £280,000 Freehold

ROBINSON MICHAEL & JACKSON

Our service will *move* you

Croydon Close, Lordswood

A well presented extended two bedroom house with a drive to the front. Must be viewed to fully appreciate all it offers.

Property Features

- Council Tax: B
- EPC Rating: D
- Two bedroom mid-terrace
- Off road parking
- Extended to rear
- Ideal first time buy
- Well-presented throughout
- Low maintenance rear garden



Interior

Ground Floor

Lounge 4.32m x 3.58m (14'2" x 11'9")

Kitchen 3.58m x 3.33m (11'9" x 10'11")

Reception Room 3.23m x 3.02m (10'7" x 9'11")

First Floor

Bedroom One 3.6m x 3.35m (11'10" x 11')

Bedroom Two 3.38m x 1.9m (11'1" x 6'3")

Bathroom 2.34m x 1.55m (7'8" x 5'1")

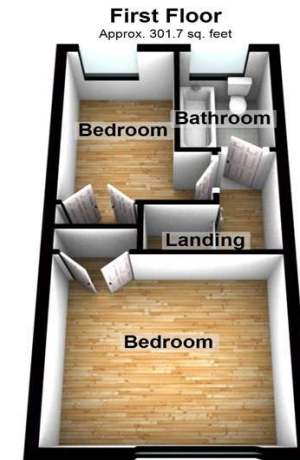
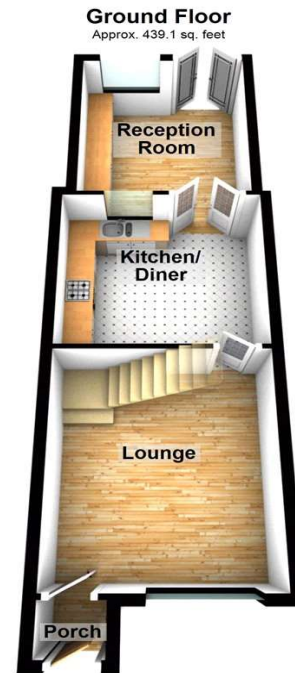

Please be advised this plan is offered for marketing purposes only. It can not be relied upon for exact or precise measurements, angles, window or door openings. Whilst every effort is made to ensure the accuracy the company or provider accepts no responsibility for the content. Plan produced using PlanUp.

Exterior

Off road parking

Enclosed rear garden





Property Location

Croydon Close, Lordswood, Kent, ME5 8RS

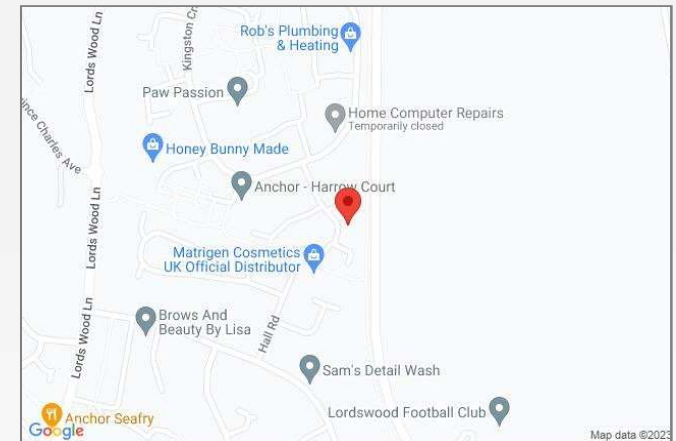

*All distances from the ME5 8EH postcode. Train time from Maidstone East station.

**FOR MORE INFORMATION
CONTACT US TODAY.**

01634 868000

Robinson Michael & Jackson
381 Walderslade Road,
Walderslade,
Kent ME5 9LL

walderslade@robinson-jackson.com



These particulars do not form part of an offer or contract and must not be relied upon as statements or representation of fact. Any areas, measurements, journey times or distances are approximate. The text, images, photographs and plans are for guidance only and are not necessarily comprehensive. It should not be assumed that the property has all necessary planning, building regulation or other consents and we have not tested any services, equipment or facilities. References to tenure are based on information supplied by the seller. Buyer should verify all information themselves by inspection or otherwise prior to a legal commitment to purchase. Photos and images are subject to copyright.