



Harmer Street | Gravesend, Kent, DA12 2AP



Offers in excess of £170,000 Share of Freehold

ROBINSON MICHAEL & JACKSON
Our service will *move* you

Harmer Street, Gravesend

This two-bedroom top floor flat is situated in the heart of Gravesend Town Centre and has been recently refurbished to high standard throughout. Offered with 20% share of freehold and no forward chain.

Property Features

- Council Tax:
- EPC Rating: E
- 13'8 x 13'5 Lounge
- New Kitchen
- New Bathroom
- Sash Windows
- Electric Radiators
- Share of Freehold
- Vacant Possession



Interior

Entrance Hall Entrance door. Laminate wood flooring. Door to inner hall with laminate wood flooring. Picture rail.

Lounge 4.17m x 4.1m (13'8" x 13'5") Two sash windows to front. Carpet. Electric radiator. Picture rail. Storage cupboard,

Kitchen 3.5m x 2.03m (11'6" x 6'8") Sash window to rear. Newly modern fitted wall and base units. Roll topped work surfaces. Tiled splashbacks. Single drainer sink unit. Mixer tap. Laminate wood flooring.

Bedroom 1 4.3m x 4.1m (14'1" x 13'5") Two sash windows to front. Carpet. Electric radiator. Two built in storage cupboards.

Bedroom 2 2.64m x 2.36m (8'8" x 7'9") Sash window to rear. Laminate wood flooring. Electric radiator.

Bathroom 2 (6'7") m x 1.78 (5'10") m plus door recess Sash window to rear. Newly installed white suite comprising tiled panelled bath, pedestal wash hand basin. low level w.c. Vinyl flooring.

Share of Freehold Information

Ground Rent: Not Available

Service Charge: Not Available

Ground Rent Review Date:

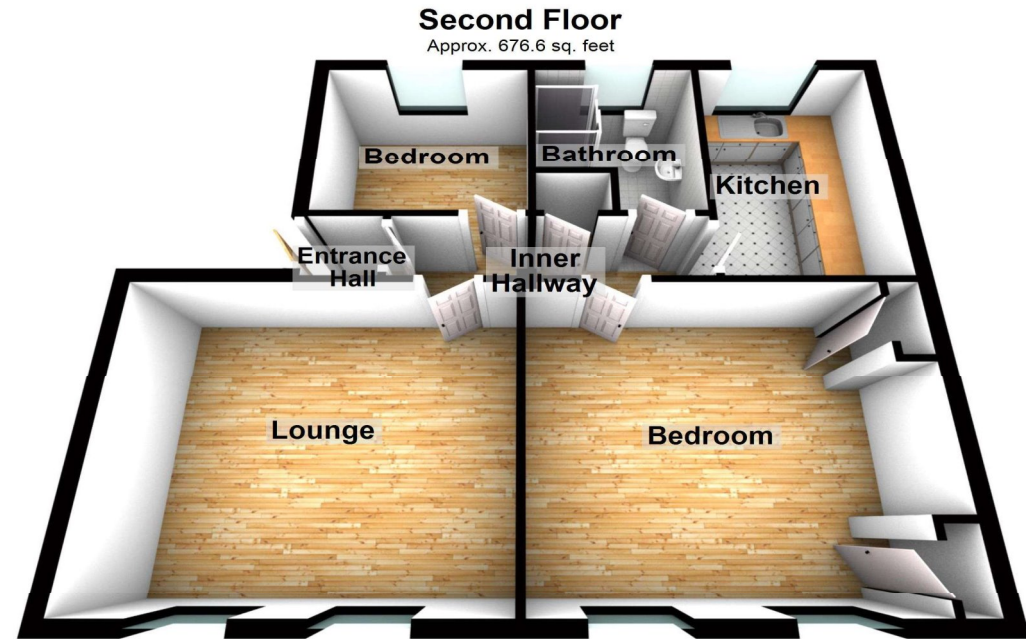

Total area: approx. 676.6 sq. feet

Please be advised this plan is offered for marketing purposes only. It can not be relied upon for exact or precise measurements, angles, window or door openings. Whilst every effort is made to ensure the accuracy the company or provider accepts no responsibility for the content.
Plan produced using PlanUp.





Property Location

Harmer Street, Gravesend, Kent, DA12 2AP

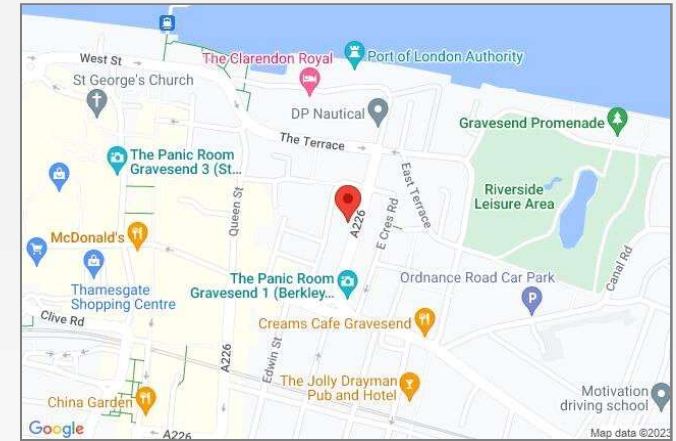

Additional Information

This property is a stone's throw away from the town centre, ideal for the local shops, restaurants and amenities. For commuters, the high-speed service from Gravesend station gets into London within 23 minutes, allowing you more social time with the family.

**FOR MORE INFORMATION
CONTACT US TODAY.**

01474 333111
Robinson Michael & Jackson
21 King Street,
Gravesend,
Kent DA12 2EB
gravesend@robinson-jackson.com