



# Highview Drive

Chatham | Kent | ME5 9UJ



# Highview Drive

Chatham, Kent, ME5 9UJ

Offers In Excess of  
£390,000  
Freehold

A spacious four bedroom family home in a popular location with garage and drive and a large rear garden. Offered to the market with no onward chain.

## Benefitting from:

- In need of updating
- 4 bedroom semi detached house
- Garage and drive way
- Large rear garden
- Popular location
- No chain
- Council Tax: C
- EPC Rating: D



## Accommodation

### Ground floor

#### Entrance Hall

**Living Room** 4.62m x 3.86m (15'2" x 12'8")

**Dining Room** 3.7m x 3.3m (12'2" x 10'10")

**Kitchen** 2.8m x 2.4m (9'2" x 7'10")

#### WC

**Conservatory** 2.9m x 1.83m (9'6" x 6')

### First Floor

**Bedroom 1** 4.6m x 3.45m (15'1" x 11'4")

**Bedroom 2** 3.7m x 3.02m (12'2" x 9'11")

**Bedroom 3** 2.44m x 2.36m (8' x 7'9")

**Bedroom 4** 2.41m x 2.4m (7'11" x 7'10")

**Shower Room** 1.93m x 1.75m (6'4" x 5'9")

#### Separate WC

**Garage** 5.38m x 2.18m (17'8" x 7'2")



## Exterior

Flat rear garden

Side access

Patio area

Secure fencing





Council Tax - C  
EPC Rating - D



## Important Notice

These particulars do not form part of an offer or contract and must not be relied upon as statements or representation of fact. Any areas, measurements, journey times or distances are approximate. The text, images, photographs and plans are for guidance only and are not necessarily comprehensive. It should not be assumed that the property has all necessary planning, building regulation or other consents and we have not tested any services, equipment or facilities. References to tenure are based on information supplied by the seller. Buyer should verify all information themselves by inspection or otherwise prior to a legal commitment to purchase. Photos and images are subject to copyright.

## Location



(All distances & times are approximates)

## FOR MORE INFORMATION CONTACT US TODAY.

Kendell Laretive - Assistant Manager

01634 868000

Robinson Michael & Jackson  
381 Walderslade Road,  
Walderslade,  
Kent ME5 9LL

[walderslade@robinson-jackson.com](mailto:walderslade@robinson-jackson.com)

SALES | MORTGAGES | LEGALS

**ROBINSON MICHAEL & JACKSON**

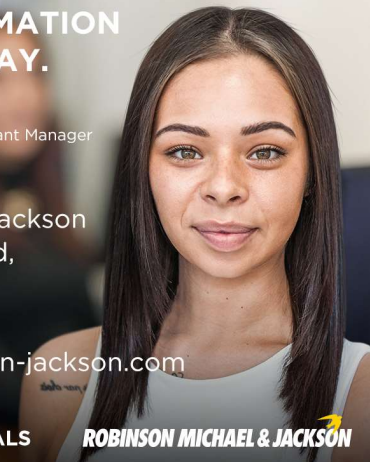

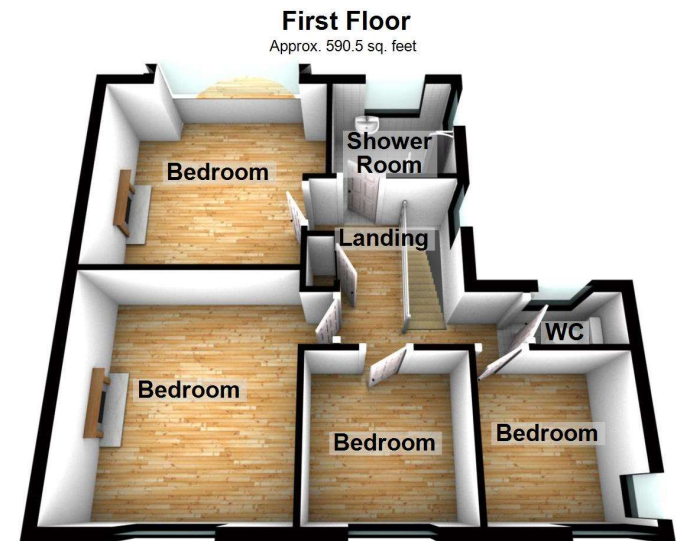
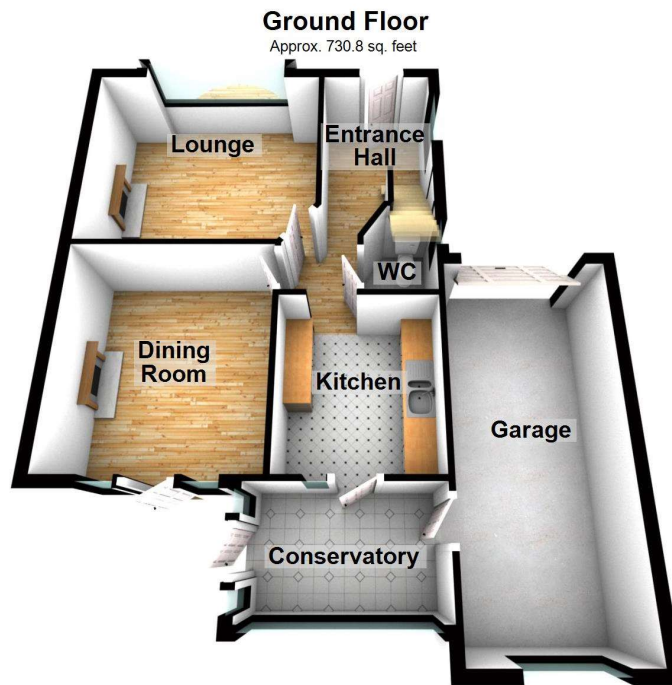
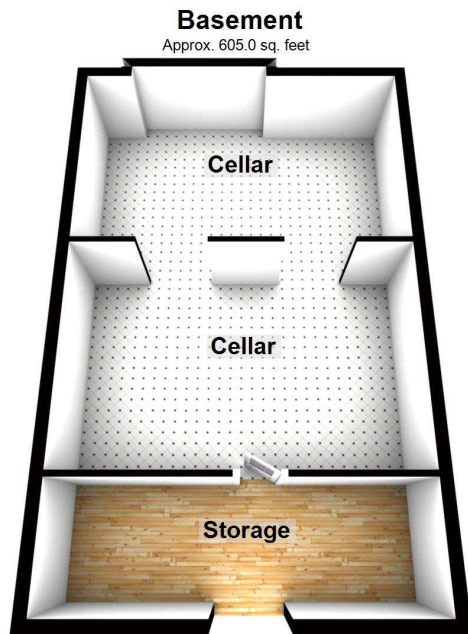

Total area: approx. 1926.3 sq. feet

Please be advised this plan is offered for marketing purposes only. It can not be relied upon for exact or precise measurements, angles, window or door openings. Whilst every effort is made to ensure the accuracy the company or provider accepts no responsibility for the content.  
Plan produced using PlanUp.

