



Plains Avenue | Maidstone, Kent, ME15 7AU



Guide Price £375,000 - £400,000

Freehold

**ROBINSON MICHAEL & JACKSON**  
Our service will *move* you



## Plains Avenue, Maidstone

GUIDE PRICE £375,000-£400,000

Nestled within a charming 1930s architectural frame, this distinctive residence boasts timeless character and a prime location.

### Property Features

- Council Tax: D
- EPC Rating: E
- 1930's House with Bay Window
- Three Double Bedrooms
- Wide Plot
- Large Driveway
- Requires Modernisation
- Brick Built Garage
- 140ft South Facing Private Rear Garden
- Walking Distance to Mote Park

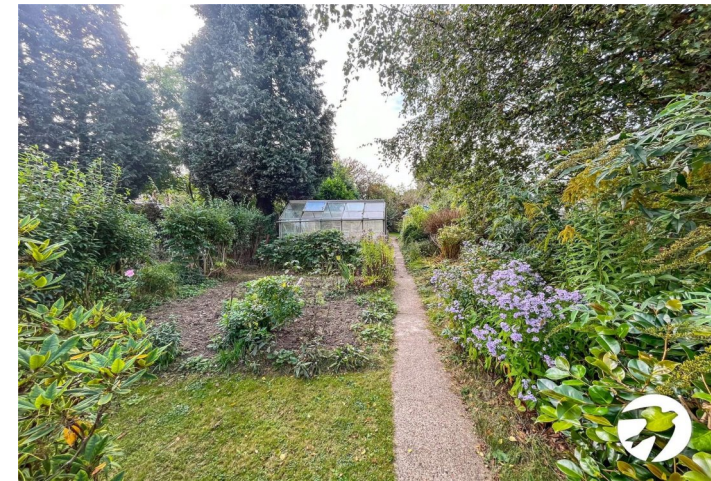



## Interior

**Porch** Window to rear, double door

**Entrance Hall** Window to front, Storage cupboard, stairs, door

**Lounge** 4m x 3.48m (13'1" x 11'5") Window to front, fireplace, door

**Dining Room** 3.8m x 3.18m (12'6" x 10'5") Two windows to rear, fireplace, open plan, door

**Kitchen** 2.62m x 2.24m (8'7" x 7'4") Window to side, door

**WC** Window to rear

**Landing** Window to side, door

**Bedroom 1** 4.04m x 3.53m (13'3" x 11'7") Window to front, fireplace, door

**Bedroom 2** 3.78m x 2.67m (12'5" x 8'9") Window to rear, fireplace

**Bedroom 3** 2.9m x 2.7m (9'6" x 8'10") Window to rear, door

**Bathroom** Window to front

### Ground Floor

Approx. 510.1 sq. feet

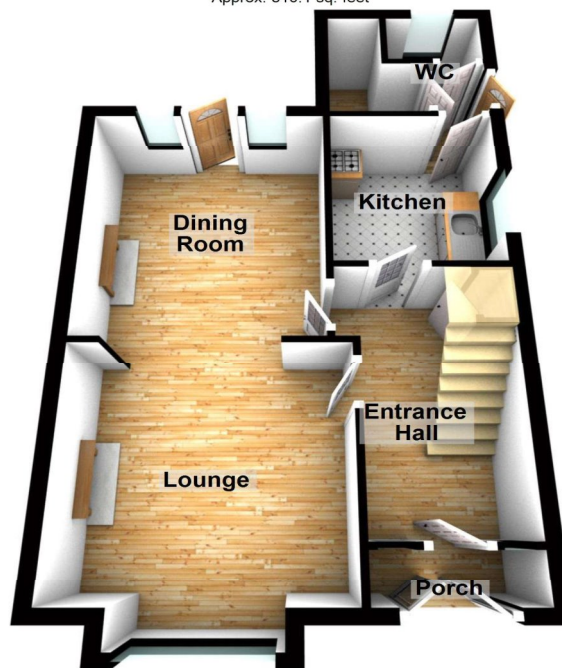

### First Floor

Approx. 445.1 sq. feet



Total area: approx. 955.2 sq. feet

Please be advised this plan is offered for marketing purposes only. It can not be relied upon for exact or precise measurements, angles, window or door openings. Whilst every effort is made to ensure the accuracy the company or provider accepts no responsibility for the content.

Plan produced using PlanUp.







## Property Location

Plains Avenue, Maidstone, Kent, ME15 7AU

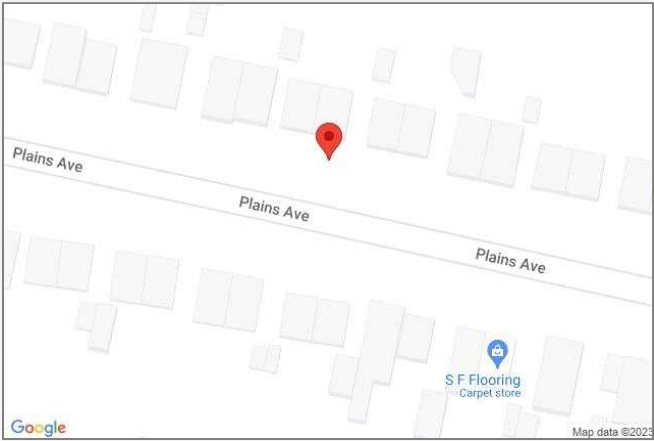

**READY TO MOVE?  
Scan to instruct us**

**FOR MORE INFORMATION  
CONTACT US TODAY.**

01622 476666  
Robinson Michael & Jackson  
15A King Street  
Maidstone,  
Kent ME14 1BA  
maidstone@robinson-jackson.com



These particulars do not form part of an offer or contract and must not be relied upon as statements or representation of fact. Any areas, measurements, journey times or distances are approximate. The text, images, photographs and plans are for guidance only and are not necessarily comprehensive. It should not be assumed that the property has all necessary planning, building regulation or other consents and we have not tested any services, equipment or facilities. References to tenure are based on information supplied by the seller. Buyer should verify all information themselves by inspection or otherwise prior to a legal commitment to purchase. Photos and images are subject to copyright.