



Hamwick Green | Lordswood, Kent, ME5 8TW



Offers in excess of £280,000 Freehold

**ROBINSON MICHAEL & JACKSON**

Our service will *move* you

## Hamwick Green, Lordswood

Robinson Michael & Jackson are excited to offer this Two double bedroom home in a popular cul-de-sac in Lordswood, Ideal for first time buyers.

### Property Features

- Council Tax: B
- EPC Rating: C
- Two double bedroom terrace
- Garage & off road parking
- Well presented throughout
- No through road position
- Ideal first time buy
- A must view!



## Interior

### Ground Floor

#### Entrance Porch

Lounge 4.22m x 3.3m (13'10" x 10'10")

Kitchen 4.3m x 2.46m (14'1" x 8'1")

### First Floor

Bedroom One 4.34m x 3.45m (14'3" x 11'4")

Bedroom Two 3.2m x 2.67m (10'6" x 8'9")

#### Bathroom

## Exterior

Garage and driveway to front

Enclosed rear garden to rear

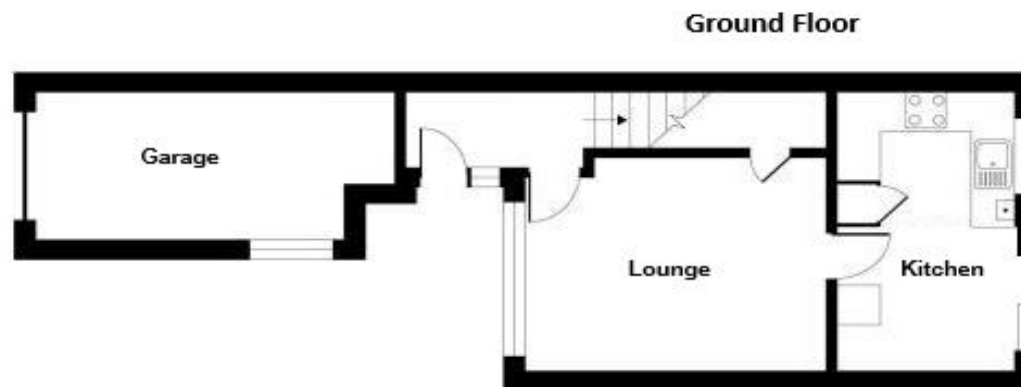



## Property Location

Hamwick Green, Lordswood, Kent, ME5 8TW



**FOR MORE INFORMATION  
CONTACT US TODAY.**

01634 868000  
Robinson Michael & Jackson  
381 Walderslade Road,  
Walderslade,  
Kent ME5 9LL  
walderslade@robinson-jackson.com

