



Bath Road | West Dartford, Kent, DA1 3DL



Guide Price £350,000 to £375,000

Freehold

ROBINSON-JACKSON
Our service will *move* you

Bath Road, West Dartford

Robinson Jackson are pleased to offer this well presented and maintained two double bedroom period home located in the sought after West Dartford and ideally situated for Grammar Schools

Property Features

- Council Tax: C
- EPC Rating: D
- Popular West Dartford Location
- Two Double Bedrooms
- First Floor Bathroom
- Approx 130' Rear Garden
- Summerhouse with Air Conditioning
- Catchment to Sought After Schools



Interior

Entrance Porch Double glazed door and window unit to front. Tiled flooring.

Entrance Hall Door to porch. Carpeted stairs to first floor. Wood effect laminate flooring.

Lounge 3.66m x 3.05m (12' x 10') Double glazed window to front. Radiator. Wood effect laminate flooring.

Dining Room 4.27m x 3.05m (14' x 10') Double glazed window to rear. Radiator. Wood effect laminate flooring. Arch to lounge. Understairs storage cupboard.

Kitchen 3.96m x 1.73m (13' x 5'8") Double glazed windows to rear and side. Frosted glazed door to side. Matching range of wall and base units with complementary work surfaces over and incorporating stainless steel sink unit. Plumbed for washing machine. Integrated dishwasher. Electric double oven. Four ring stainless steel gas hob. Stainless steel extractor fan. Radiator. Cupboard housing boiler. Tiled flooring.

Landing Access to loft. Carpet.

Bedroom One 4.27m x 3.02m (14' x 9'11") Double glazed window to front. Radiator. Carpet.

Bedroom Two 3.05m x 2.13m (10' x 7') Double glazed window to rear. Cupboard over stairs. Radiator. Carpet.

Bathroom 2.08m x 1.78m (6'10" x 5'10") Frosted double glazed window to rear. Ceiling spotlights. Tiled walls. Wash hand basin with inset vanity unit. Low level WC. Panelled bath with separate shower over. Tiled flooring. Stainless steel heated towel rail

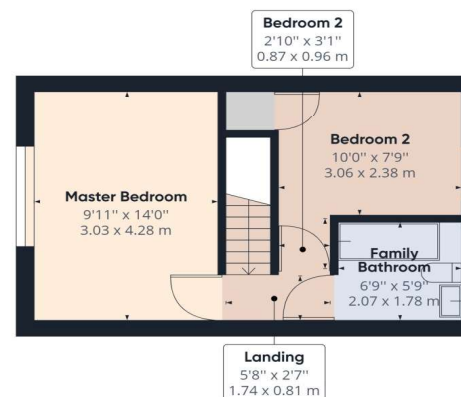



Property Location

Bath Road, West Dartford, Kent, DA1 3DL

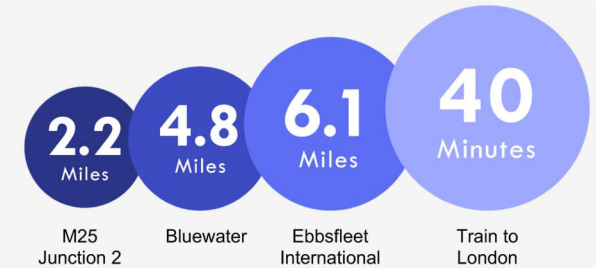
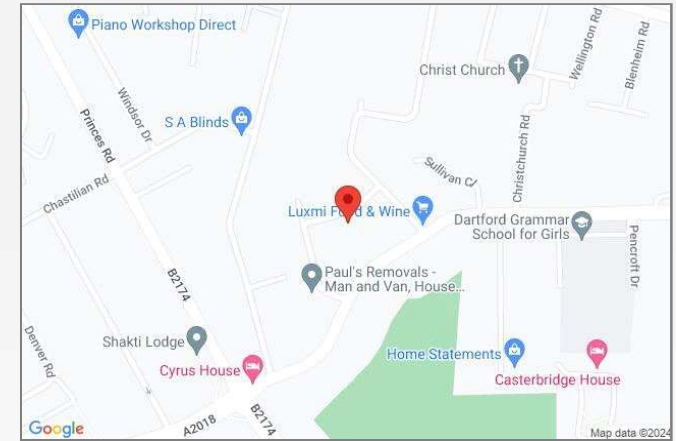

*All distances from branch postcode. Train time from nearest station.

Additional Information

The boiler is located in the Kitchen

The property measures: 65 Sqm

The garden faces South.

The seller needs to find a new property.

Exterior

Front Garden: Brick laid frontage.

Rear Garden: Approx 130'. Patio. lawn. Shed. Summerhouse

Summerhouse: All year round use. 4m x 3m. Power and lighting. Fibre broadband. Air Conditioning with Heating.

**FOR MORE INFORMATION
CONTACT US TODAY.**

01322 281281

Robinson Jackson
22 Market Street,
Dartford,
Kent DA1 1EZ

dartford@robinson-jackson.com

