



Dickens Close | Langley, Maidstone, ME17 1TB



Guide Price £375,000 - £400,000

Freehold

ROBINSON MICHAEL & JACKSON

Our service will *move* you

Dickens Close, Langley

This generously proportioned, extended semi-detached bungalow is nestled in a tranquil cul-de-sac and boasts ample living space.

Property Features

- Council Tax: D
- EPC Rating: D
- Extended
- No Chain
- Three Double Bedrooms
- Two Reception Rooms
- Two Bathrooms
- Generous Size Rear Garden
- Popular Location



Interior

Entrance Hall Leads into property

Reception Room 3.2m x 2.92m (10'6" x 9'7") Window to rear, double door, door

Lounge 4.72m x 3.35m (15'6" x 11') Window to front, fireplace, door

Conservatory Two windows to rear, two windows to side, double

Kitchen 3.4m x 3.35m (11'2" x 11') Window to rear, door, integrated appliances

Bedroom 1 3.68m x 3.2m (12'1" x 10'6") Window to front, door, double bedroom

Bedroom 2 3.43m x 3.28m (11'3" x 10'9") Window to front, door, double bedroom

Bedroom 3 3.4m x 2.6m (11'2" x 8'6") Patio door, door, double bedroom

Bathroom Window to rear, skylight, door

En-suite Window to side, walk in shower, basin & WC

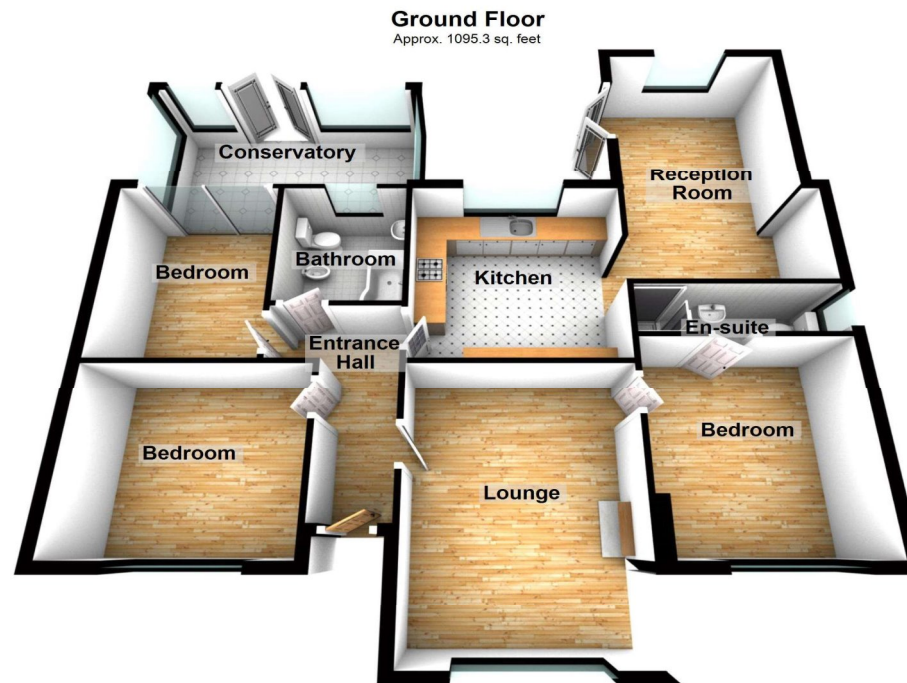

Total area: approx. 1095.3 sq. feet

Please be advised this plan is offered for marketing purposes only. It can not be relied upon for exact or precise measurements, angles, window or door openings. Whilst every effort is made to ensure the accuracy the company or provider accepts no responsibility for the content.
Plan produced using PlanUp.





Property Location

Dickens Close, Langley, Maidstone, ME17 1TB

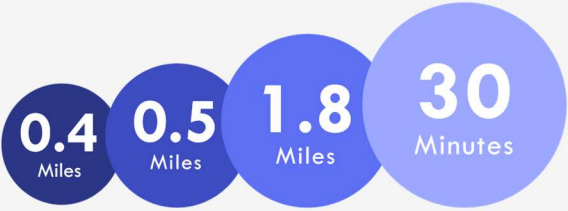
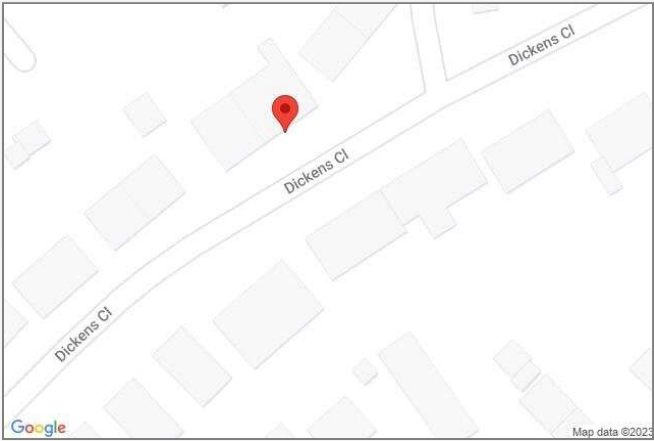

Maidstone East Train Station Maidstone West Train Station M20 Junction 7 Bluewater

*All distances from branch postcode. Train time from nearest station.

**FOR MORE INFORMATION
CONTACT US TODAY.**

01622 476666
Robinson Michael & Jackson
15A King Street
Maidstone,
Kent ME14 1BA
maidstone@robinson-jackson.com



These particulars do not form part of an offer or contract and must not be relied upon as statements or representation of fact. Any areas, measurements, journey times or distances are approximate. The text, images, photographs and plans are for guidance only and are not necessarily comprehensive. It should not be assumed that the property has all necessary planning, building regulation or other consents and we have not tested any services, equipment or facilities. References to tenure are based on information supplied by the seller. Buyer should verify all information themselves by inspection or otherwise prior to a legal commitment to purchase. Photos and images are subject to copyright.