



Riverview Road | Greenhithe, Kent, DA9 9NJ



Guide Price: £375,000-£400,000

Freehold

ROBINSON-JACKSON
Our service will *move* you

Riverview Road, Greenhithe

Robinson Jackson is thrilled to introduce this three-bedroom semi-detached home. Perfectly located within walking distance of Greenhithe station and the renowned Bluewater shopping centre, this property offers a blend of convenience and contemporary features.

Notable features of this light and airy property include two reception rooms, incorporating a kitchen diner, a generously sized master bedroom, two further bedrooms & an upstairs bathroom. A garage en-bloc and resident parking bays offer convenient parking solutions.

With easy access to the A2, M25, and local amenities, this home promises a well-connected lifestyle.

Property Features

- Council Tax: C
- EPC Rating: D
- Three Bedroom Semi-Detached
- Two Reception Rooms
- Private Secure Garden
- Garage En-Block to Rear



Interior

Entrance Hall Laminate flooring. Stairs to first floor.

Living Room 4.88m x 3.89m (16' x 12'9") Double glazed window to front. Laminate flooring. Radiator. Feature fireplace with gas fire.

Dining Room 2.97m x 2.46m (9'9" x 8'1") Double glazed windows to rear & side. Laminate flooring. Radiator. Open to:

Kitchen 3.18m x 2.29m (10'5" x 7'6") Double glazed window to rear. Double glazed door to garden. Laminate flooring. Part tiled walls. Range of wall & base units incorporating a stainless steel sink with complementary work surfaces. Electric cooker. Plumbed for washing machine. Space for dishwasher & fridge freezer. Storage cupboard with space for tumble dryer.

Landing Carpet. Loft access.

Master Bedroom 3.6m x 2.77m (11'10" x 9'1") Double glazed window to front. Carpet. Radiator. Built in wardrobe.

Bedroom Two 2.95m x 2.8m (9'8" x 9'2") Double glazed window to rear. Carpet. Radiator. Storage cupboard.

Bedroom Three 2.67m x 1.96m (8'9" x 6'5") Double glazed window to front. Laminate flooring. Radiator.

Bathroom 1.96m x 1.85m (6'5" x 6'1") Frosted double glazed window to rear. Vinyl flooring. Tiled walls. Low level WC. Pedestal wash hand basin. Panelled bath with shower screen & electric shower. Heated towel rail.

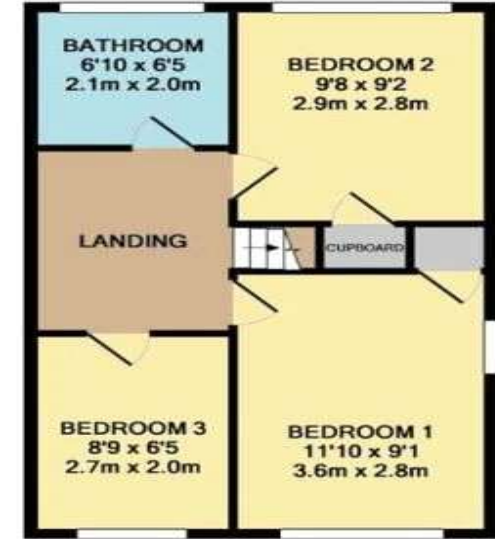
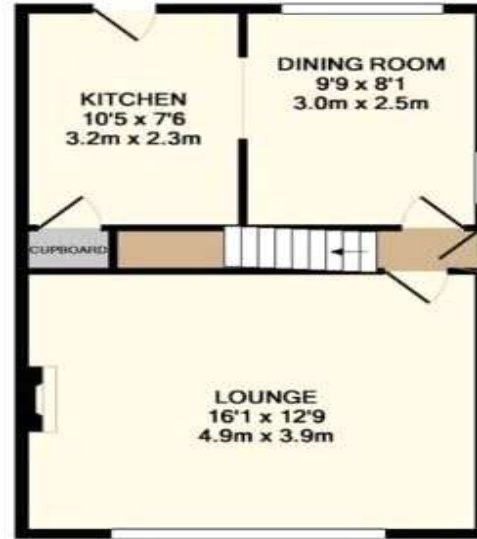



Exterior

Rear Garden: Approximately 35'. Mainly laid to lawn. Paved patio. Brick borders. Established shrubs. Timber shed. Side gate access.

Garage en bloc.

Residents parking.

Additional Information

Dartford Borough Council - Tax Band C

Total floor area: 74 sq. metres

Property Location

Riverview Road, Greenhithe, Kent, DA9 9NJ



FOR MORE INFORMATION
CONTACT US TODAY.

01322 941333

Robinson Jackson
67 Cherry Orchard,
Castle Hill,
Ebbsfleet Garden City,
DA10 1AD

ebbsfleetgardencity@robinson-jackson.com

