



Shenley Road | Dartford, Kent, DA1 1YE



Guide Price £475,000 to £500,000  
Freehold

**ROBINSON-JACKSON**  
Our service will *move* you

## Shenley Road, Dartford

Deceptively spacious. Robinson Jackson are delighted to market this four bedroom detached bungalow with a large West facing garden. The property is ideally located for local schools and town centre.

### Property Features

- Council Tax: D
- EPC Rating: D
- 0.8 Miles walk to Dartford Town Centre And Station
- Three Reception Areas
- Four Bedrooms
- Bathroom And Additional Shower Room
- Garage With Electric Charging Point
- 80ft West Facing Garden
- Viewing Comes Highly Recommended



## Interior

**Porch:** Tiled floor.

**Entrance Hall:** Karndean floor, feature lighting, sun tunnel from Velux window, radiator, hatch to boarded loft

**Lounge:** Carpet, triple glazed window to front, electric fire, feature lighting, radiator

**Dining Room:** Laminate floor, triple glazed window to side, double doors to conservatory, designer radiator, open to kitchen

**Kitchen:** Laminate floor, triple glazed window to rear, door to garden, full range of modern wall and base units, integrated oven and hob, extractor, integrated dishwasher and washing machine, spotlights, open to dining room

**Conservatory:** Karndean floor, triple glazed throughout, doors to garden, solid ceiling, feature lighting

**Bedroom One:** Carpet, two triple glazed windows to side, radiator

**Bedroom Two:** Carpet, triple glazed window to side, radiator

**Bedroom Three:** Carpet, triple glazed window to side, radiator

**Bedroom Four:** Karndean floor, triple glazed window to side, radiator

**Family Bathroom:** Tiled floor, low level wc, inset wash hand basin, panelled bath with shower over and glass screen, heated towel rail, spotlights.

**Shower Room:** Tiled floor, triple glazed window to side, Low level w/c, inset wash hand basin, shower, heated towel rail, spotlights.

## Shenley Road DA1 1YE

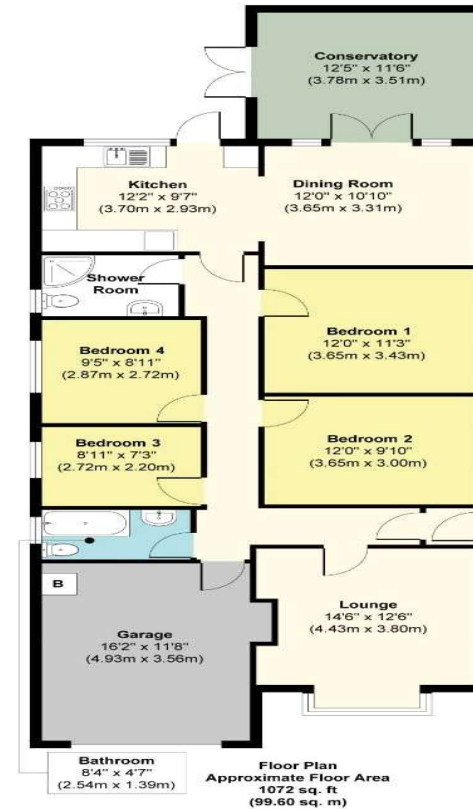

**Approx. Gross Internal Floor Area 1072 sq. ft / 99.60 sq. m**

Illustration for identification purposes only. measurements are approximate, not to scale.





## Property Location

Shenley Road, Dartford, Kent, DA1 1YE

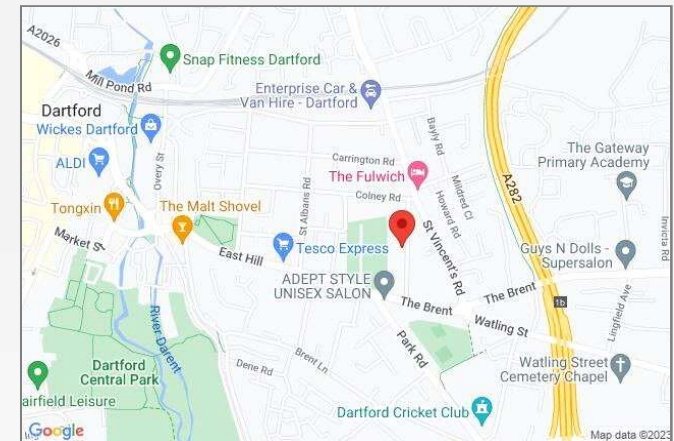

## Exterior

**Front Garden:** Access to garage, Small front garden. Pathway leading to the front door. Side pedestrian access. Gas meter.

**Rear Garden:** Approximately 80ft. West facing. Large secluded mature garden, mainly laid to lawn with patio 2 patio seating areas, power points throughout garden large shed to rear, side access

**Garage:** Connected to Hallway for direct access, power and lighting, electric car charging point

## Additional Information

The property measures 107 square metres.

The garden faces West.

The front door faces North.

The owner has found a property to move to.

Please note the property backs onto a graveyard.

**FOR MORE INFORMATION  
CONTACT US TODAY.**

01322 281281

Robinson Jackson  
22 Market Street,  
Dartford,  
Kent DA1 1EZ

dartford@robinson-jackson.com

