



Jutland Road | London, SE6 2DQ



Asking Price: £600,000

Freehold

ROBINSON-JACKSON
Our service will *move* you

Jutland Road, London

A spacious Victorian three bedroom detached house for sale consisting of an open lounge, spacious kitchen diner with larder, upstairs bathroom and three good size bedrooms. The property also has a double driveway and private garden with side access.

Property Features

- Council Tax: E
- EPC Rating: E
- Detached Three Bedroom
- Open Plan Through Lounge
- Victorian Property
- Kitchen Diner
- Three Spacious Bedrooms
- 0.5 Miles to Station



Interior

Hall Understair storage, radiator, wood flooring.

Through Lounge 6.43m into bay 3.38m (21'1" into bay x 11'1") Double glazed bay window to front, double glazed window to rear, coved ceiling, radiators, feature fireplace, wood flooring.

Kitchen 6.68m x 3.07m (21'11" x 10'1") Double glazed doors to rear, double glazed window to side, range of wall and base units, fitted oven, gas hob and extractor fan, stainless steel sink with mixer tap, integrated washing machine, fridge/freezer, microwave, larder storage cupboard, radiator, tiled flooring.

Landing Single glazed window to side, hatch providing access to loft, coved ceiling.

Bedroom 1 4.78m x 3.5m (15'8" x 11'6") Double glazed windows to front, radiator, wood flooring.

Bedroom 2 3.66m x 3.07m (12' x 10'1") Double glazed window to rear, radiator, laminate flooring.

Bedroom 3 3.48m x 2.95m (11'5" x 9'8") Double glazed window to rear, radiator, laminate flooring.

Bathroom Double glazed window to side, panel enclosed bath with mixer tap and shower attachment, low level w.c., pedestal wash hand basin with mixer tap, radiator, tiled flooring.

Exterior

Garden Crazy paving, panel wooden fencing.

Total floor area: 114m²= 1227ft² (guidance only)

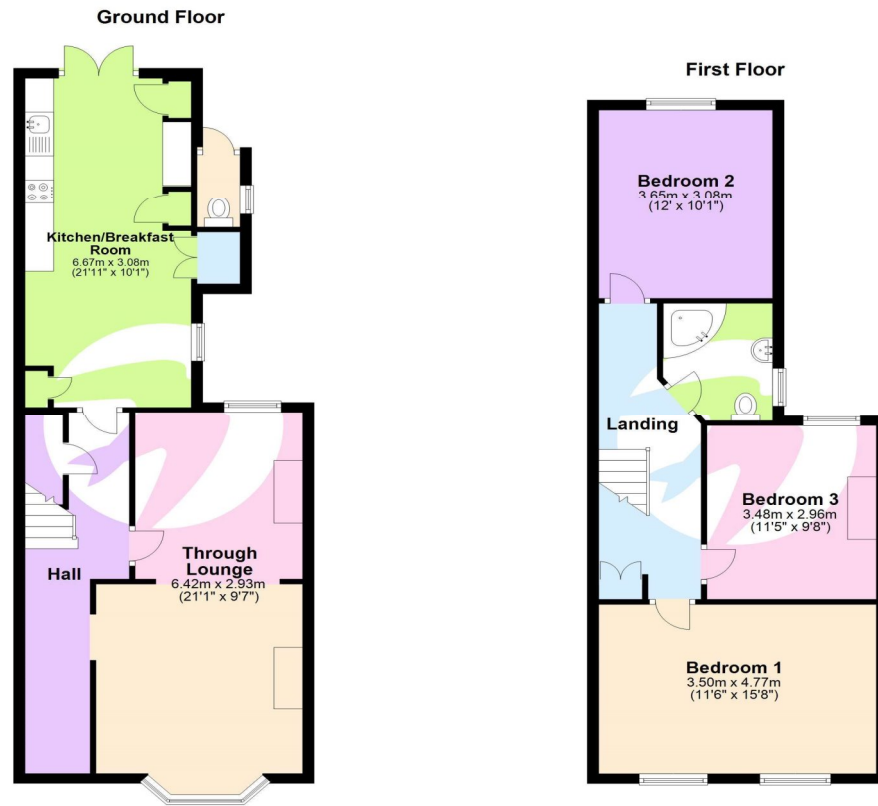

This floor plan is for illustrative purposes only. It is not drawn to scale. Measurements are approximate.
Plan produced using PlanUp.





Property Location

Jutland Road, London, SE6 2DQ



Location

Catford is growing in popularity among commuters as journeys from its two mainline stations can take as little as 10 minutes to Central London.

The Broadway Theatre is an impressive Art Deco building, with a regular programme of shows and events. Catford's other premium attraction is Mountsfield Park – one of London's best open spaces and home of the annual People's Day. Catford's Black Cat sculpture remains a well-loved landmark.

Additional Information

Local Authority: London Borough of Lewisham

Council Tax: Band E (£2,354 pa)

**FOR MORE INFORMATION
CONTACT US TODAY.**

020 8698 1234

Robinson Jackson
87 Rushey Green,
Catford
SE6 4AF

jamie.nicol@robinson-jackson.com



These particulars do not form part of an offer or contract and must not be relied upon as statements or representation of fact. Any areas, measurements, journey times or distances are approximate. The text, images, photographs and plans are for guidance only and are not necessarily comprehensive. It should not be assumed that the property has all necessary planning, building regulation or other consents and we have not tested any services, equipment or facilities. References to tenure are based on information supplied by the seller. Buyer should verify all information themselves by inspection or otherwise prior to a legal commitment to purchase. Photos and images are subject to copyright.