



Hawthorn Road | Bexleyheath, DA6 7AF



£350,000

Share of Freehold

ROBINSON-JACKSON
Our service will *move* you

Hawthorn Road, Bexleyheath

LOCATION LOCATION! Two double bedroom ground floor maisonette, in excellent condition with its own private garden and parking at the rear. Near Bexleyheath Broadway and local links. CALL TODAY!

Property Features

- Council Tax:
- EPC Rating: To be confirmed.
- Central Heating
- Double Glazed
- lounge
- Modern fitted kitchen with appliances
- Close to Bexleyheath Broadway
- Parking to rear
- Own Rear Decked Garden



Interior

Entrance Hall 6.25m x 1.2m (20'6" x 3'11")

Reception Room 3.7m x 3.66m (12'2" x 12')

Kitchen 3.9m x 1.93m (12'10" x 6'4")

Bathroom 3.15m x 1.47m (10'4" x 4'10")

Bedroom One 4.57m x 3.07m (15' x 10'1")

Bedroom Two 3.18m x 2.54m (10'5" x 8'4")

Garden Decked Area

Exterior

Share of Freehold Information

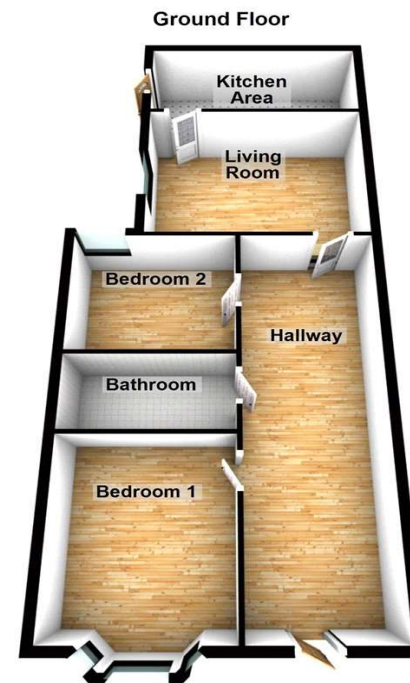

Please note that this is for illustration purposes only and should not be used as an exact representation of the property. All measurements are approximate.
Plan produced using PlanUp.





Property Location

Hawthorn Road, Bexleyheath, DA6 7AF



Additional Information

Bexleyheath is home to the borough's largest shopping facility, where you'll find high-street names, and supermarkets. There's a bowling alley, a cinema, Crook Log Leisure Centre, regular specialist markets and family-friendly restaurants too.

Families are also attracted to Bexleyheath for the schooling – with two of the borough's grammars and excellent primaries close by. The Red

House – an Arts & Crafts property designed for the artist and socialist William Morris - is Bexleyheath's premier cultural attraction.

FOR MORE INFORMATION CONTACT US TODAY.

020 8298 7000

Robinson Jackson
124 Broadway,
Bexleyheath,
Kent DA6 7DQ

bexleyheath@robinson-jackson.com

