



Kingfisher Drive | Walderslade, Kent, ME5 7NY

 3  1  1 Offers in excess of £290,000 Freehold

ROBINSON MICHAEL & JACKSON
Our service will *move* you

Kingfisher Drive, Walderslade

Set back from the road, this extended three-bedroom terrace is an ideal family home offering a blend of modern comfort and spacious accommodation.

Property Features

- Council Tax: C
- EPC Rating: C
- Three bedroom family home
- Extended to rear
- Residents parking
- Popular location
- Impressive kitchen/diner
- Well-presented throughout



Interior

Ground Floor

Entrance Hall

Lounge 4.42m x 3.45m (14'6" x 11'4")

Kitchen/Diner 6.96m x 5m (22'10" x 16'5")

First Floor

Bedroom One 3.4m x 2.7m (11'2" x 8'10")

Bedroom Two 3m x 2.64m (9'10" x 8'8")

Bedroom Three 2.62m x 2.54m (8'7" x 8'4")

Bathroom 2.54m x 1.65m (8'4" x 5'5")

Exterior

Front and rear gardens

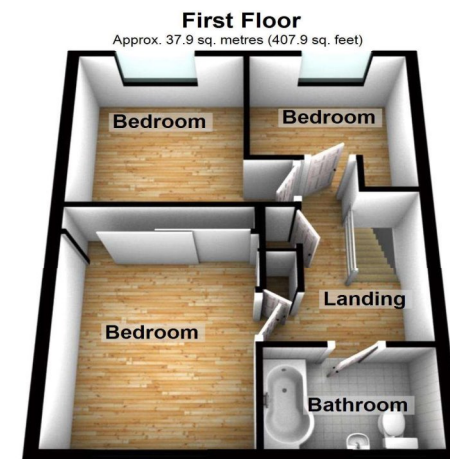
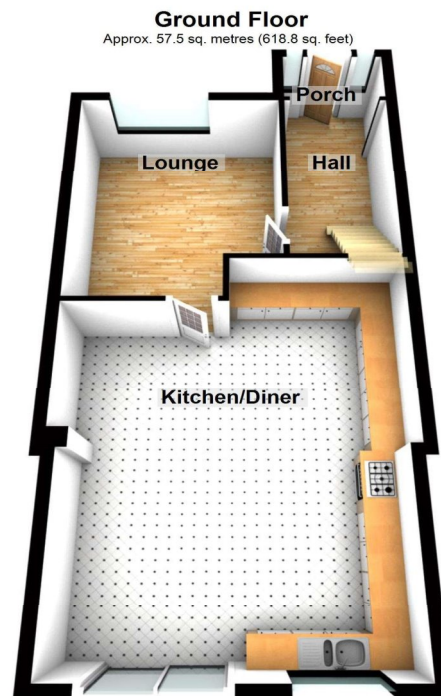

Total area: approx. 95.4 sq. metres (1026.7 sq. feet)

Please be advised this plan is offered for marketing purposes only. It can not be relied upon for exact or precise measurements, angles, window or door openings. Whilst every effort is made to ensure the accuracy the company or provider accepts no responsibility for the content.
Plan produced using PlanUp.





Property Location

Kingfisher Drive, Walderslade, Kent, ME5 7NY

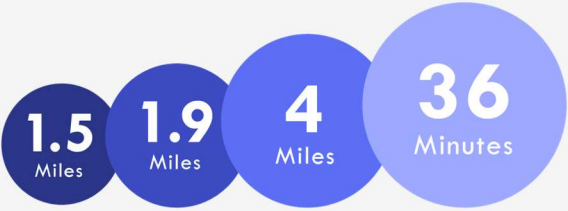
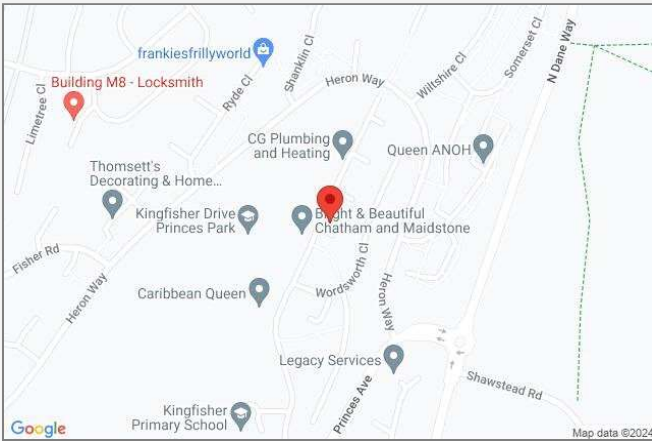

*All distances from branch postcode. Train time from nearest station.

FOR MORE INFORMATION CONTACT US TODAY.

01634 868000
Robinson Michael & Jackson
381 Walderslade Road,
Walderslade,
Kent ME5 9LL
walderslade@robinson-jackson.com



These particulars do not form part of an offer or contract and must not be relied upon as statements or representation of fact. Any areas, measurements, journey times or distances are approximate. The text, images, photographs and plans are for guidance only and are not necessarily comprehensive. It should not be assumed that the property has all necessary planning, building regulation or other consents and we have not tested any services, equipment or facilities. References to tenure are based on information supplied by the seller. Buyer should verify all information themselves by inspection or otherwise prior to a legal commitment to purchase. Photos and images are subject to copyright.