



Mead Green | Lordswood, Kent, ME5 8PB



Asking Price £300,000 Freehold

ROBINSON MICHAEL & JACKSON
Our service will *move* you

Mead Green, Lordswood

A well presented semi detached bungalow in a sought after part of Lordswood. Offered to the market with no onward chain.

Property Features

- Council Tax: C
- EPC Rating: D
- No chain
- 2 bedroom semi detached bungalow
- Conservatory
- Quiet Cul de sac
- Front and rear gardens
- Garage to rear



Interior

Lounge: 4.75m x 3.48m (15'7" x 11'5")

Conservatory: 3.86m x 2.64m (12'8" x 8'8")

Kitchen: 3.78m x 4.04m (12'5" x 13'3")

Bedroom 1: 3.48m x 3.18m (11'5" x 10'5")

Bedroom 2: 3.56m x 2.34m (11'8" x 7'8")

Bathroom: 2.62m x 2.46m (8'7" x 8'1")

Exterior

Front lawn garden

Rear paved garden

Side access

Access to rear garage

Ground Floor

Approx. 851.4 sq. feet

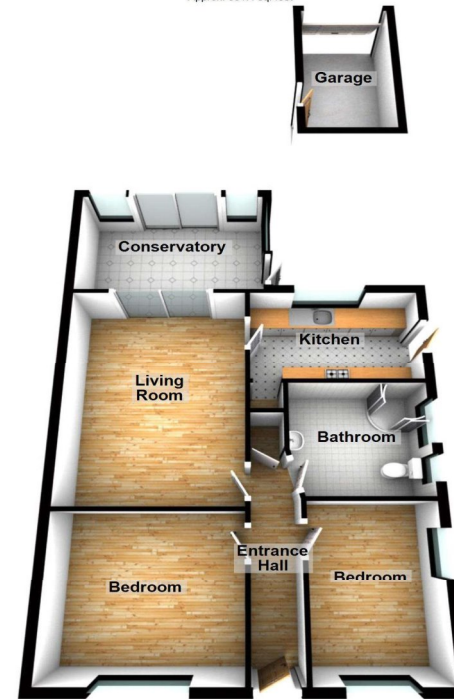

Total area: approx. 851.4 sq. feet

Please be advised this plan is offered for marketing purposes only. It can not be relied upon for exact or precise measurements, angles, window or door openings. Whilst every effort is made to ensure the accuracy the company or provider accepts no responsibility for the content.
Plan produced using PlanUp.





Property Location

Mead Green, Lordwood, Kent, ME5 8PB

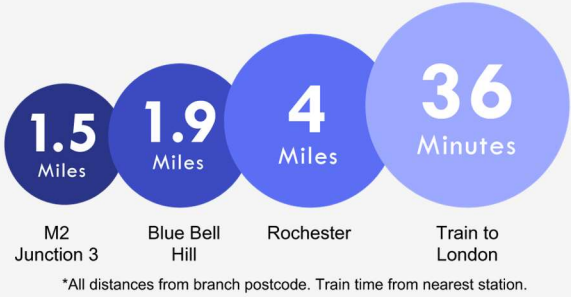

FOR MORE INFORMATION
CONTACT US TODAY.

01634 868000
Robinson Michael & Jackson
381 Walderslade Road,
Walderslade,
Kent ME5 9LL
walderslade@robinson-jackson.com



These particulars do not form part of an offer or contract and must not be relied upon as statements or representation of fact. Any areas, measurements, journey times or distances are approximate. The text, images, photographs and plans are for guidance only and are not necessarily comprehensive. It should not be assumed that the property has all necessary planning, building regulation or other consents and we have not tested any services, equipment or facilities. References to tenure are based on information supplied by the seller. Buyer should verify all information themselves by inspection or otherwise prior to a legal commitment to purchase. Photos and images are subject to copyright.