



Heron Way | Walderslade, Kent, ME5 7RL



Asking Price £250,000 Freehold

ROBINSON MICHAEL & JACKSON

Our service will *move* you

Heron Way, Walderslade

Ideal first time purchase!

A well presented two bedroom house with allocated parking and summer house. Must be viewed to fully appreciate all it offers.

Property Features

- Ideal first time buy
- Front and rear gardens
- Modern decor throughout
- Allocated parking bay
- Two double bedrooms
- A Must view



Interior

Ground Floor

Entrance Hall

Kitchen 2.8m x 1.5m (9'2" x 4'11")

Living Room 3.73m x 3.53m (12'3" x 11'7")

First Floor

Bedroom 1 3.53m x 2.51m (11'7" x 8'3")

Bedroom 2 2.54m x 2.2m (8'4" x 7'3")

Bathroom 1.8m x 1.68m (5'11" x 5'6")

Summer House

Exterior

Front and rear Gardens

Patio rear garden

Summer house with power

Secure fencing

Allocated parking

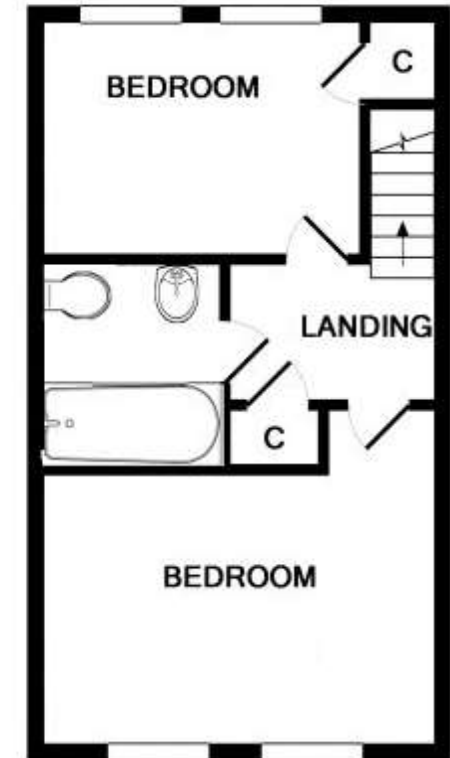
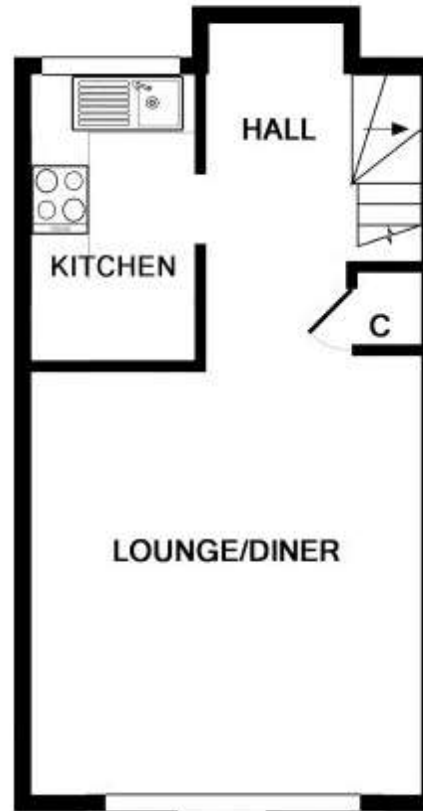



Property Location

Heron Way, Walderslade, Kent, ME5 7RL

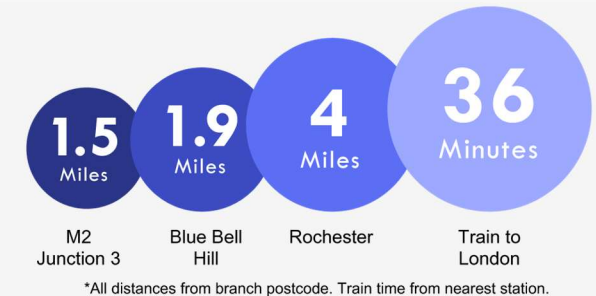
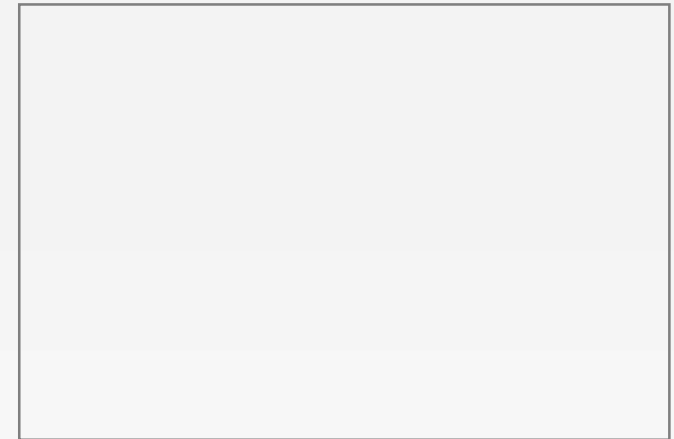

**FOR MORE INFORMATION
CONTACT US TODAY.**

01634 868000
Robinson Michael & Jackson
381 Walderslade Road,
Walderslade,
Kent ME5 9LL
walderslade@robinson-jackson.com



These particulars do not form part of an offer or contract and must not be relied upon as statements or representation of fact. Any areas, measurements, journey times or distances are approximate. The text, images, photographs and plans are for guidance only and are not necessarily comprehensive. It should not be assumed that the property has all necessary planning, building regulation or other consents and we have not tested any services, equipment or facilities. References to tenure are based on information supplied by the seller. Buyer should verify all information themselves by inspection or otherwise prior to a legal commitment to purchase. Photos and images are subject to copyright.